

HICKORY HILL COLONY NO. 3
 PERMANENT PARCEL Nos. 15, 16, 17
 RECORDED 4-29-69 VOL. P PAGE 80

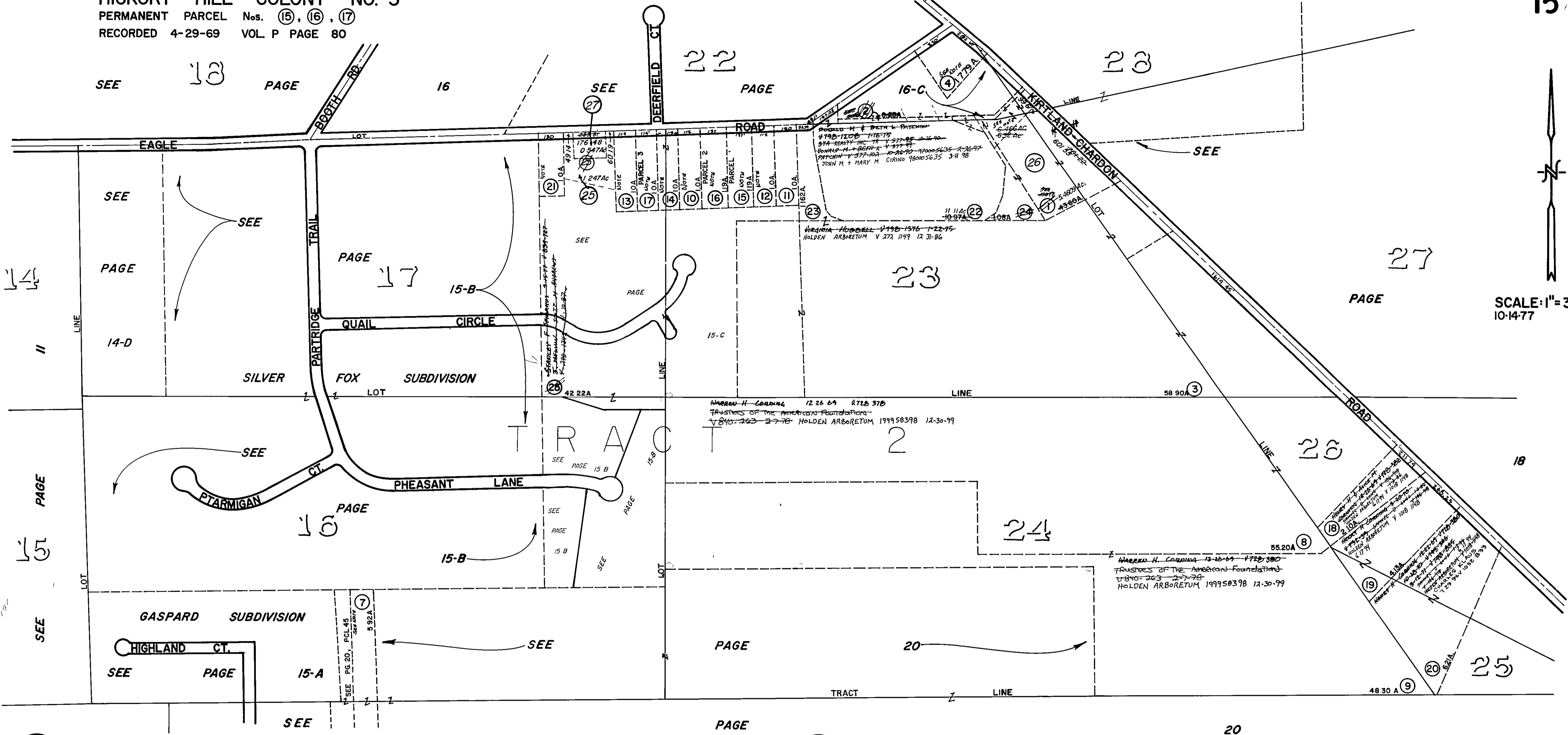

Parcel No	OWNERSHIP	NOTES
1	BENJAMIN S. HUBBELL SR V 778-1300-12-25	HUBBELL V & MARY S BUSCHMAN V ET 106 12-26-90
2	THE CLEVELAND TRUST CO (INC) 3-28-1987	STA REALTY INC 1-31-91
4	GRACE M. MARCELL V 711 62B 10-29-72	DELETED
7	HENRIETTA WENBELL, METAL 15, 6-27-74	ALBERT J. JR & JENNIE L. ALBERT 12-27-77
10	THE CLEVELAND TRUST CO (INC) 3-27-1987	FERDINAND + MARIANNE K. MERK 6-13-88
11	THE CLEVELAND TRUST CO (INC) 3-27-1987	HOLDEN ARBORETUM V 655-440 10-7-91
12	RONALD M + HELEN MOORE V 391-375 7-24-64	RONALD G. ACHITTANO V 896-1345 11-11-77
13	JOHN + HELEN GREIDER V 600-78 10-26-64	J. REX HARRISON ETAL(4) V 955-652 12-30-93
14	WILBUR O + ANNA F. MOYER 10-10-62	CHERYL A + JOSEPH W JR COLEMAN 9-29-87
15	LEON M + HELEN MOORE 8-25-69	KRISTAL M + EDMIRA B 11-7-77
16	RONALD J + BARBARA DOCCA 5-14-73	V 835-1355 SHIPCKA 9-00-94
17	JOHN MANCINI 10-1-76	200001461 11-2-00
21	RONALD L + SANDRA R LA MACCHIA 10-7-79	09004694

Parcel No	OWNERSHIP	NOTES
25	J. MELVIN B. SCOTT M. ANDREWS 4-19-87	MARGY E. BERBER 7-24-92
26	ROBERT H + PATRICIA L GOODMAN 11-23-90	J. MELVIN B. SCOTT ANDREWS 7-24-92
27	CITY OF KIRTLAND 7-24-92	