

RECORD OF SURVEYS,

Plat of *Survey*, No. *47*, *Painesville* Town *11*, Range *8*

Survey made *September 30th* 1895, at the request of *the County Commissioners*
 For the purpose of *extending a county Road as shown by annexed Plat*

-by *Frank M. Parker* County Surveyor.

Surveyors report to County Commissioners **DESCRIPTION.**

In obedience to the foregoing order, I proceeded on the days referred to and mentioned in the foregoing report of viewers to survey and mark a County Road in Painesville the leading from what is known as Madison Avenue to what is called Carement Avenue. Beginning at a stone set at the center of said county road, and on the south line of land owned by Albra & Cronis, thence N 3° E (10 04) Ten Chains and four links to a stone set on the east line of Carement Ave-

CALCULATIONS.

Sta.	Course.	Distance.	Latitude.		Departure.		Double Longitude.	Double Areas.		REMARKS.
			North.	South.	East.	West.		North.	South.	

I, *Frank M. Parker* County Surveyor of *Lake County, Ohio*, do hereby certify, that I have surveyed and subdivided *Lot. No. 10*
 in *Tract No. 2* Township of _____ in accordance with the statutes of *Ohio*, and the laws of the *United States*.
 Surveyed pursuant to the application of *County Commissioners* and _____, *Sept 30th* *A. D. 1895*
Frank M. Parker County Surveyor.

{ *Stephen Stage* } *Flagmen.*
 { _____ } *Markers.*

L. A. Moody
E. E. Gould } *Tapemen.*

LAKE COUNTY, OHIO.

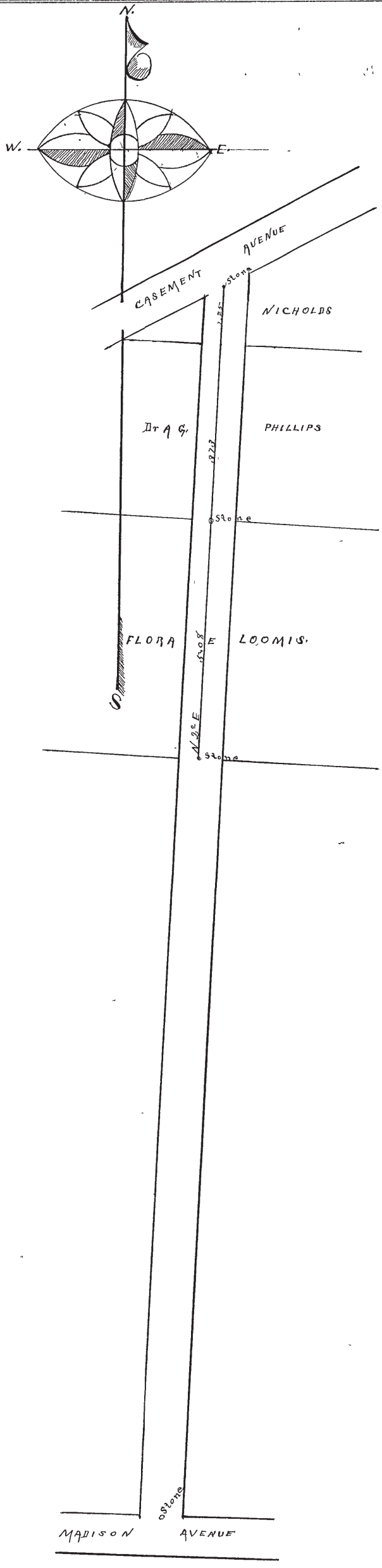

Continuation
of
County Road.
Painesville
Township.
Tract 2, Lot 10.