

SR 91 N 03°07'37" E
 CURVE "AA"
 $\Delta = 18^\circ 46' 41"$
 $R = 100.00'$
 $T = 16.54'$
 $CH = 32.63'$
 $L = 32.77'$

CURVE "BB"
 $\Delta = 18^\circ 46' 41"$
 $R = 100.00'$
 $T = 16.54'$
 $CH = 32.63'$
 $L = 32.77'$

SR 91 STA. 251+67.73 = CURTIS BLVD. STA. 45+18.18
 SR 91 STA. 251+65 (SR 91)
 STA. 46+50 (CURTIS BLVD.)
 BEGIN PROJECT STA. 251+82 (SR 91)
 BWH-1A 21 (12)
 MEET EXIST. GRADE

BEGIN WORK STA. 251+65 (SR 91)
 STA. 46+50 (CURTIS BLVD.)

5 ITEM 621 - STOP LINES, SEE TABLE, SHT. #2
 4 MIN. 2' BETWEEN EDGE OF ROAD & END FENCE SUPPORT.
 3 SIGNS, SEE TYPICAL DETAIL SHT. #6, ITEM 630
 2 12' OFF OF EXISTING FENCE
 1 DROP CURB, SEE DETAIL SHT. #5

7 PROPOSED SIGN W-76B-30. SEE TABLE, SHT. #2.
 6 PROPOSED SIGNS M-7-24 & M-14A-24 SEE TABLE, SHT. #2.
 9 HEADWALL HW4B
 8 PROPOSED SIGNS M-13A-24, M-7-24 & M-15-24. SEE TABLE, SHT. #2.

BENCHMARK NO. 4
 RR SPIKE SET LP # 664602 W/S SR 91,
 2ND POLE NORTH OF CURTIS BLVD. EL. 635.16

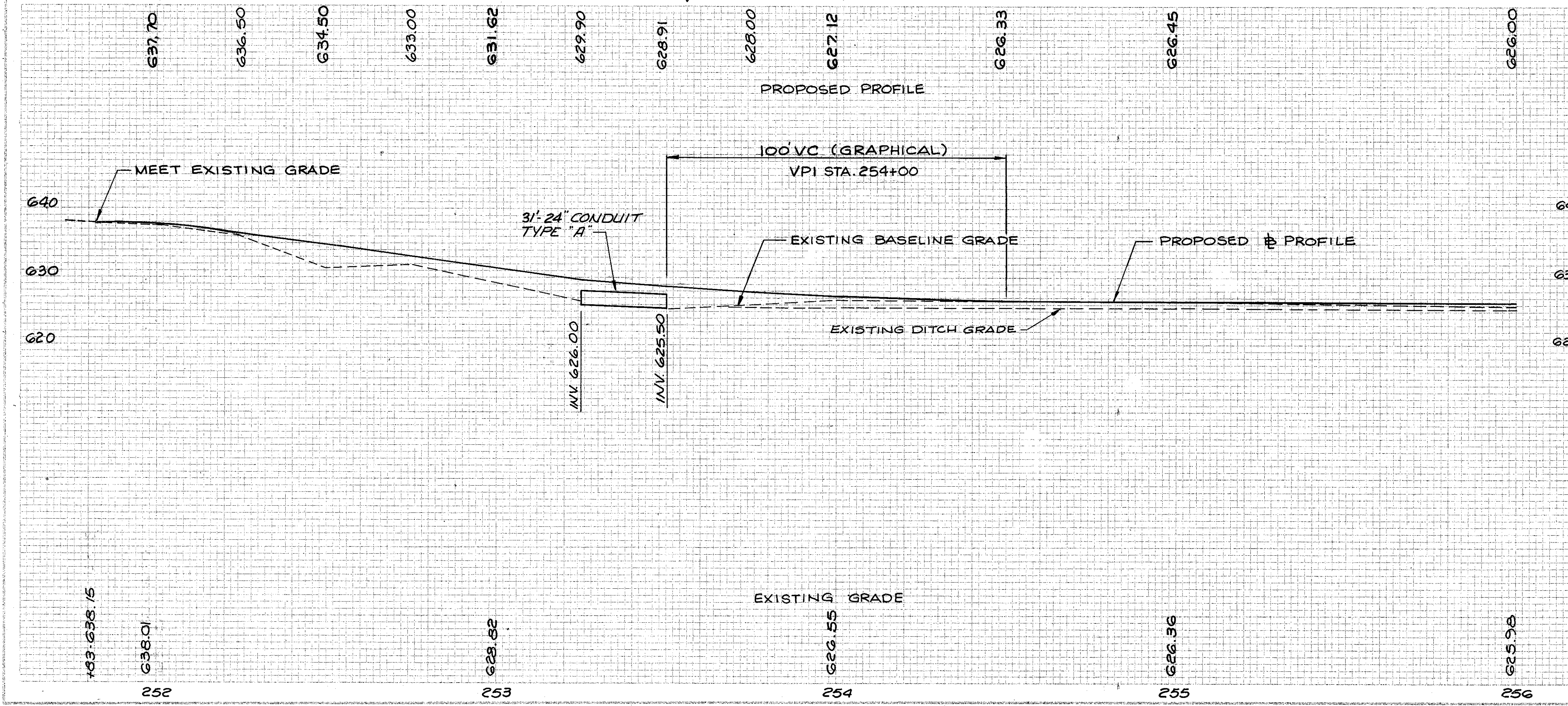

REF	LOCATION	ROADWAY			DRAINAGE		
		607	202	607	602	603	609
R-1	STA. 253+17						
R-2	STA. 251+93 TO STA. 256+00	409					
R-3	STA. 251+91 LT.			1			
R-4	STA. 251+82						16
D-1	STA. 253+17 TO STA. 253+88					31	
D-2	STA. 253+25				0.46		
D-3	STA. 253+50				0.46		
TOTALS		409	11	1	0.92	31	16

2 PAVEMENT