

MAINTENANCE OF TRAFFIC

ITEM 614 - MAINTENANCE OF TRAFFIC

THE MAINTENANCE OF TRAFFIC SHALL BE GOVERNED BY THE "OHIO MANUAL OF UNIFORM TRAFFIC CONTROL DEVICES" FOR STREETS AND HIGHWAYS, HEREINAFTER REFERRED TO AS THE MANUAL OR THE OMUTCD, AND AS SUPPLEMENTED BY PERTINENT ITEMS OF THE STATE OF OHIO DEPARTMENT OF TRANSPORTATION, CONSTRUCTION AND MATERIAL SPECIFICATIONS AND THE FOLLOWING REQUIREMENTS:

ALL SIGNS, DRUMS, BARRELS, LANE MARKINGS FOR TRAFFIC CONTROL DURING CONSTRUCTION IN ACCORDANCE WITH THESE PLANS AND SPECIFICATIONS SHALL BE IN PLACE PRIOR TO ANY CONSTRUCTION.

THE CONTRACTOR WILL BE REQUIRED TO PROVIDE, ERECT, MAINTAIN (IN PROPER POSITION, CLEAN, LEGIBLE, AND IN GOOD WORKING CONDITION) AND REMOVE ALL LIGHTS, SIGNS, SIGN SUPPORTS, BARRICADES, DRUMS, AND ALL OTHER TRAFFIC CONTROL DEVICES NECESSARY FOR THE MAINTENANCE OF TRAFFIC.

THE COST OF PROVIDING, INSTALLING, MAINTAINING AND REMOVING ALL TRAFFIC CONTROL DEVICES REQUIRED TO MAINTAIN TRAFFIC DURING CONSTRUCTION INCLUDING LIGHTS, SIGNS, SIGN SUPPORTS, DRUMS AND BARRICADES SHALL BE INCLUDED IN THE LUMP SUM PRICE FOR ITEM 614 - MAINTAINING TRAFFIC.

THE CONTRACTOR SHALL NOTIFY THE CITY OF EASTLAKE FIRE AND SERVICE DEPARTMENTS AT LEAST 72 HOURS PRIOR TO ANY LANE RESTRICTIONS, DIVERSIONS, ETC.

DURING CONSTRUCTION, INGRESS AND EGRESS SHALL BE MAINTAINED TO ALL PROPERTIES ADJACENT TO S.R. 91 (SOM CENTER ROAD).

ITEM 614 - MAINTAINING TRAFFIC

THE CONTRACTOR SHALL MAINTAIN TWO-WAY TRAFFIC WITH AT LEAST ONE LANE (11 FOOT MINIMUM WIDTH) OPEN AT EACH SIDE OF THE MEDIAN AT ALL TIMES IN ACCORDANCE WITH THE REQUIREMENTS OF SPECIFICATION 614. TWO-WAY TRAFFIC SHALL BE MAINTAINED AT ALL TIMES BY USE OF THE EXISTING PAVEMENT, THE COMPLETED PAVEMENT AND TEMPORARY ROADWAYS SURFACED WITH 410- AGGREGATE AND STABILIZED WITH ITEM 616 - CALCIUM CHLORIDE. THE LIMITS AND DURATION OF USE OF TEMPORARY ROADWAYS SHALL BE HELD TO AN ABSOLUTE MINIMUM, AND IN ALL CASES SHALL BE SUBJECT TO THE APPROVAL OF THE ENGINEER.

THE FOLLOWING ESTIMATED QUANTITIES HAVE BEEN INCLUDED IN THE GENERAL SUMMARY TO BE USED AS DIRECTED BY THE ENGINEER FOR THE MAINTENANCE OF TRAFFIC:

ITEM 404	BITUMINOUS CONCRETE FOR MAINTAINING TRAFFIC	90	CU. YD.
ITEM 410	TRAFFIC COMPACTED SURFACE TYPE A OR B	350	CU. YD.
ITEM 616	CALCIUM CHLORIDE	7	TONS
ITEM 616	WATER	7	M. GAL.

SEPARATE PAYMENT SHALL BE MADE FOR ITEMS 404, 410 AND 616 NOTED ABOVE. ALL OTHER WORK REQUIRED FOR TRAFFIC MAINTENANCE SHALL BE INCLUDED WITH PAYMENT FOR ITEM 614 - MAINTAINING TRAFFIC.

PROTECTION OF PUBLIC:

WHENEVER ANY WORK IS BEING DONE DIRECTLY OVER A TRAVELED LANE OR SHOULDER, THE CONTRACTOR SHALL SUPPLY SUFFICIENT SAFETY EQUIPMENT AS APPROVED BY THE ENGINEER TO PROTECT THE TRAVELING PUBLIC FROM ANY CONSTRUCTION DEBRIS. IF TRAVELED LANES UNDER STRUCTURES ARE TO BE CLOSED FOR REASONS OF SAFETY, METHOD AND TIME OF CLOSURE MUST BE APPROVED PRIOR TO IMPLEMENTATION. PERSONAL CARS SHALL NOT BE PARKED WITHIN THE RIGHT-OF-WAY. PAYMENT FOR THIS WORK, INCLUDING ALL MATERIALS, LABOR AND EQUIPMENT, SHALL BE INCLUDED IN ITEM 614 - MAINTAINING TRAFFIC.

INTERSECTING STREETS:

THE CONTRACTOR SHALL FURNISH AND MAINTAIN ALL NECESSARY SAFEGUARDS, AND OTHER TRAFFIC CONTROL DEVICES AS PROVIDED IN ITEM 614 - MAINTAINING TRAFFIC SO AS TO AVOID DAMAGE AND/OR INJURY TO VEHICLES AND PERSONS USING THE INTERSECTING STREETS DURING CONSTRUCTION.

ALL APPROACHING TRAFFIC ON THE INTERSECTING STREETS SHALL BE NOTIFIED OF CONSTRUCTION AHEAD BY THE INSTALLATION OF THE APPROPRIATE SIGNS (OW-128)

PAYMENT FOR LABOR, EQUIPMENT, AND MATERIALS REQUIRED FOR THE MAINTENANCE OF TRAFFIC ON INTERSECTING STREETS SHALL BE INCLUDED IN THE LUMP SUM BID FOR ITEM 614 - MAINTAINING TRAFFIC.

PAVEMENT MARKINGS REMOVAL:

EXISTING VISIBLE PAVEMENT MARKINGS IN CONFLICT WITH THE MARKINGS ON THE PLANS SHALL BE REMOVED IN COMPLIANCE WITH PARAGRAPH 621.134 OF THE ODOT CONSTRUCTION AND MATERIAL SPECIFICATIONS. PAVEMENT MARKINGS SHALL NOT BE GROUND OFF WITH A GRINDER.

BRIDGE REPAIR SCHEDULING - (LAK 91-0547):

THE CONTRACTOR SHALL SCHEDULE HIS WORK SUCH THAT ALL REPAIRS REQUIRING CLOSURE OF THE BRIDGE SHALL BE PERFORMED AND COMPLETED DURING THE PERIOD FROM JUNE 15 THROUGH AUGUST 25, WHEN LOCAL SCHOOLS ARE NOT IN SESSION. IF THE BRIDGE REPAIRS PROGRESS INTO THE SCHOOL YEAR, THE CONTRACTOR SHALL ENSURE THAT ACCESS TO THE BRIDGE AND APPROACH RAMP FOR PEDESTRIAN AND BICYCLE TRAFFIC IS MAINTAINED THROUGHOUT THE SCHOOL WEEK.

THE BRIDGE AND APPROACH WALKWAYS AT STEVENS BOULEVARD SHALL REMAIN OPEN TO PEDESTRIAN AND BICYCLE TRAFFIC WHENEVER PRACTICAL DURING THE CONSTRUCTION PERIOD. THE CONTRACTOR SHALL ENSURE THAT REPAIR OPERATIONS DO NOT AFFECT THE SAFETY OF ANY INDIVIDUALS USING THE PEDESTRIAN BRIDGE OR APPROACH WALKWAYS. WHEN IT BECOMES NECESSARY TO CLOSE THE BRIDGE TO PEDESTRIAN AND BICYCLE TRAFFIC, THE CONTRACTOR SHALL INSTALL MOVABLE TYPE III BARRICADES TO PHYSICALLY CLOSE OFF PEDESTRIAN ACCESS TO THE BRIDGE. THE CONTRACTOR SHALL POST A SIGN WITH LEGEND "PEDESTRIAN BRIDGE CLOSED, USE CROSSING GUARD" ON EACH BARRICADE TO DETOUR THE PEDESTRIAN TRAFFIC TO A TEMPORARY CROSSING OF SR 91. SIGN AND BARRICADE LOCATIONS, TYPES, AND DESCRIPTIONS ARE SHOWN ON THE BRIDGE REPAIR SCHEDULING DETAIL, THIS SHEET. THE CONTRACTOR SHALL ALSO PROVIDE TWO (2) OFF-DUTY UNIFORMED CITY OF EASTLAKE POLICE OFFICERS TO ASSIST PEDESTRIANS IN CROSSING SR 91 DURING THE TIME WHEN THE BRIDGE MUST BE CLOSED OFF. THE ENGINEER SHALL BE NOTIFIED IN ADVANCE OF ANY SUCH CLOSING. THE BRIDGE SHALL BE REOPENED TO TRAFFIC EACH EVENING BY 5:00 P.M. COSTS ASSOCIATED WITH PROVIDING SIGNS, BARRICADES, AND OFF-DUTY POLICE OFFICERS SHALL BE INCLUDED IN ITEM 614 - MAINTAINING TRAFFIC.

TEMPORARY PAVEMENT MARKINGS:

THE ROAD SHALL NOT BE OPENED TO TRAFFIC UNTIL EITHER THE PERMANENT OR TEMPORARY MARKINGS ARE IN PLACE. THE FOLLOWING TEMPORARY PAVEMENT MARKINGS SHALL BE PROVIDED AS DIRECTED BY THE ENGINEER.

ITEM	DESCRIPTION	QUANTITY
ITEM 614	TEMPORARY CENTER LINE, CLASS II	0.04 MI.
ITEM 614	TEMPORARY LANE LINE, CLASS II	4.59 MI.

THESE QUANTITIES HAVE BEEN CARRIED TO THE GENERAL SUMMARY.

ITEM 614	WORK ZONE MARKING SIGN	18 EACH
----------	------------------------	---------

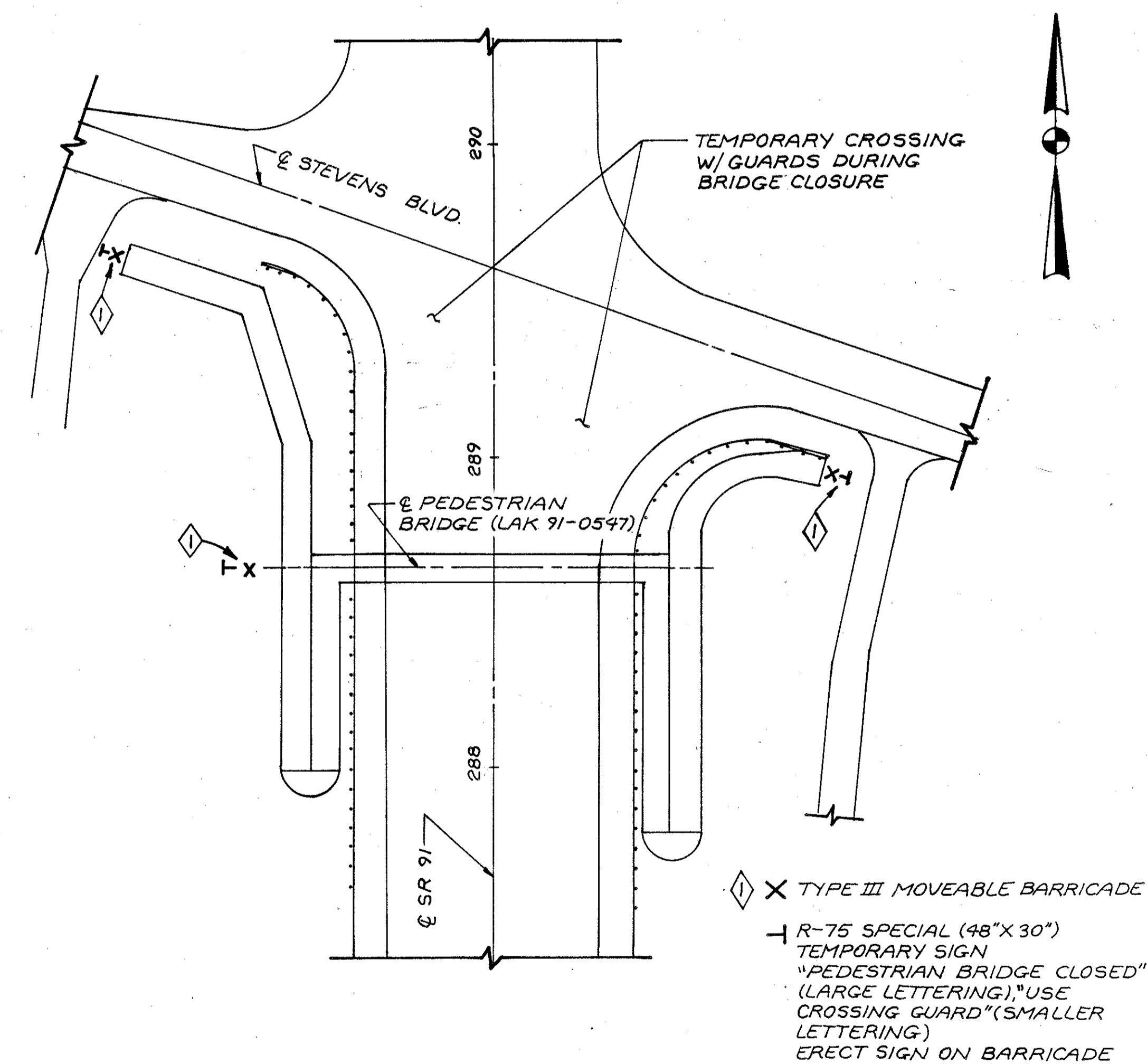

BRIDGE REPAIR SCHEDULING DETAIL