

FED. RD. DIST. NO.	STATE	FED. AID PROJECT	FISCAL YEAR
	OHIO		

Δ = 4°-18'  
T = 107.02'  
R = 2850.66'  
L = 213.93'  
D = 2°-01'

5  
32

I. G. H. No. 466 SEC. D  
LAKE COUNTY

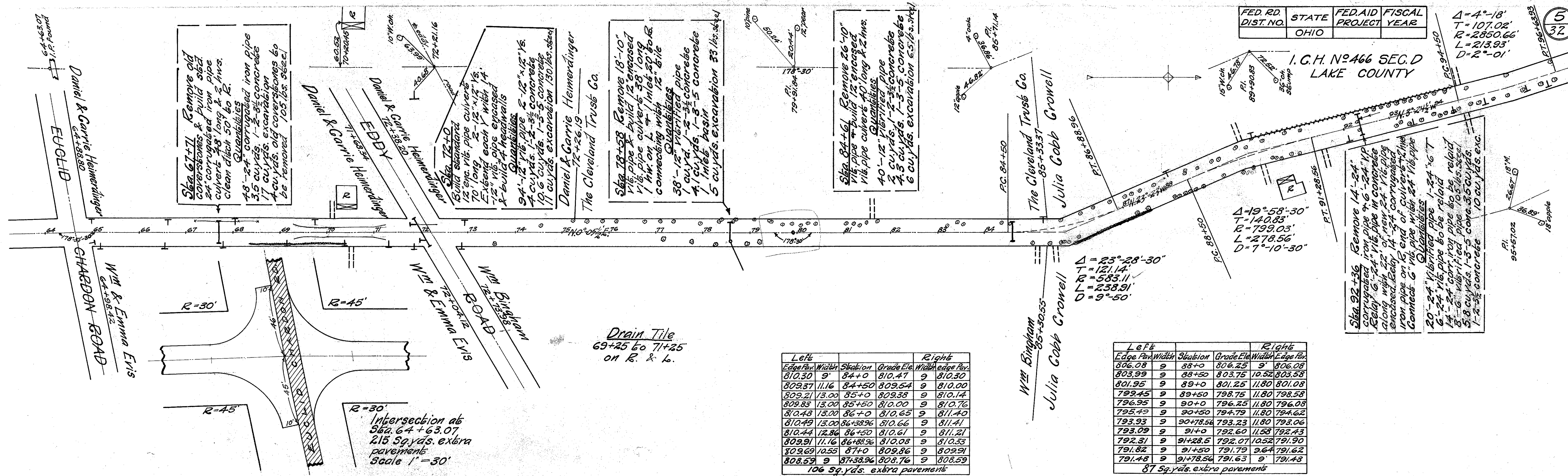

Drain Tile  
69+25 to 71+25  
on R. & L.

Left Edge Pav. Width	Station	Grade Ele.	Right Edge Pav. Width
810.30	84+00	810.47	810.30
809.37	84+50	809.54	810.00
809.21	85+00	809.38	810.14
809.83	85+50	810.00	810.76
810.48	86+00	810.65	811.40
810.49	86+38.96	810.66	811.41
810.44	86+50	810.61	811.21
809.91	86+88.96	810.08	810.53
809.69	87+00	809.86	809.91
808.59	87+38.96	808.76	808.59

106 Sq. yds. extra pavement

Left Edge Pav. Width	Station	Grade Ele.	Right Edge Pav. Width
806.08	88+00	806.25	806.08
803.99	88+50	803.75	803.58
801.95	89+00	801.25	801.08
799.45	89+50	798.75	798.58
796.95	90+00	796.25	796.08
795.49	90+50	794.79	794.62
793.93	90+78.54	793.23	793.06
793.09	91+00	792.60	792.43
792.31	91+28.5	792.07	791.90
791.82	91+50	791.79	791.62
791.48	91+78.54	791.63	791.48

87 Sq. yds. extra pavement

B.M. #15 Sba. 67+72 + on S.W. cor. headwall 13' 60 L of $\Phi$ Elev. = 838.76	B.M. #16 Sba. 70+98 Spike in side of 10" pear 60 L of $\Phi$ Elev. = 852.41	B.M. #17 Sba. 73+60 Spike in side of maple 23' 60 L of $\Phi$ Elev. = 838.30	B.M. #18 Sba. 78+35 Spike on back of 36" elm 24' 60 L of $\Phi$ Elev. = 825.91	B.M. #19 Sba. 81+20 Spike in side 15" chestnut 20' 60 L of $\Phi$ Elev. = 822.13	B.M. #20 Sba. 84+36 Spike in root 15" elm 20' 60 L of $\Phi$ Elev. = 807.83	B.M. #21 Sba. 86+44 Spike in root 10" cherry 24' 60 L of $\Phi$ Elev. = 813.19	B.M. #22 Sba. 89+90 Spike in root of 30" elm 24' 60 L of $\Phi$ Elev. = 799.02	B.M. #23 Sba. 93+05 Spike in side of 10" pear 25' 60 L of $\Phi$ Elev. = 794.00	B.M. #24 Sba. 95+65 Spike in root 15" maple 22' 60 L of $\Phi$ Elev. = 797.24
--	--	---	---	---	--	---	---	--	--

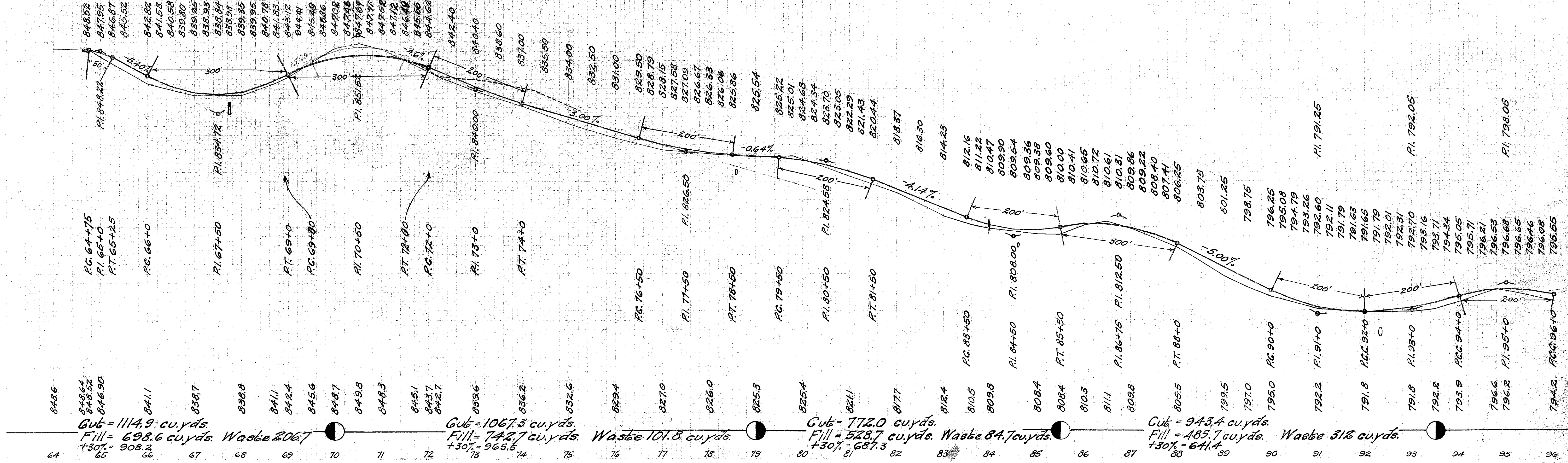

Cut = 1114.9 cu. yds.  
Fill = 698.6 cu. yds. Waste 206.7  
+30% = 908.3

Cut = 1067.3 cu. yds.  
Fill = 742.7 cu. yds.  
+30% = 965.5

Cut = 772.0 cu. yds.  
Fill = 528.7 cu. yds. Waste 84.7 cu. yds.  
+30% = 687.3

Cut = 943.4 cu. yds.  
Fill = 485.7 cu. yds. Waste 316 cu. yds.  
+30% = 641.4