

I.C.H. No. 466 SEC. D
LAKE COUNTY

Sta 25+04 Remove 20'-15" corrugated iron pipe & build 36" 15" corrugated iron pipe culvert 40 long x 12 H.W.S. Quantities 40'-15" corr. iron pipe 2.3 cu. yds. 1-2" concrete 6 cu. yds. excavation 70 lbs. steel Put tile thru headwalls as outlets for 6" tile drains

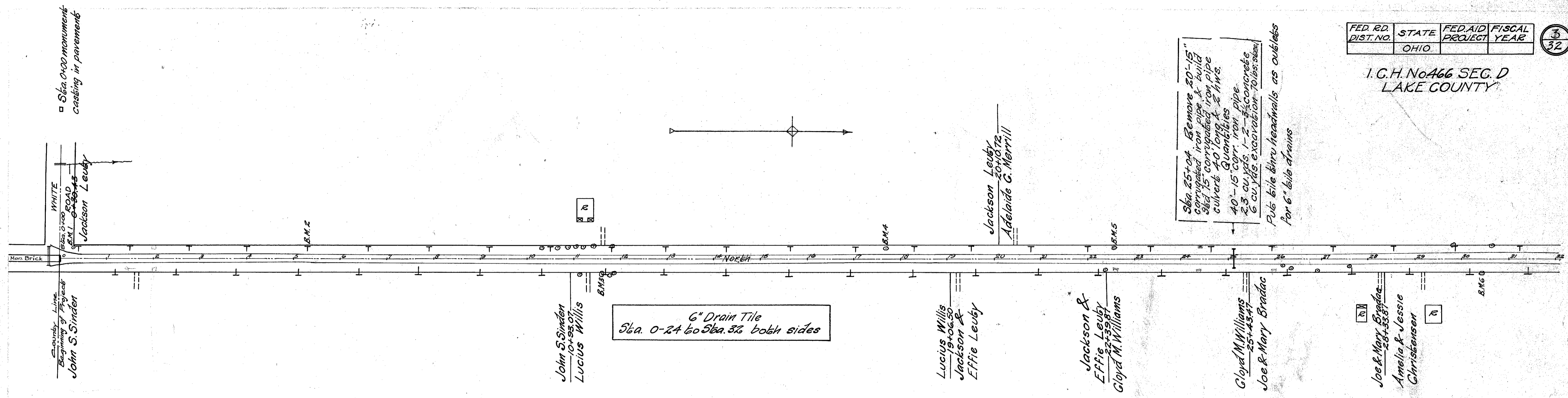

B.M. #1 Sta 0+30
Top of boulder
25' 60 L of Φ
Elev. 889.25

B.M. #2 Sta. 5+27
Spike in keel pole
15' 60 L of Φ
Elev. 887.36

B.M. #3 Sta. 11+58
Spike in root 18' maple
33' 60 R. of Φ
Elev. 882.30

B.M. #4 Sta. 17+64
Spike in root 24' maple
21' 60 L of Φ
Elev. 887.46

B.M. #5 Sta. 22+53
Spike in side 15' ash
24' 60 L of Φ
Elev. 874.93

B.M. #6 Sta. 30+31
Spike in root 36' elm
32' 60 L of Φ
Elev. 878.54

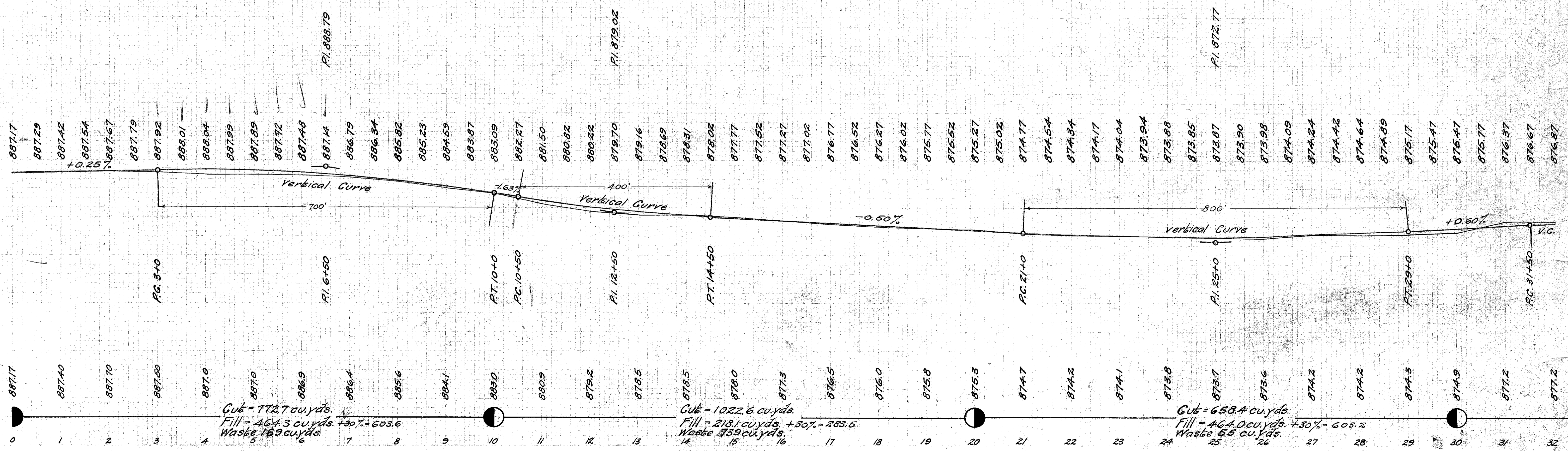

Cut = 772.7 cu. yds.
Fill = 464.3 cu. yds. +30% = 603.6
Waste 169 cu. yds.

Cut = 1022.6 cu. yds.
Fill = 218.1 cu. yds. +30% = 283.5
Waste 739 cu. yds.

Cut = 658.4 cu. yds.
Fill = 464.0 cu. yds. +30% = 603.2
Waste 55 cu. yds.