

EXTRA AREA DETAIL

SOUTH CONNECTION S.R. 91 & LAK. 1-2.16 (S.R. 1)

SCALE: 1" = 20'

FED. RD. DIVISION	STATE	PROJECT	43 146
2	OHIO		

LAKE COUNTY
LAK.-91-(0.00)-(2.38)

CURVE DATA

- | | |
|-------------------------|-------------------|
| ① L.S. = 150.00' | ② Δ = 16°-45'-28" |
| θ _s = 3°-45' | D = 5° |
| P = 0.82' | R = 1145.92' |
| K = 74.99' | T = 168.78' |
| X.C. = 149.94' | L = 335.16' |
| Y.C. = 3.27' | Ch = 336.96' |
| L.T. = 100.02' | E = 12.36' |
| S.T. = 50.02' | |
| L.C. = 149.97' | |
-
- | | |
|-------------------|-------------------|
| ③ Δ = 89°-20'-55" | ④ Δ = 89°-31'-27" |
| D = 286°-28'-44" | D = 286°-28'-44" |
| R = 20' | R = 20' |
| T = 19.77' | T = 19.83' |
| L = 31.08' | L = 31.25' |
| Ch = 28.12' | Ch = 28.17' |
| E = 8.12' | E = 8.17' |
-
- | |
|-------------------|
| ⑤ Δ = 65°-53'-45" |
| D = 76°-23'-40" |
| R = 75' |
| T = 48.61' |
| L = 86.26' |
| Ch = 81.58' |
| E = 14.37' |

S. R. 91 RELOCATION

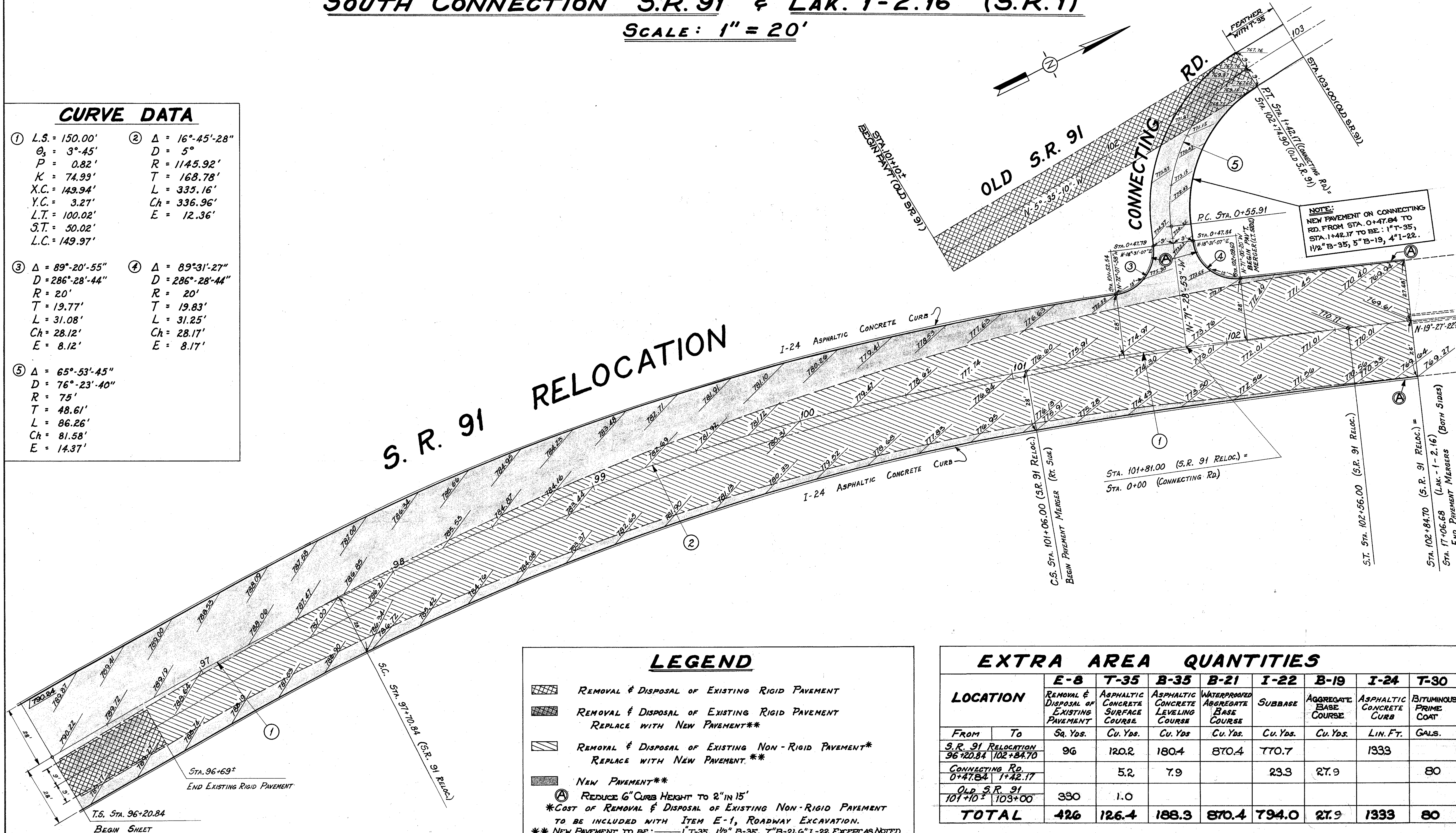

NOTE:
NEW PAVEMENT ON CONNECTING RD. FROM STA. 0+47.84 TO STA. 1+42.17 TO BE: 1" T-35, 1 1/2" B-35, 5" B-19, 4" I-22.

LEGEND

- REMOVAL & DISPOSAL OF EXISTING RIGID PAVEMENT
- REMOVAL & DISPOSAL OF EXISTING RIGID PAVEMENT REPLACE WITH NEW PAVEMENT**
- REMOVAL & DISPOSAL OF EXISTING NON-RIGID PAVEMENT* REPLACE WITH NEW PAVEMENT.**
- NEW PAVEMENT**
- Ⓐ REDUCE 6" CURB HEIGHT TO 2" IN 15'
- *COST OF REMOVAL & DISPOSAL OF EXISTING NON-RIGID PAVEMENT TO BE INCLUDED WITH ITEM E-1, ROADWAY EXCAVATION.
- ** NEW PAVEMENT TO BE: 1" T-35, 1 1/2" B-35, 7" B-21, 6" I-22 EXCEPT AS NOTED.

EXTRA AREA QUANTITIES

LOCATION		E-8	T-35	B-35	B-21	I-22	B-19	I-24	T-30
		REMOVAL & DISPOSAL OF EXISTING PAVEMENT	ASPHALTIC CONCRETE SURFACE COURSE	ASPHALTIC CONCRETE LEVELING COURSE	WATERPROOFED AGGREGATE BASE COURSE	SUBBASE	AGGREGATE BASE COURSE	ASPHALTIC CONCRETE CURB	BITUMINOUS PRIME COAT
FROM	TO	Sq. Yds.	Cu. Yds.	Cu. Yds.	Cu. Yds.	Cu. Yds.	Cu. Yds.	LIN. FT.	GALS.
S.R. 91 RELOCATION 96+20.84 102+84.70		96	120.2	180.4	870.4	770.7		1333	
CONNECTING RD. 0+47.84 1+42.17			5.2	7.9		23.3	27.9		80
OLD S.R. 91 101+10 103+00		330	1.0						
TOTAL		426	126.4	188.3	870.4	794.0	27.9	1333	80