

EXTRA AREA DETAIL EDDY RD.

SCALE: 1"=20'

FED. RD. DIVISION	STATE	PROJECT	
2	OHIO		42 146

LAKE COUNTY
LAK. 91-(0.00)-(2.38)

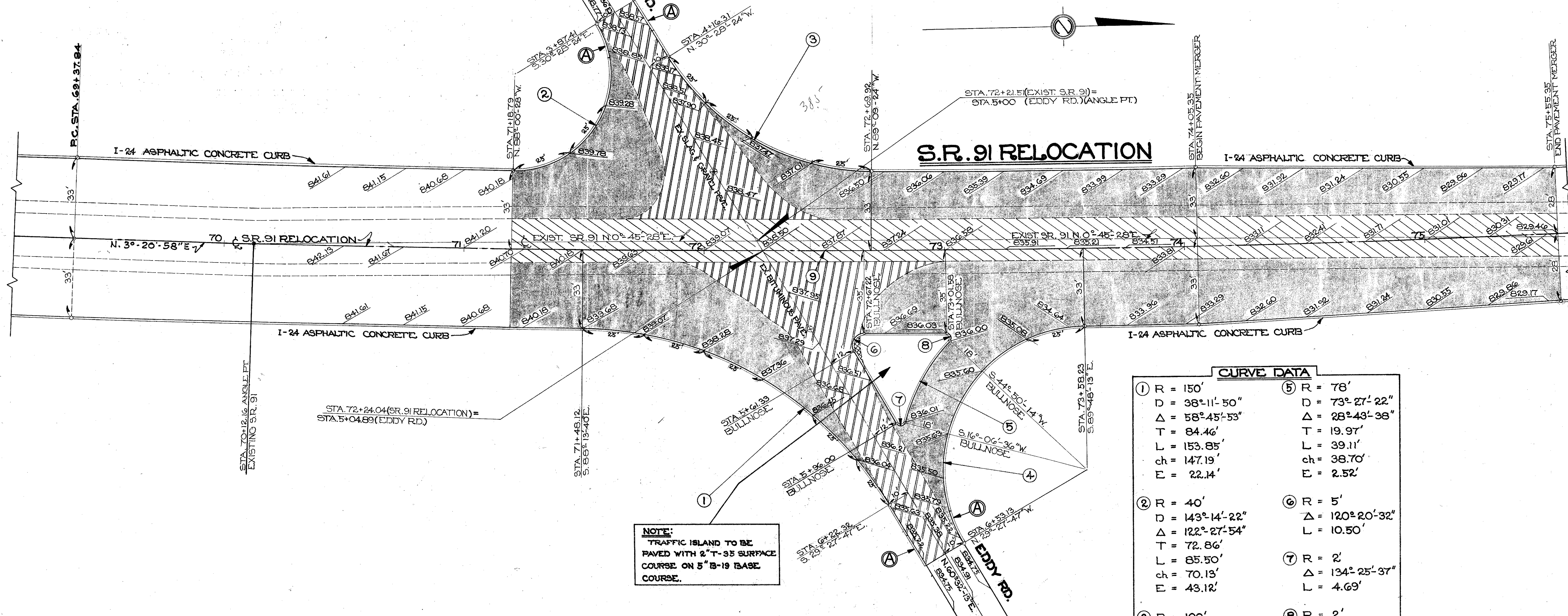

STA. 72+24.04 (SR. 91 RELOCATION) =
STA. 5+04.89 (EDDY RD.)

NOTE:
TRAFFIC ISLAND TO BE
PAVED WITH 2" T-35 SURFACE
COURSE ON 5" B-19 BASE
COURSE.

CURVE DATA

① R = 150' D = 38°-11'-50" Δ = 58°-45'-53" T = 84.46' L = 153.85' ch = 147.19' E = 22.14'	⑤ R = 78' D = 73°-27'-22" Δ = 28°-43'-38" T = 19.97' L = 39.11' ch = 38.70' E = 2.52'
② R = 40' D = 143°-14'-22" Δ = 122°-27'-54" T = 72.86' L = 85.50' ch = 70.13' E = 43.12'	⑥ R = 5' Δ = 120°-20'-32" L = 10.50'
③ R = 100' D = 57°-17'-45" Δ = 58°-41'-00" T = 56.21' L = 102.42' ch = 98.00' E = 14.72'	⑦ R = 2' Δ = 134°-25'-37" L = 4.69'
④ R = 60' D = 95°-29'-35" Δ = 119°-39'-34" T = 103.21' L = 125.31' ch = 103.74' E = 59.39'	⑧ R = 2' Δ = 134°-12'-57" L = 4.69'
	⑨ R = 7639.44' D = 0°-45'-00" Δ = 8°-09'-04" T = 544.33' L = 1086.82' ch = 1085.90' E = 19.38'

EXTRA AREA QUANTITIES

STATION	FROM	TO	E-8	B-35	T-35	B-21	I-22	I-24	B-19
			REMOVAL & DISPOSAL OF EXISTING PAVEMENT	1 1/2" ASPH. CONCRETE LEVELING COURSE	1" ASPH. CONCRETE SURFACE COURSE	WATERPROOFED AGGREGATE BASE COURSE	SUBBASE	ASPHALTIC CONCRETE CURB	AGGREGATE BASE COURSE
	SQ. YDS.	CU. YDS.	CU. YDS.	CU. YDS.	CU. YDS.	LIN. FT.	CU. YDS.	CU. YDS.	
71+18.79	75+55.35	973	172	115	828	732	1166	13	
TRAFFIC ISLAND				5				13	
TOTAL		973	172	120	828	732	1166	13	

LEGEND

- REMOVAL & DISPOSAL OF EXISTING NON-RIGID PAVEMENT. * REPLACE WITH NEW PAVEMENT. **
 - REMOVAL & DISPOSAL OF EXISTING RIGID PAVEMENT. REPLACE WITH NEW PAVEMENT. **
 - NEW PAVEMENT **
 - REMOVAL & DISPOSAL OF EXISTING NON-RIGID PAVEMENT. *
 - REDUCE 6" CURB HEIGHT TO 2" IN 15 FT.
- * COST OF REMOVAL AND DISPOSAL OF EXISTING NON-RIGID PAVEMENT TO BE INCLUDED WITH ITEM E-1, ROADWAY EXCAVATION.
- ** NEW PAVEMENT TO BE: 1" T-35, 1 1/2" B-35, 7" B-21, 6" I-22.