

B.M.#5 - SPIKE IN C.E.I. OBT. POLE, E. SIDE OF S.R.#91  
(STA. 80+37) 29' R. ELEV. = 824.836

LAKE COUNTY  
LAK. - 91-(0.00)-(2.38)

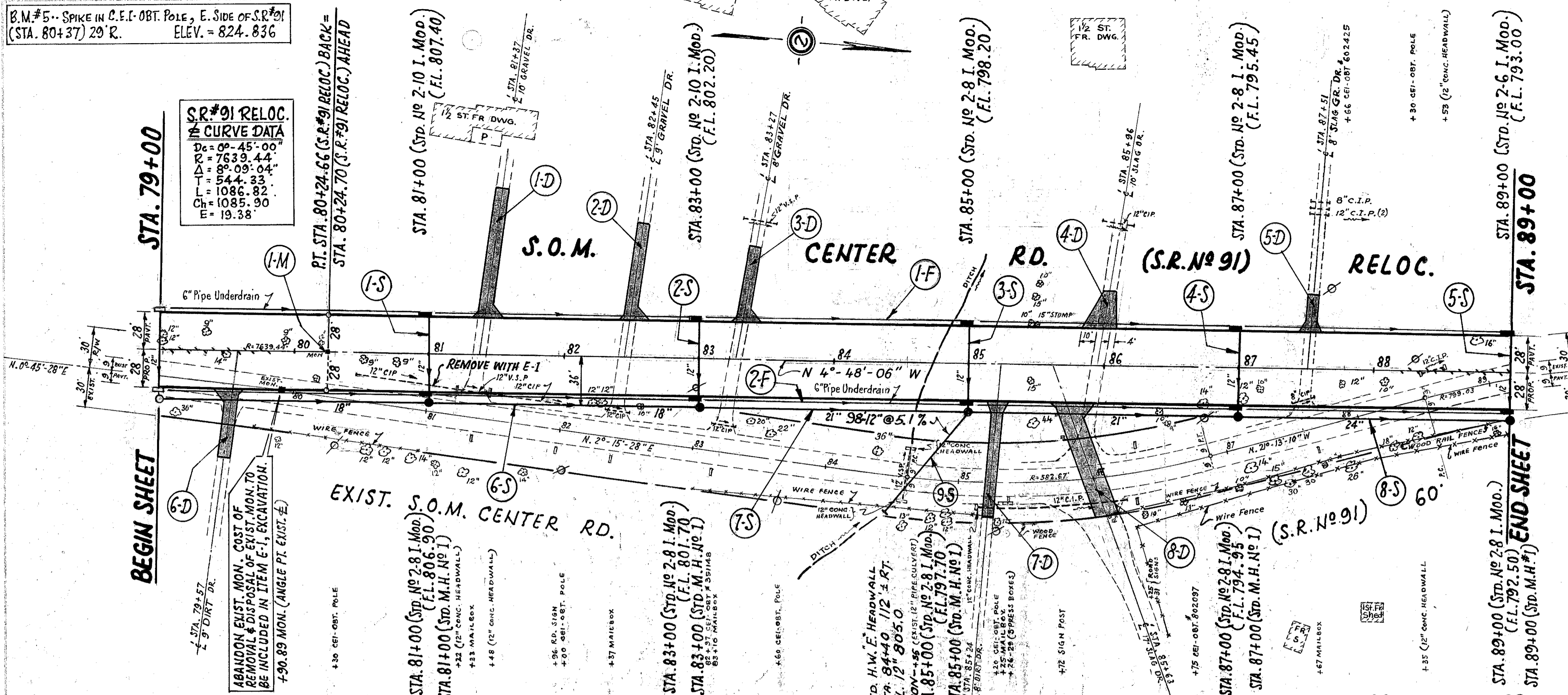

REF. No	STATION	SIDE R OR L	ITEM I-1	
			6" PIPE Class I-3 (DEEP)	6" OUTLET PIPE Class F-4
	FROM	TO	LIN. FT.	LIN. FT.
1-F	79+00	89+00	L 920	50
2-F	79+00	89+00	R 920	50
<b>TOTAL</b>			<b>1840</b>	<b>100</b>

Ref. No	Station	Loc.	ITEM I-8
			STANDARD MONUMENT ASSEMBLY EACH
I-M	R.T. 80+24.66	≠	1
<b>TOTAL</b>			<b>1</b>

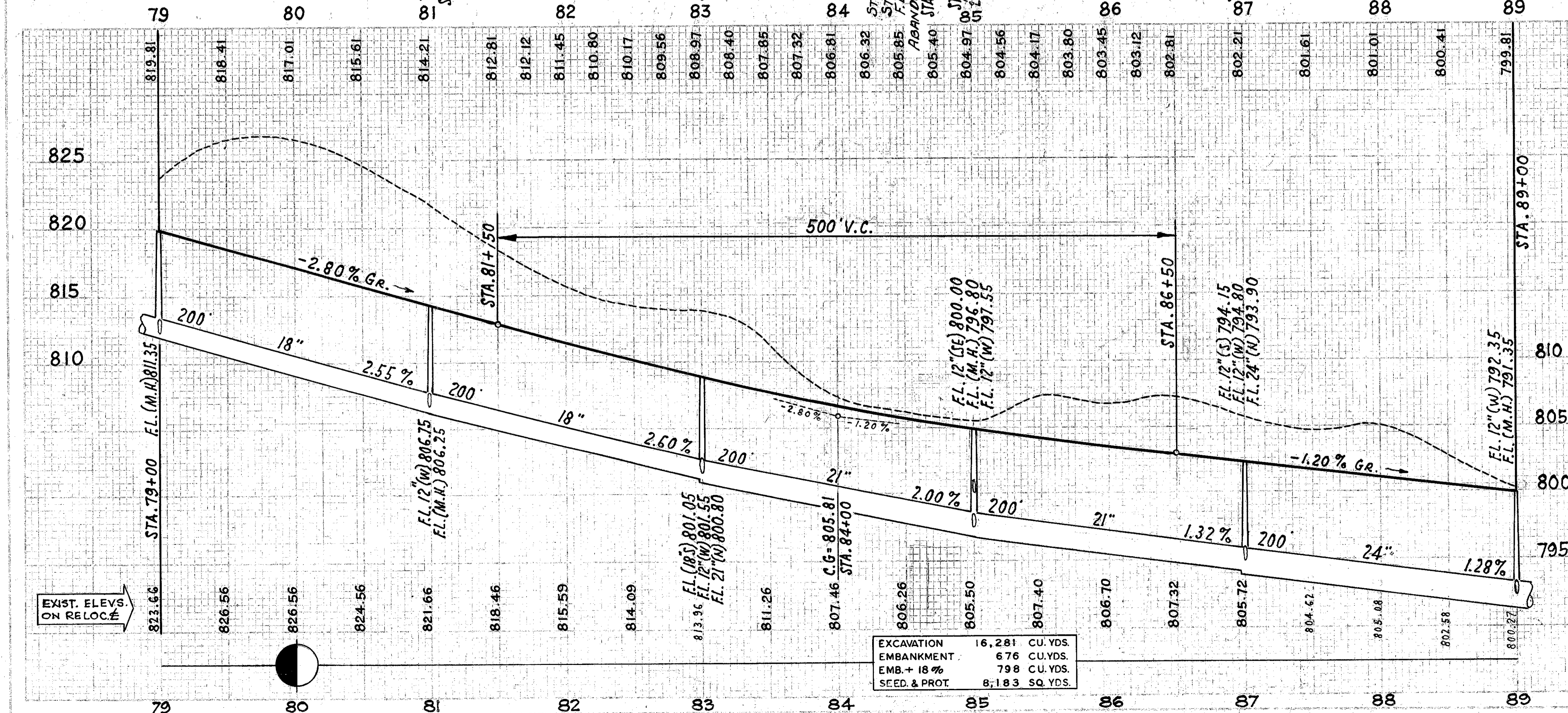

EXCAVATION	16,281 CU. YDS.
EMBANKMENT	676 CU. YDS.
EMB. + 18%	798 CU. YDS.
SEED. & PROT.	8,183 SQ. YDS.

Station	ITEM I-23	
	FROM	TO
	79+03	88+99
<b>TOTAL</b>	<b>167</b>	

REF. No	STATION	ITEM I-1 ... LIN. FEET			ITEM I-8		ITEM I-2	
		Class J-1 PIPE	Class E-1 PIPE	Class D-1 PIPE	STD. No. 1	STD. No. 2		
	FROM	TO	12"	18"	24"	12"	MASONRY	
1-S	81+00	81+00	58	7		1		
2-S	83+00	83+00	58	7		1		
3-S	85+00	85+00	58	7		2		
4-S	87+00	87+00	58	7		2		
5-S	89+00	89+00	58	7		1		
6-S	79+00	83+00	200	400		2	0.23	
7-S	83+00	85+00	200	200		1		
8-S	85+00	89+00	200	200		2		
9-S	84+40	85+00			98			
<b>TOTAL</b>		<b>290</b>	<b>200</b>	<b>35</b>	<b>400</b>	<b>200</b>	<b>98</b>	<b>0.23</b>

PLAN & PROFILE .. S.R.#91 RELOC. .. STA. 79+00 to STA. 89+00