

B.M. #12--SPIKE C.E.I.-OBT. P.O.L.E. # 357252  
STA. 10+20 (S.R.#91) 25' L. ELEV. = 882.906

REF. No.	STATION	ITEM I-1				ITEM I-8	E-8	B-70	B-35
		PIPE LIN. FEET							
		Class J-1	Class J-1	Class E-1	Class E-1				
		ENCASED	12"	12"	15"				
1-S	0+52	56		10		2	10	0.7	
2-S	2+00		56	7		2	10	0.7	
3-S	6+50		56	7		2	10	0.7	
4-S	8+50		56	7		2	10	0.7	
5-S	0+60	2+00		140		2			
6-S	2+00	6+50		450		1			
7-S	6+50	10+00		350		1			
<b>TOTAL</b>	<b>VILLAGE OF WILLOUGHBY HILLS</b>	<b>56</b>	<b>168</b>	<b>171</b>	<b>800</b>	<b>8</b>	<b>40</b>	<b>2.8</b>	

**NOTE:**  
DEPTH OF I-1, 6" UNDERDRAINS SHALL BE LESS THAN TYPICAL FROM WHITE RD. to STA. 2+00 S.R. #91.

Ref. No.	Station	SIDE R OR L	ITEM I-1			
			6" PIPE Class I-3 (SHALLOW)	6" OUTLET PIPE Class F-4	PIPE SPECIAL 6" TEE Class I	
1-F	0+67.65 WHITE RD.	10+00	L	940	60	1
2-F	0+00	10+00	R	950	50	
<b>TOTAL</b>	<b>VILLAGE OF WILLOUGHBY HILLS</b>			<b>1890</b>	<b>110</b>	<b>1</b>
2-F	0+46.73	0+00	R	48		
<b>TOTAL</b>	<b>MAYFIELD VILLAGE</b>			<b>48</b>		

Station	ITEM I-23	
	FROM	TO
0+38	9+98	81
<b>TOTAL</b>	<b>VILLAGE OF WILLOUGHBY HILLS</b>	<b>81</b>

Ref. No.	Station	Loc.	ITEM I-8	
			STANDARD MONUMENT ASSEMBLY	EACH
1-M	6+00	≠	1	
<b>TOTAL</b>	<b>VILLAGE OF WILLOUGHBY HILLS</b>		<b>1</b>	

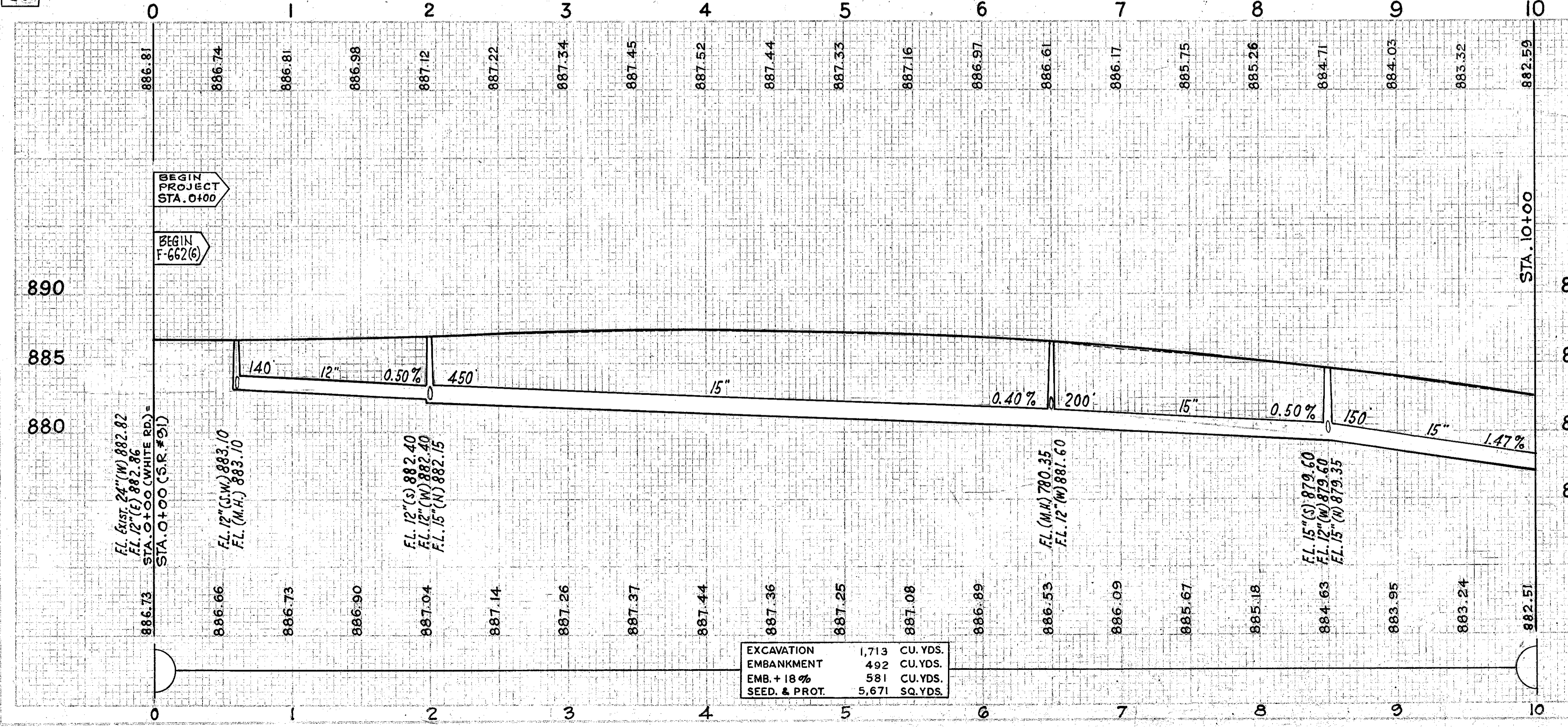

EXCAVATION	1,713	CU. YDS.
EMB. + 18%	492	CU. YDS.
SEED. & PROT.	5,671	SQ. YDS.