

# SOIL PROFILE

LAKE COUNTY

LAK-91-(0.00)(2.38)

OHIO STATE HIGHWAY  
TESTING LABORATORY  
1620 W. BROAD ST., COLUMBUS 23, OHIO

4  
7

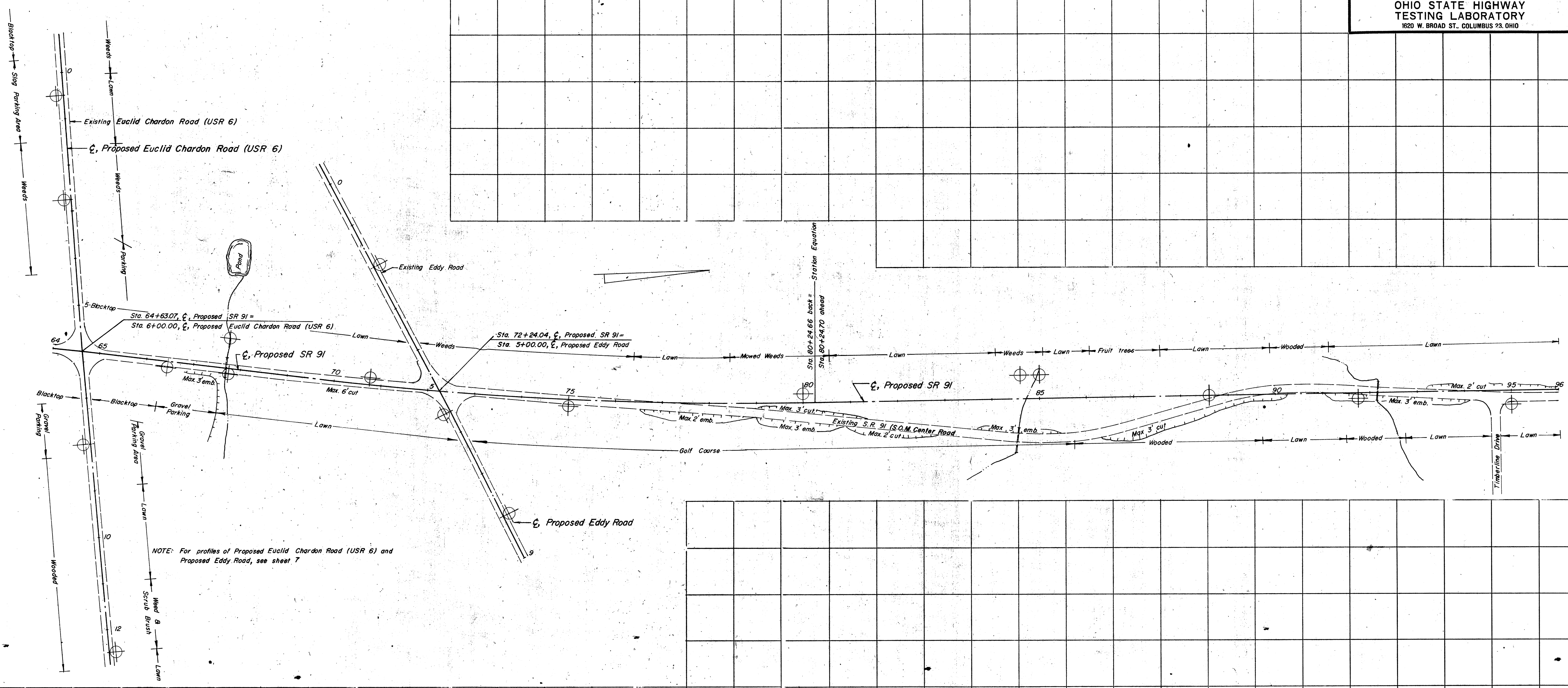

NOTE: For profiles of Proposed Euclid Chardon Road (USR 6) and Proposed Eddy Road, see sheet 7