

LAKE COUNTY
 CITY OF MENTOR & VILLAGE OF KIRTLAND HILLS
 T = 9&10 N, R = 9 W

PPN. 16-A-009-0-00-001-0

PPN. 16-A-009-A-00-026-0

PPN. 16-A-009-A-00-025-0

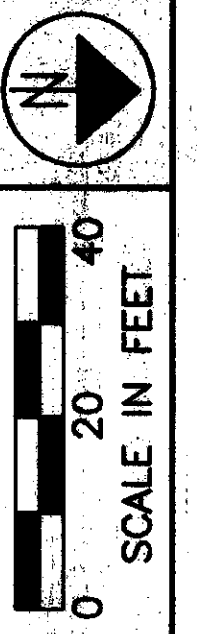

PID NO. 9331

R/W DESIGNER P.S.L.
 R/W REVIEWER W.D.B.

RIGHT OF WAY PLAN
 STA. 66+50.00 TO STA. 72+00.00

LAK-IR90/SR615-9.26/1.51

19/24

389
393

SEE SHEET 18
 MATCH LINE STA. 66+50.00

MATCH LINE STA. 72+00.00
 SEE SHEET 20

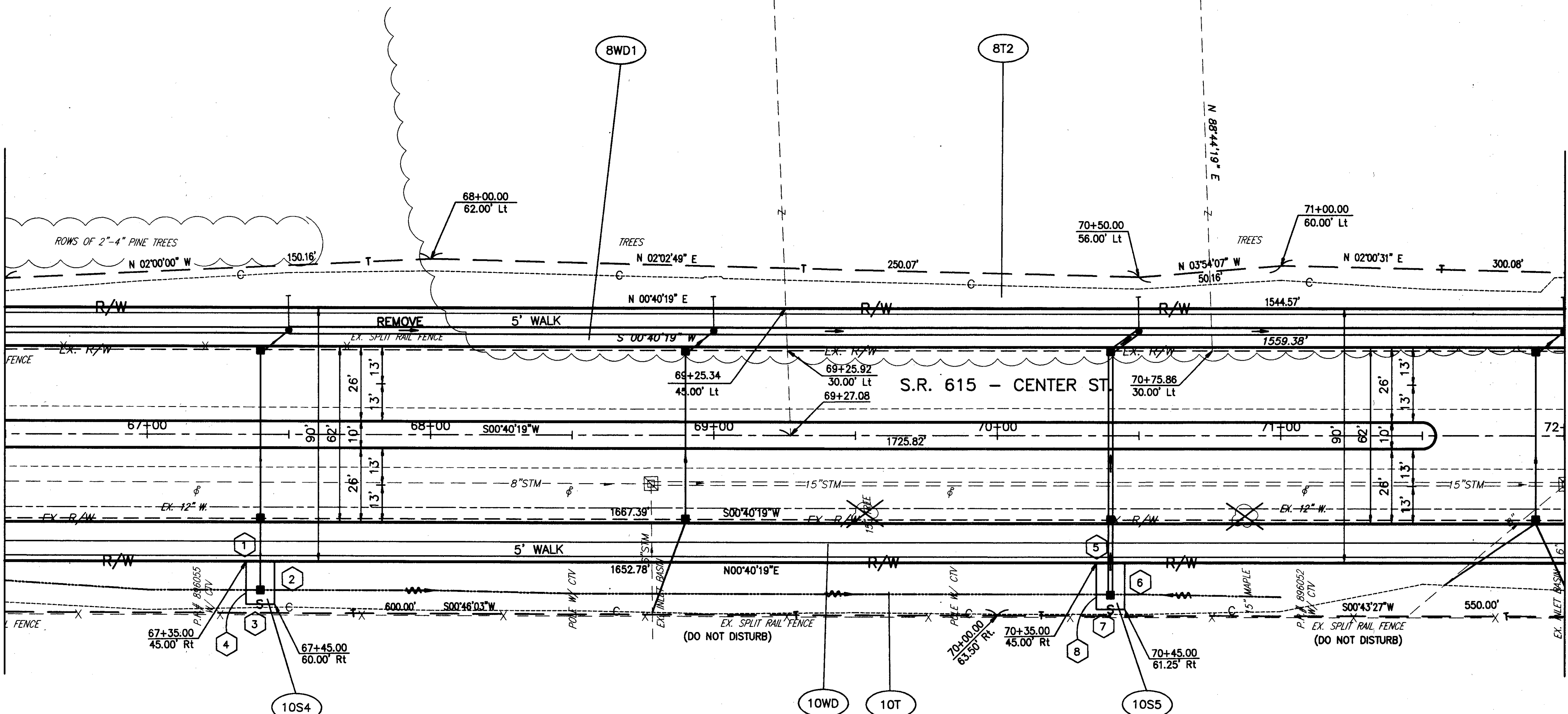

- 10S4
- 1 N00°40'19"E 10.00'
 - 2 S89°19'41"E 15.00'
 - 3 S00°40'19"W 10.00'
 - 4 N89°19'41"W 15.00'

PARCEL 10S4 OVERLAPS PARCEL 10T BY 150 S.F.

PPN. 16-A-011-0-00-001-0

10

- 10S5
- 5 N00°40'19"E 10.00'
 - 6 S89°19'41"E 16.25'
 - 7 S00°40'19"W 10.00'
 - 8 N89°19'41"W 16.25'

PARCEL 10S5 OVERLAPS PARCEL 10T BY 163 S.F.

THE LOCATION & WIDTH OF THE EXISTING LIMITED ACCESS & RIGHT OF WAY LINES WERE ESTABLISHED USING ODOT PROJECT LAK-1-6.97 (1960) & COUNTY RECORDS.

ALL BEARINGS FOR THIS PROJECT ARE BASED ON THE ODOT PROJECT LAK-1-6.97 (APRIL 1960)

REV	DATE	DESCRIPTION

DATE COMPLETED:

H:\CT\97125\SDSK\RW\PARCEL8.dwg 08/23/2000 10:48:00 AM EDT