

LAKE COUNTY
CITY OF MENTOR & VILLAGE OF KIRTLAND HILLS
T = 9 & 10 N, R = 9 W

①	S.R. 615 CURVE DATA P.I. STA. = 28+50.17 $\Delta = 8^{\circ} 00' 00''$ $D_c = 4^{\circ} 00' 00''$ $R = 1,432.39'$ $T = 100.16'$ $L = 200.00'$ $E = 3.50'$ $C = 199.84'$ $N.04^{\circ} 27' 37'' W.$	②	S.R. 615 CURVE DATA P.I. STA. = 23+39.86 $\Delta = 28^{\circ} 53' 20''$ $D_c = 6^{\circ} 00' 00''$ $R = 954.93'$ $T = 245.97'$ $E = 31.17'$ $C = 476.40'$ $CBRG = N05^{\circ} 59' 03'' E.$
---	---	---	--

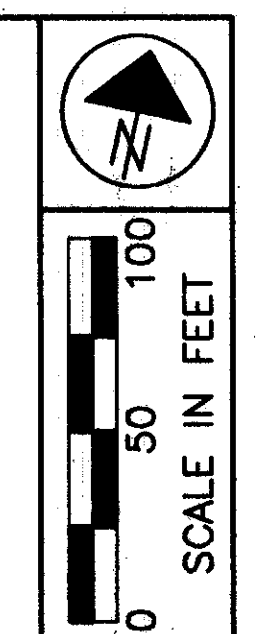

SEE SHEET NO. 9

SEE SHEET NO. 9
MATCH LINE STA. 30+00

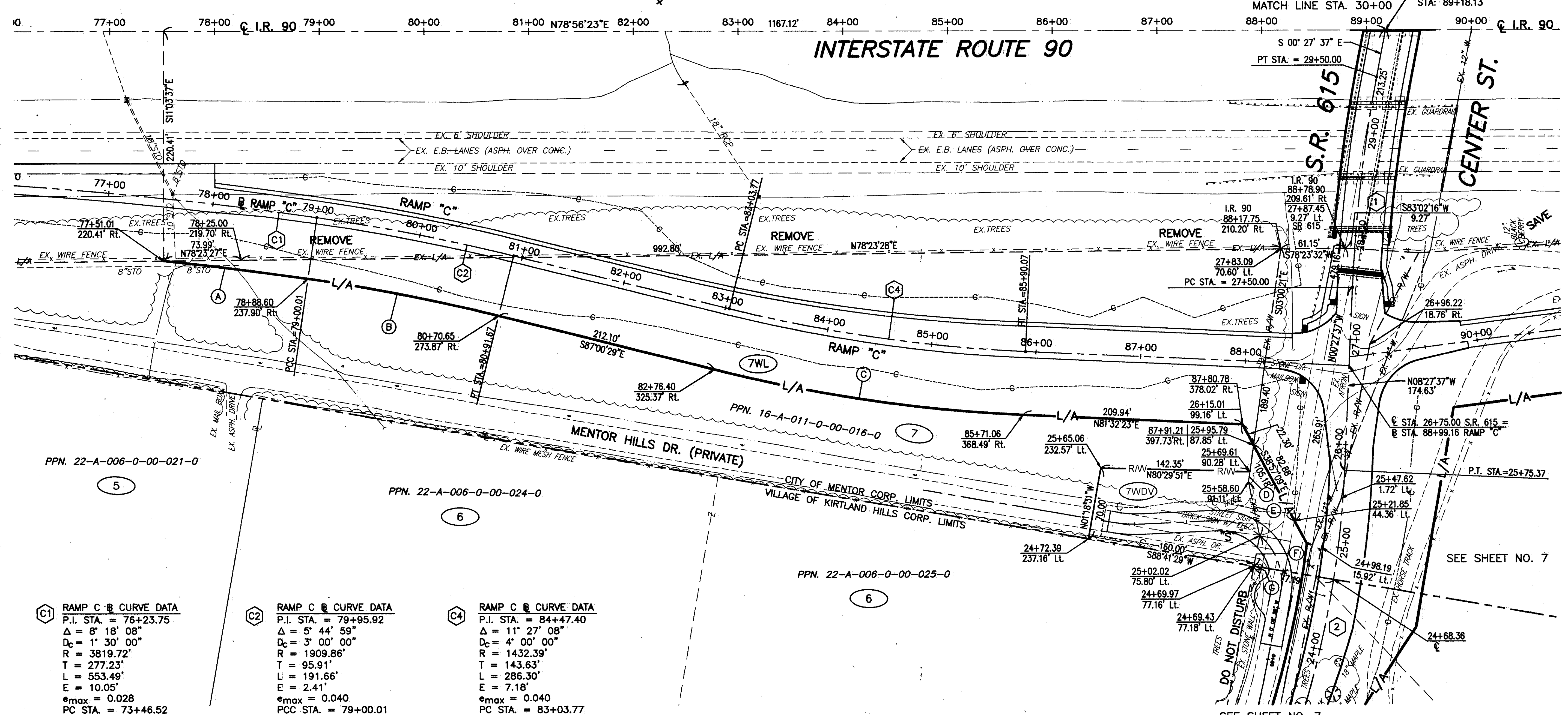

① RAMP C @ CURVE DATA

P.I. STA. = 76+23.75
$\Delta = 8^{\circ} 18' 08''$
$D_c = 1^{\circ} 30' 00''$
$R = 3819.72'$
$T = 277.23'$
$L = 553.49'$
$E = 10.05'$
$e_{max} = 0.028$
PC STA. = 73+46.52
PCC STA. = 79+00.01

② RAMP C @ CURVE DATA

P.I. STA. = 79+95.92
$\Delta = 5^{\circ} 44' 59''$
$D_c = 3^{\circ} 00' 00''$
$R = 1909.86'$
$T = 95.91'$
$L = 191.66'$
$E = 2.41'$
$e_{max} = 0.040$
PCC STA. = 79+00.01
PT STA. = 80+91.67

④ RAMP C @ CURVE DATA

P.I. STA. = 84+47.40
$\Delta = 11^{\circ} 27' 08''$
$D_c = 4^{\circ} 00' 00''$
$R = 1432.39'$
$T = 143.63'$
$L = 286.30'$
$E = 7.18'$
$e_{max} = 0.040$
PC STA. = 83+03.77
PT STA. = 85+90.07

①	CURVE DATA $R = 3759.72'$ $\Delta = 02^{\circ} 06' 49''$ $L = 138.69'$ $T = 69.36'$ $C = 138.69'$ $N.86^{\circ} 11' 06'' E.$	②	CURVE DATA $R = 1849.86'$ $\Delta = 05^{\circ} 45' 00''$ $L = 185.65'$ $T = 92.90'$ $C = 185.56'$ $S.89^{\circ} 52' 59'' E.$	③	CURVE DATA $R = 1492.39'$ $\Delta = 11^{\circ} 27' 08''$ $L = 298.30'$ $T = 149.65'$ $C = 297.80'$ $N.87^{\circ} 15' 57'' E.$	④	10.00' S03^{\circ} 00' 21" E	⑤	53.85' S22^{\circ} 15' 42" E	⑥	29.51' S00^{\circ} 27' 37" E	⑦	0.50' S00^{\circ} 06' 59" E
---	--	---	--	---	---	---	------------------------------	---	------------------------------	---	------------------------------	---	-----------------------------

- LEGEND**
- ◆ PROPOSED MONUMENT ASSEMBLY
 - PROPOSED CONTROL POINTS (PC/PT/SC/TS/CS & ST, ETC.)

THE LOCATION & WIDTH OF THE EXISTING LIMITED ACCESS & RIGHT OF WAY LINES WERE ESTABLISHED USING ODOT PROJECT LAK-1-6.97 (1960) & COUNTY RECORDS.

NOTE: ALL STATION & OFFSETS USED FOR RIGHT OF WAY TAKES ARE BASED OFF OF I.R. 90 & S.R. 615. RAMP C STATIONING DOES NOT APPLY.

ALL BEARINGS FOR THIS PROJECT ARE BASED ON THE ODOT PROJECT LAK-1-6.97 (APRIL 1960)

REV	DATE	DESCRIPTION
2	2/2002	CHANGED PCL 7T TO 7WDV
1	5/22/01	REVISE PARCEL 7T

DATE COMPLETED:

PID NO. 9331

R/W DESIGNER P.S.L.
R/W REVIEWER W.D.B.

RIGHT OF WAY PLAN

LAK-IR90/SR615-9.26/1.51

8 / 24

379
393