

H:\CT\97125\SDSK\7125703C.DWG - PLOT SCALE = 1 : 1

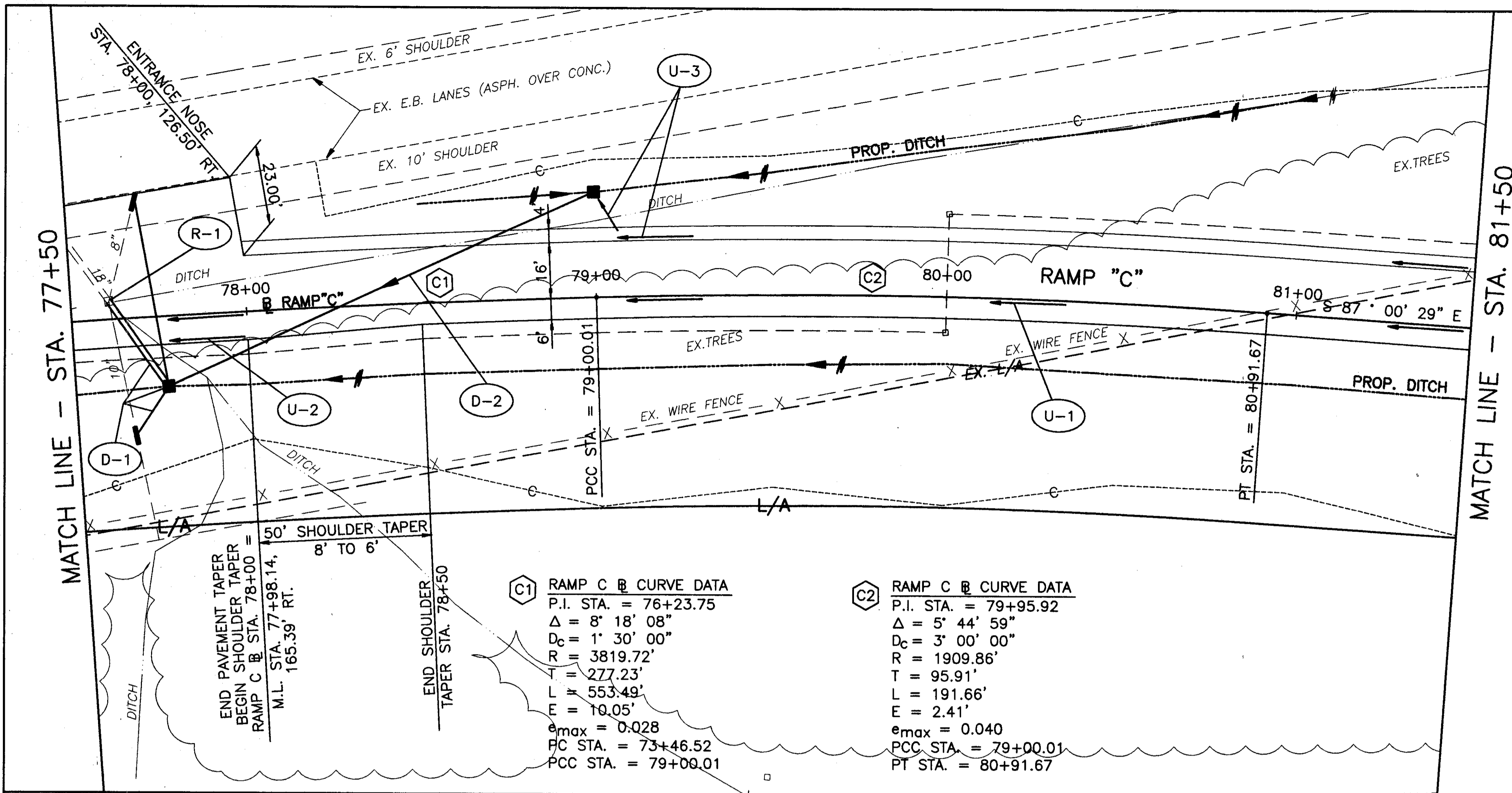

(C1) RAMP C @ CURVE DATA

P.I. STA. = 76+23.75
 $\Delta = 8' 18'' 08''$
 $D_c = 1' 30'' 00''$
 $R = 3819.72'$
 $L = 277.23'$
 $T = 553.49'$
 $E = 10.05'$
 $e_{max} = 0.028$
 FC STA. = 73+46.52
 PCC STA. = 79+00.01

(C2) RAMP C @ CURVE DATA

P.I. STA. = 79+95.92
 $\Delta = 5' 44'' 59''$
 $D_c = 3' 00'' 00''$
 $R = 1909.86'$
 $T = 95.91'$
 $L = 191.66'$
 $E = 2.41'$
 $e_{max} = 0.040$
 PCC STA. = 79+00.01
 PT STA. = 80+91.67

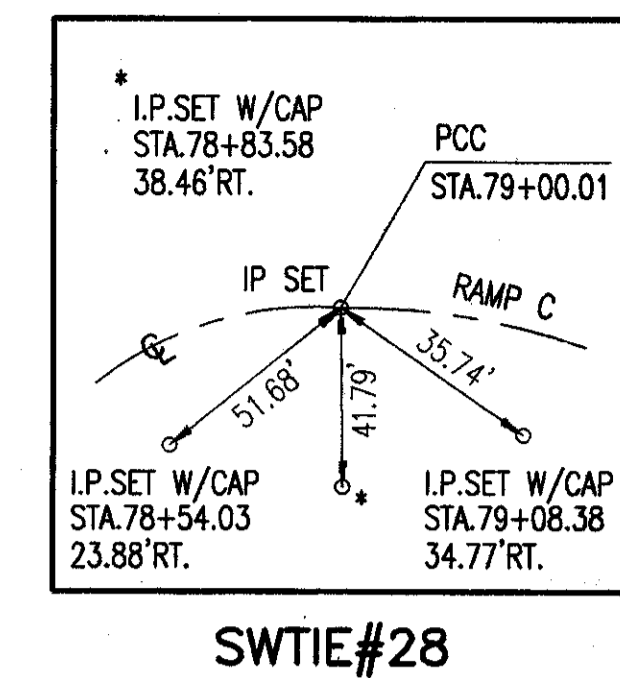
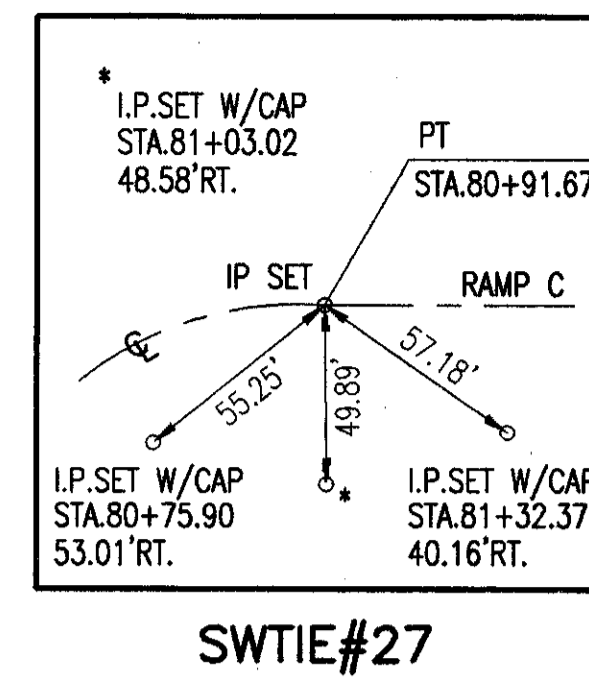

FOR TYPICAL SECTIONS, SEE SHEETS 5 THRU 15
 FOR CROSS SECTIONS AND PIPE PROFILES, SEE SHEETS 216 THRU 225
 FOR SUPERELEVATION TABLES, SEE SHEETS 246 THRU 254
 FOR INTERSECTION DETAILS, SEE SHEETS 255 THRU 262
 FOR SIGNING AND PAVEMENT MARKING PLAN, SEE SHEETS 313 THRU 314

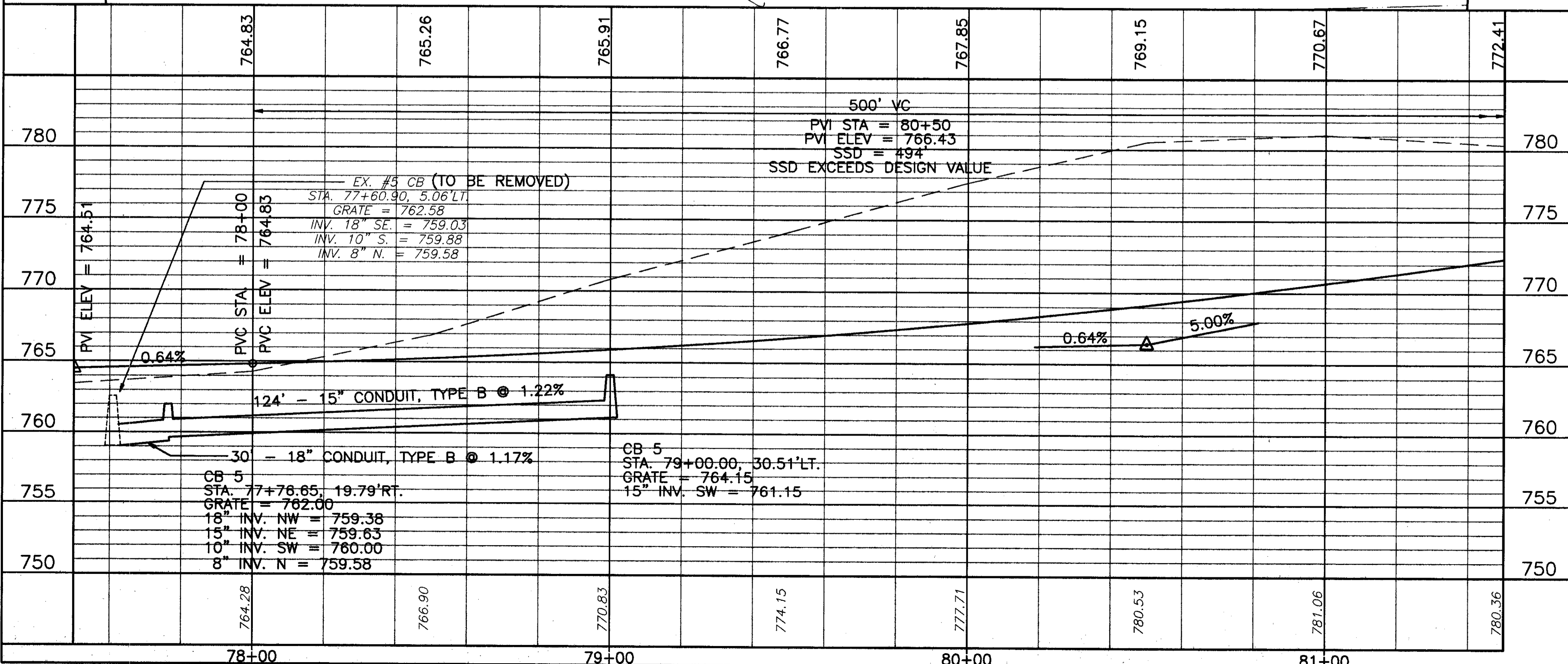

604	CATCH BASIN NO. 5, AS PER PLAN	EACH	1	1	2
603	18" CONDUIT, TYPE B, AS PER PLAN	LIN.FT.	30		30
603	15" CONDUIT, TYPE B, AS PER PLAN	LIN.FT.	124		124
603	10" CONDUIT, TYPE C, AS PER PLAN	LIN.FT.	6		6
202	CATCH BASIN REMOVED	EACH	1		1
TOTALS					

REF	LOCATION	INVERT	SW	SE	N	NE	NW
D-1	STA. 77+60.5, LT. TO STA. 77+76.65, RT.						
D-2	STA. 77+66.65, 19.79' RT. TO STA. 79+00, 30.51' LT.						
R-1	STA. 77+61.0, 5' LT.						
TOTALS							