

H:\CT\97125\SDSK\7125704A.DWG - PLOT SCALE = 1 : 1

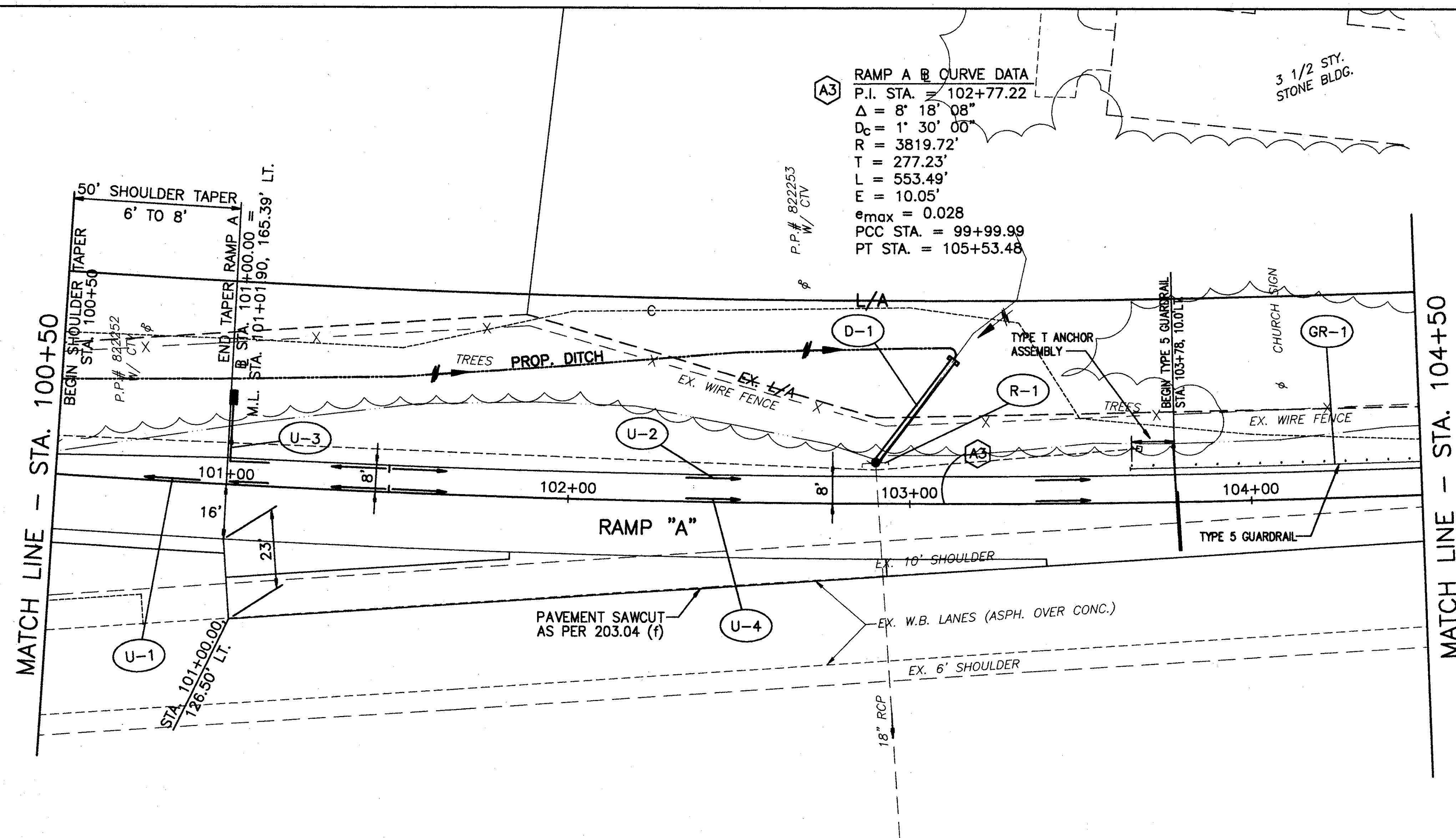

RAMP A @ CURVE DATA
 P.I. STA. = 102+77.22
 $\Delta = 8^\circ 18' 08''$
 $D_c = 1^\circ 30' 00''$
 $R = 3819.72'$
 $T = 277.23'$
 $L = 553.49'$
 $E = 10.05'$
 $e_{max} = 0.028$
 PCC STA. = 99+99.99
 PT STA. = 105+53.48

PROPOSED STRUCTURE DATA - STA. 103+13	
TYPE	= 18" CONDUIT, TYPE A, 706.02
DRAINAGE AREA	= 1.50 AC.
Q ₂₅	= 4.00 C.F.S.
Q ₁₀₀	= 6.00 C.F.S.
HW ₂₅	= 786.69
HW ₁₀₀	= 787.12
V ₂₅	= 6.06 F.P.S.
V ₁₀₀	= 6.64 F.P.S.

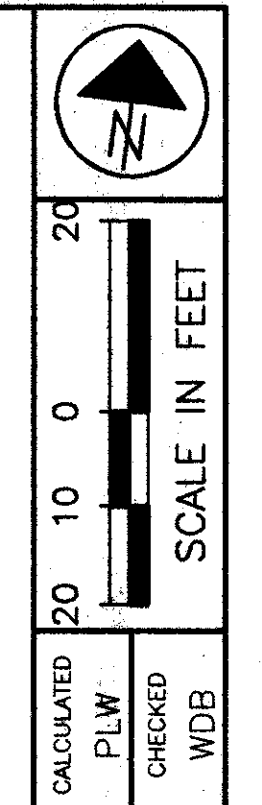

FOR TYPICAL SECTIONS, SEE SHEETS 5 THRU 15
 FOR CROSS SECTIONS AND PIPE PROFILES, SEE SHEETS 175 THRU 185
 FOR SUPERELEVATION TABLES, SEE SHEETS 246 THRU 254
 FOR INTERSECTION DETAILS, SEE SHEETS 255 THRU 262
 FOR SIGNING AND PAVEMENT MARKING PLAN, SEE SHEETS 311 THRU 312

STATION	ELEVATION	PAVEMENT ELEVATION	EXISTING GRADE
101+00	790.90	791.69	792.04
102+00	792.52		792.51
103+00	791.91		793.02
104+00	793.36		792.99

REF	LOCATION	QUANTITY	UNIT	TOTALS
D-1	STA. 102+90.0, 12.2'L. TO STA. 103+13.0, 42.7'L.			
R-1	STA. 102+90.0, 12.2'L.			
602	CONCRETE MASONRY	0.31		0.31
603	18" CONDUIT, TYPE A, 706.02 OR 24" CONDUIT, TYPE A, 707.09 (0.109), AS PER PLAN	38	LINEAL FEET	38
604	MANHOLE NO. 3, AS PER PLAN	1	EACH	1
202	STRUCTURE REMOVED	1	EACH	1
TOTALS				

RAMP A - PLAN AND PROFILE STA. 100+50 TO STA. 104+50

LAK-IR90/SR615-9.26/1.51

172
393