

RAMP A @ CURVE DATA
 P.I. STA. = 97+26.95
 $\Delta = 27^\circ 52' 01''$
 $D_c = 5' 00' 00''$
 $R = 1145.91'$
 $T = 284.30'$
 $L = 557.34'$
 $E = 34.74'$
 $e_{max} = 0.046$
 PC STA. = 94+42.66
 PCC STA. = 99+99.99

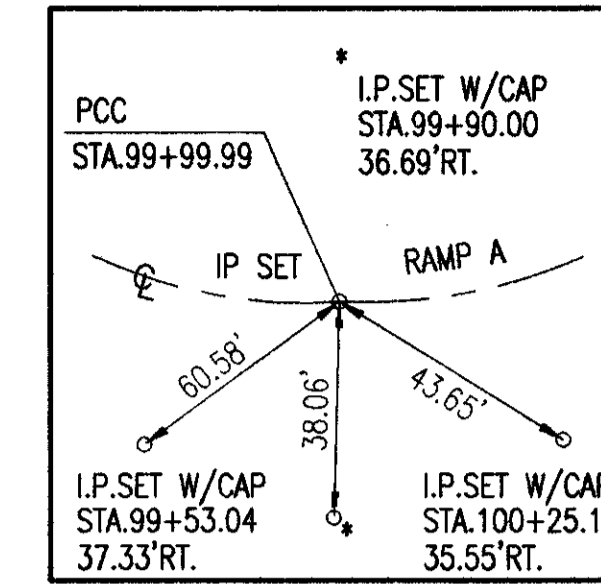

MATCH LINE - STA. 97+00

MATCH LINE - STA. 100+50

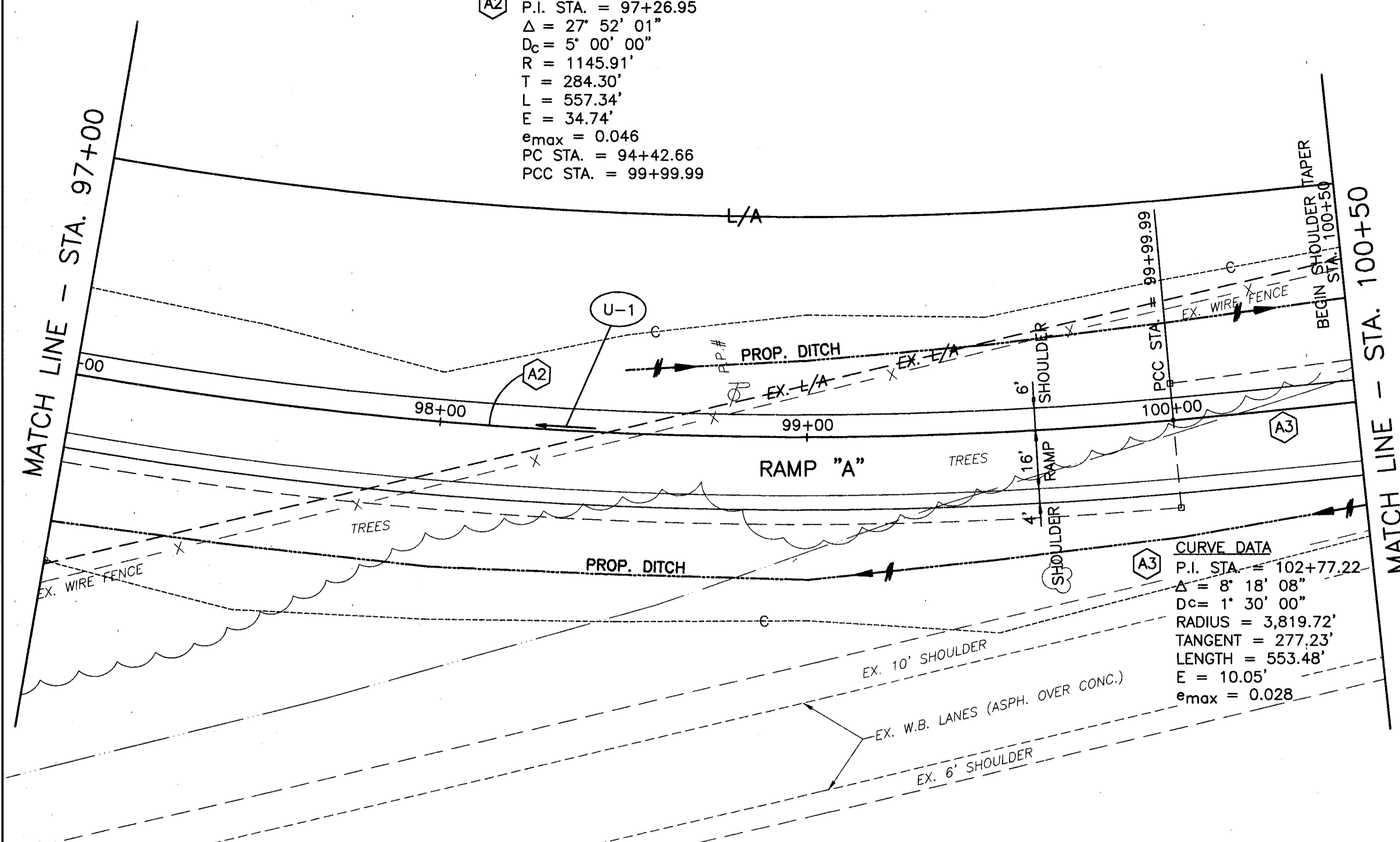

A3 CURVE DATA
 P.I. STA. = 102+77.22
 $\Delta = 8^\circ 18' 08''$
 $D_c = 1' 30' 00''$
 $RADIUS = 3,819.72'$
 TANGENT = 277.23'
 LENGTH = 553.48'
 $E = 10.05'$
 $e_{max} = 0.028$

FOR TYPICAL SECTIONS, SEE SHEETS 5 THRU 15
 FOR CROSS SECTIONS AND PIPE PROFILES, SEE SHEETS 175 THRU 185
 FOR SUPERELEVATION TABLES, SEE SHEETS 246 THRU 254
 FOR INTERSECTION DETAILS, SEE SHEETS 255 THRU 262
 FOR SIGNING AND PAVEMENT MARKING PLAN, SEE SHEETS 311 THRU 312

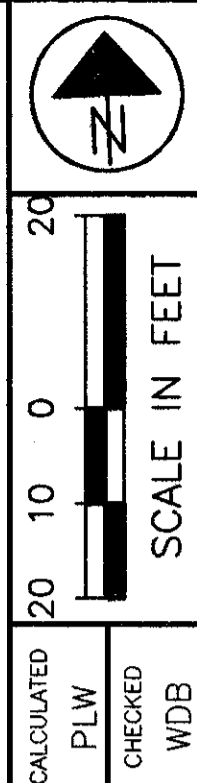
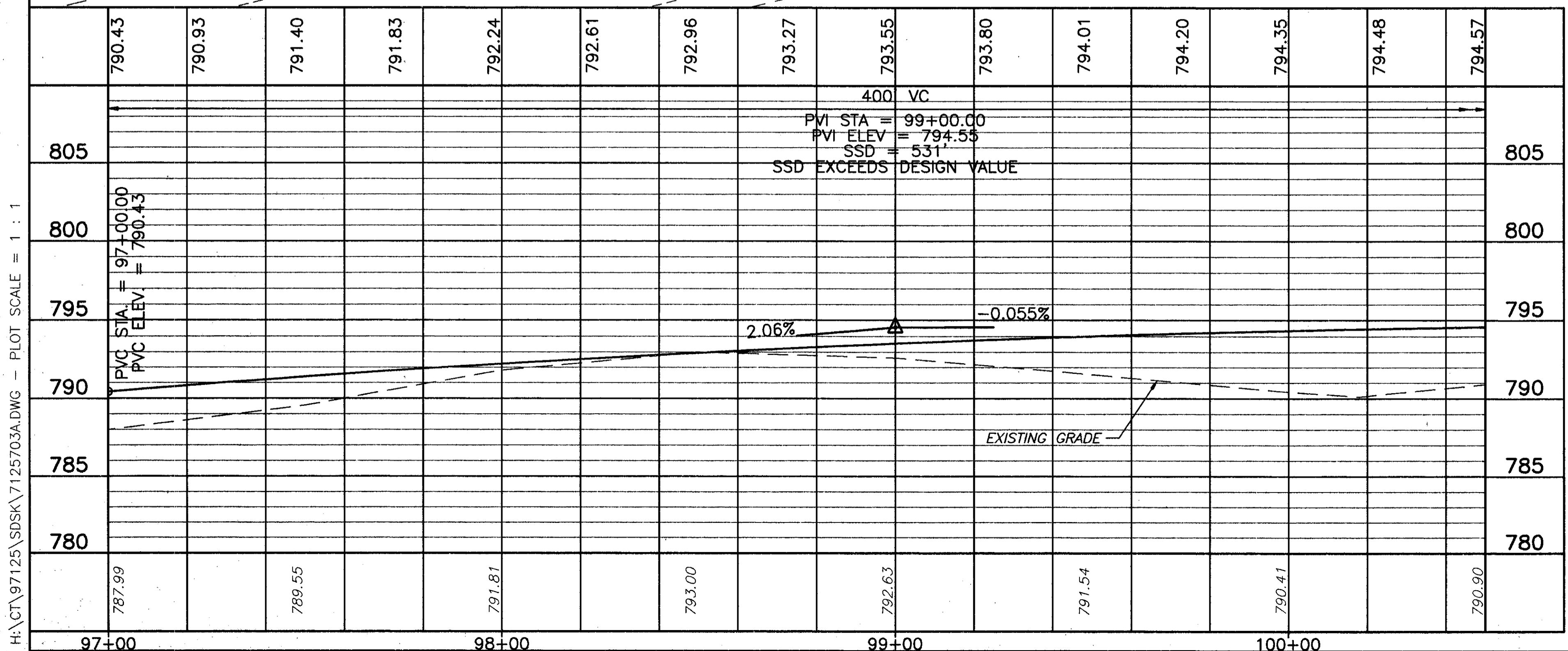

RAMP A
 RAMP A - PLAN AND PROFILE STA. 97+00 TO STA. 100+50

LAK-IR90/SR615-9.26/1.51
 171
 393