

H:\CT\97125\SDSK\7125702A.DWG - PLOT SCALE = 1 : 1

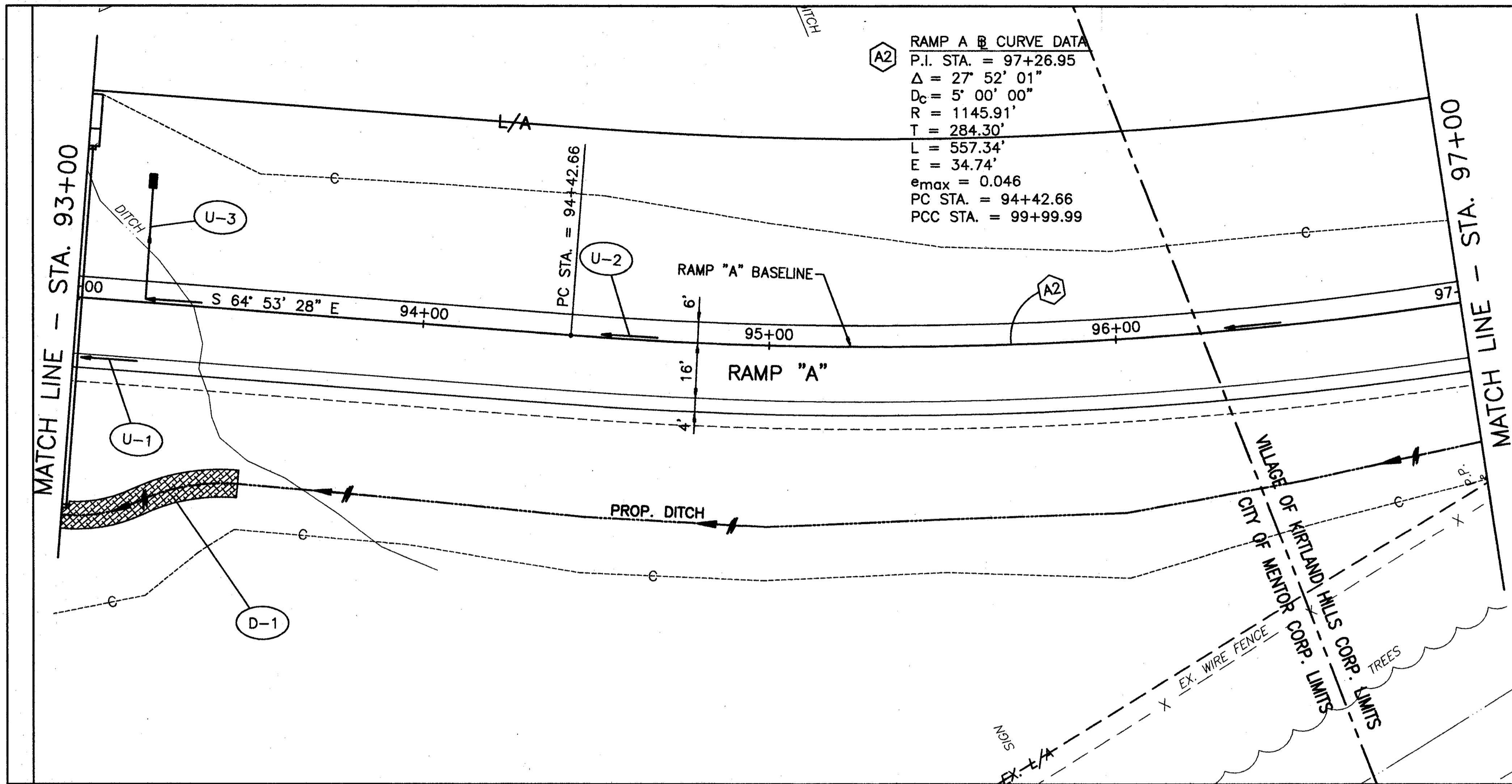

PROPOSED STRUCTURE DATA - STA. 93+00	
TYPE	= 30" CONDUIT, TYPE A, 706.02
DRAINAGE AREA	= 3.50 AC.
Q <sub>25</sub>	= 9.00 C.F.S.
Q <sub>100</sub>	= 11.00 C.F.S.
HW <sub>25</sub>	= 774.07
HW <sub>100</sub>	= 774.47
V <sub>25</sub>	= 9.05 F.P.S.
V <sub>100</sub>	= 9.56 F.P.S.

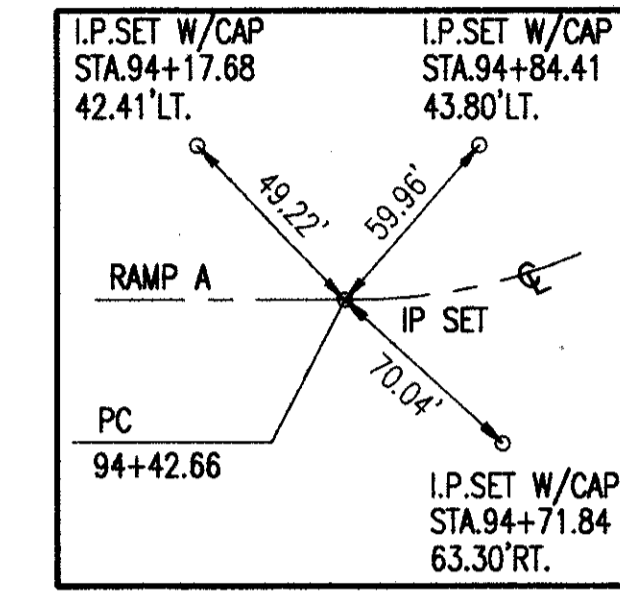

SWTIE#15

FOR TYPICAL SECTIONS, SEE SHEETS 5 THRU 15  
 FOR CROSS SECTIONS AND PIPE PROFILES, SEE SHEETS 175 THRU 185  
 FOR SUPERELEVATION TABLES, SEE SHEETS 246 THRU 254  
 FOR INTERSECTION DETAILS, SEE SHEETS 255 THRU 262  
 FOR SIGNING AND PAVEMENT MARKING PLAN, SEE SHEETS 311 THRU 312

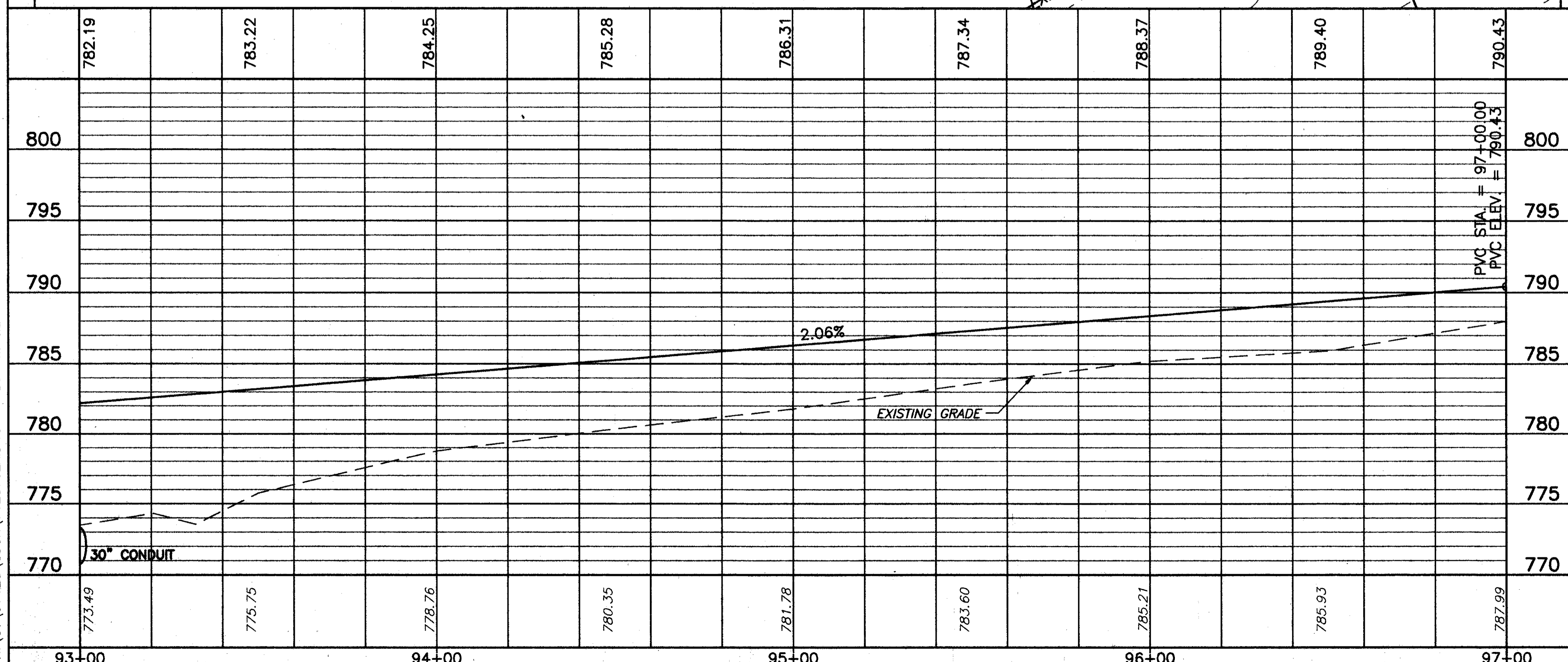

SODDING, STAKED (8' WIDE)

REF	LOCATION	SQ. YD.	TOTALS
D-1	STA. 93+00 TO STA. 93+50, RT.	45	45
SODDING, STAKED		660	660
TOTALS			

RAMP A - PLAN AND PROFILE STA. 93+00 TO STA. 97+00

LAK-IR90/SR615-9.26/1.51

170  
393

RAMP A - PLAN AND PROFILE STA. 93+00 TO STA. 97+00