

LAKE COUNTY  
LAK-1-6.97

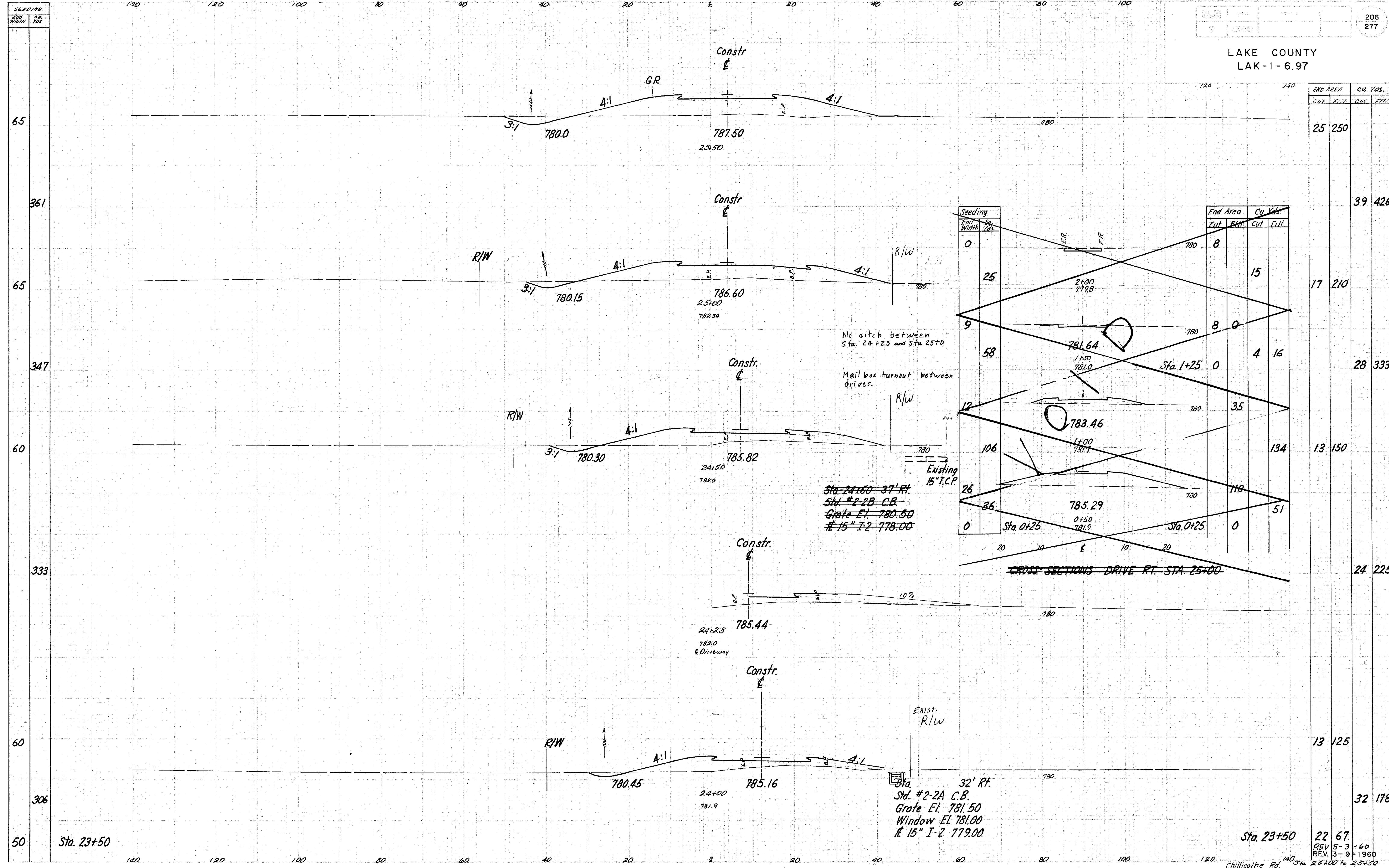

Seeding End Width Sq. Yds.	End Area		Cu. Yds.	
	Cut	Fill	Cut	Fill
0	8	0	0	0
25	0	15	0	0
9	8	0	4	16
58	0	35	0	0
12	35	0	0	0
106	0	134	0	0
26	110	0	0	0
36	0	51	0	0
0	0	0	0	0

END AREA	CU. YDS.	
	Cut	Fill
25	250	0
17	210	0
28	333	0
13	150	0
24	225	0
13	125	0
32	178	0
22	67	0

No ditch between Sta. 24+23 and Sta. 25+00  
Mail box turnout between drives.

Sta. 24+60 37' RT.  
Sta. #2-2B C.B.  
Grate E.I. 780.50  
# 15" I-2 178.00

Sta. 32' RT.  
Sta. #2-2A C.B.  
Grate E.I. 781.50  
Window E.I. 781.00  
# 15" I-2 179.00

CROSS SECTIONS DRIVE RT. STA. 25+00