

280 260 240 220 200 180 160 140 120 100 80 60 40

176
277

LAKE COUNTY
LAK-1-6.97

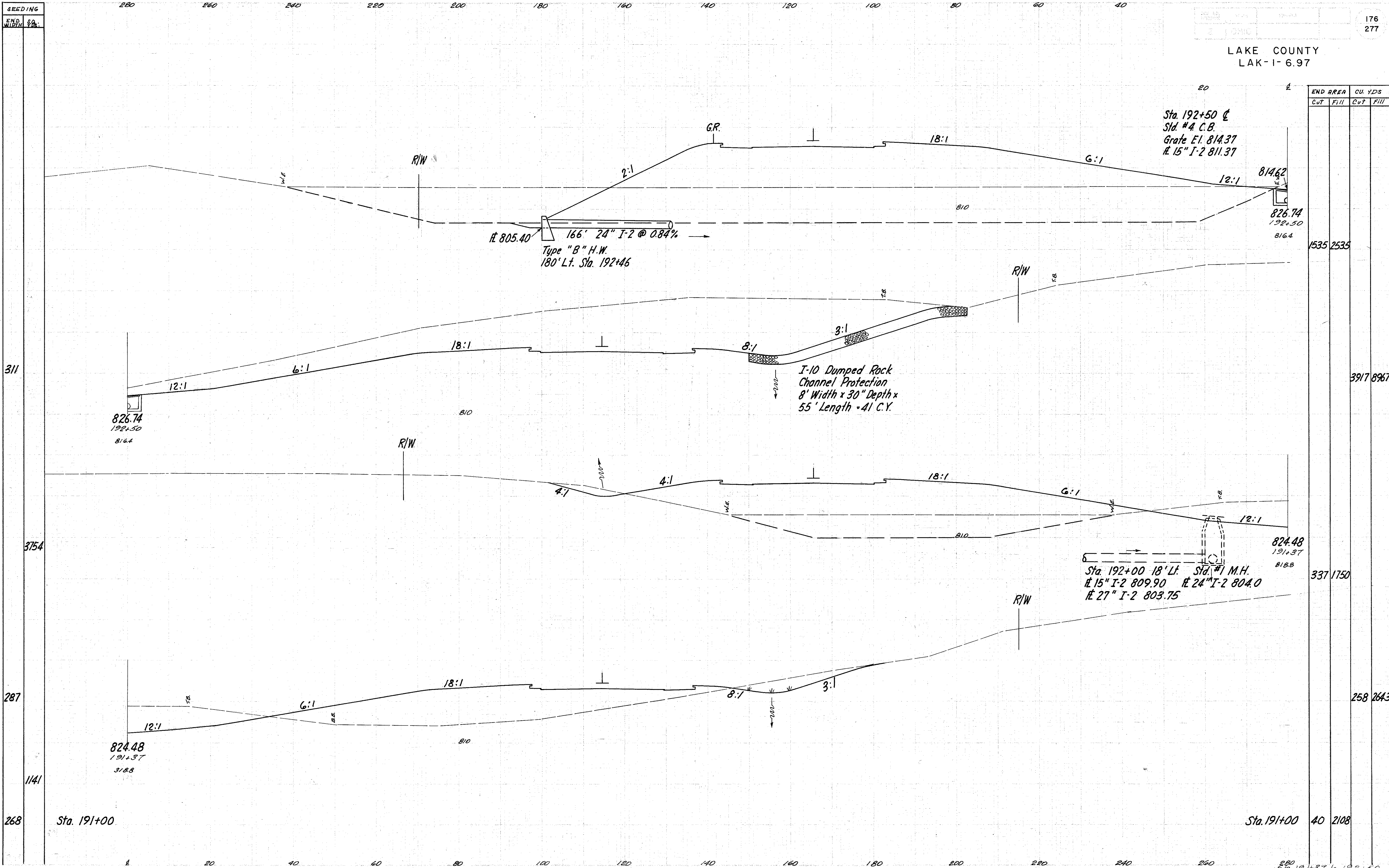

Sta. 192+50
Std. #4 C.B.
Grate E1. 814.37
E 15" I-2 811.37

805.40
166' 24" I-2 @ 0.84%
Type "B" H.W.
180' Lt. Sta. 192+46

I-10 Dumped Rock
Channel Protection
8' Width x 30" Depth x
55' Length - 41 C.Y.

Sta. 192+00 18' Lt. Sta. #1 M.H.
E 15" I-2 809.90 E 24" I-2 804.0
E 27" I-2 803.75

END AREA		CU. YDS	
Cut	Fill	Cut	Fill

1535	2535		
		3917	8967
		337	1750
		258	2643
		40	2108

Sta. 191+37 to 192+50