

SEEDING 280 260 240 220 200 180 160 140 120 100 80 60 40

80  
277

LAKE COUNTY  
LAK-1-697

259  
3194  
316  
3689  
348

EAD AREA		CU. YDS.	
CUT	FILL	CUT	FILL
		1323	
		8120	
		3062	
		13172	
		4051	

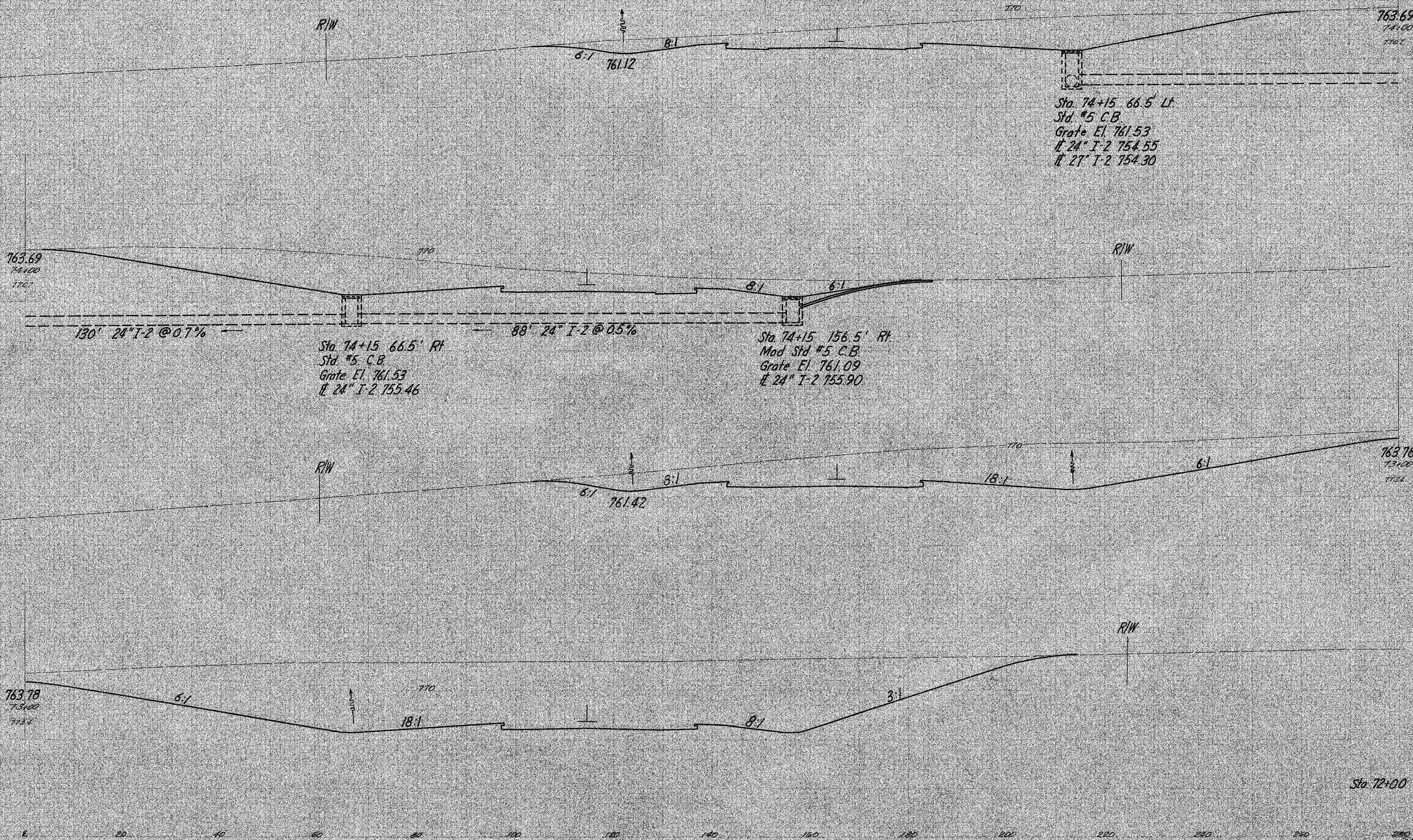

763.69  
741.00  
776.1

Sta. 74+15 66.5' Lt.  
Std #5 C.B.  
Grate El. 761.53  
# 24" I-2 754.55  
# 27" I-2 754.30

763.69  
741.00  
776.1

130' 24" I-2 @ 0.1%

Sta. 74+15 66.5' Rt.  
Std #5 C.B.  
Grate El. 761.53  
# 24" I-2 755.46

88' 24" I-2 @ 0.5%

Sta. 74+15 156.5' Rt.  
Mod Std #5 C.B.  
Grate El. 761.09  
# 24" I-2 755.90

763.78  
731.00  
775.4

3062

Sta. 72+00

4051

763.78  
731.00  
775.4

Sta. 72+00

0 20 40 60 80 100 120 140 160 180 200 220 240 260 280

280 260 240 220 200 180 160 140 120 100 80 60 40 20 0