

LAKE COUNTY
LAK-1-6.97

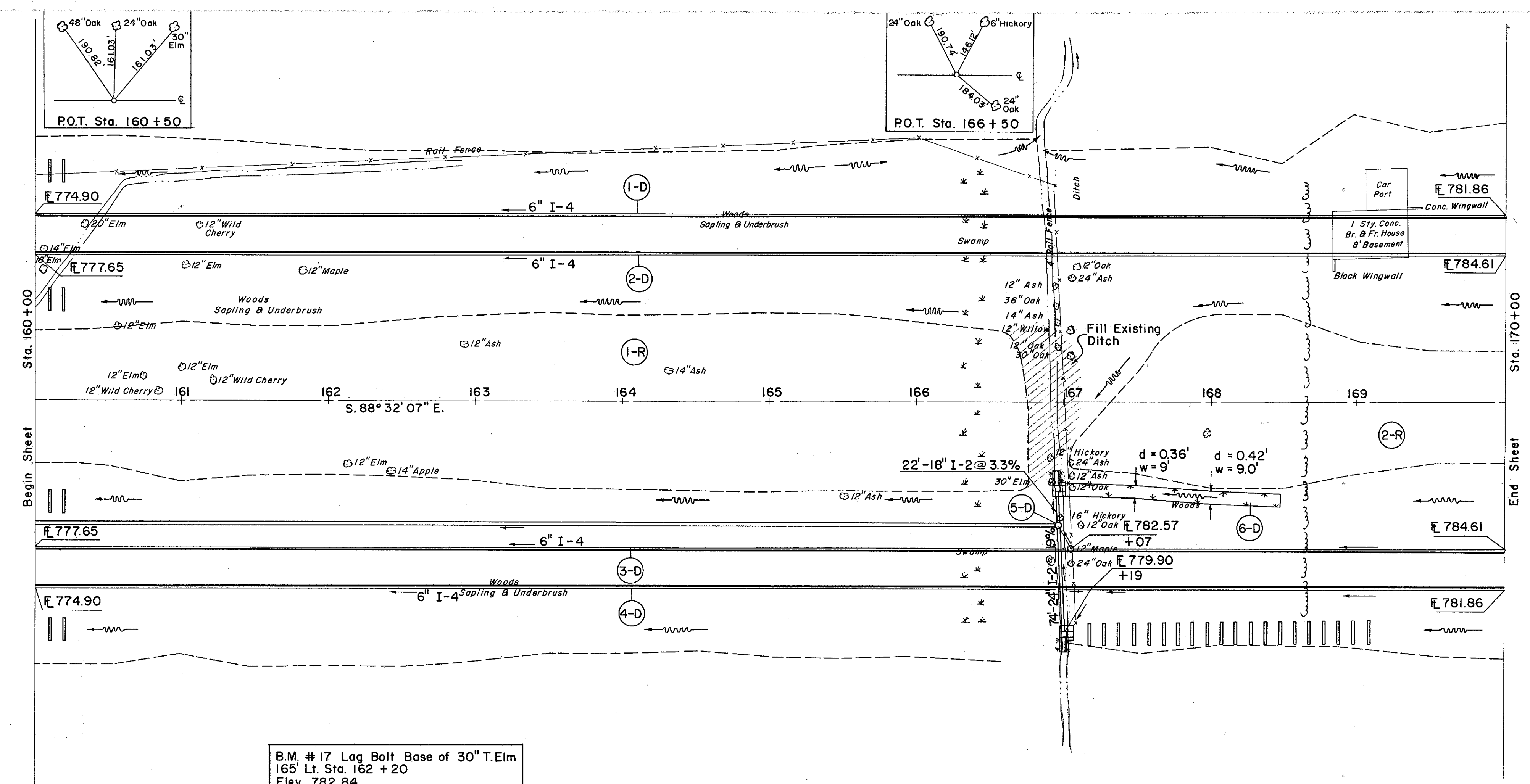

B.M. # 17 Lag Bolt Base of 30" T. Elm
165' Lt. Sta. 162 + 20
Elev. 782.84

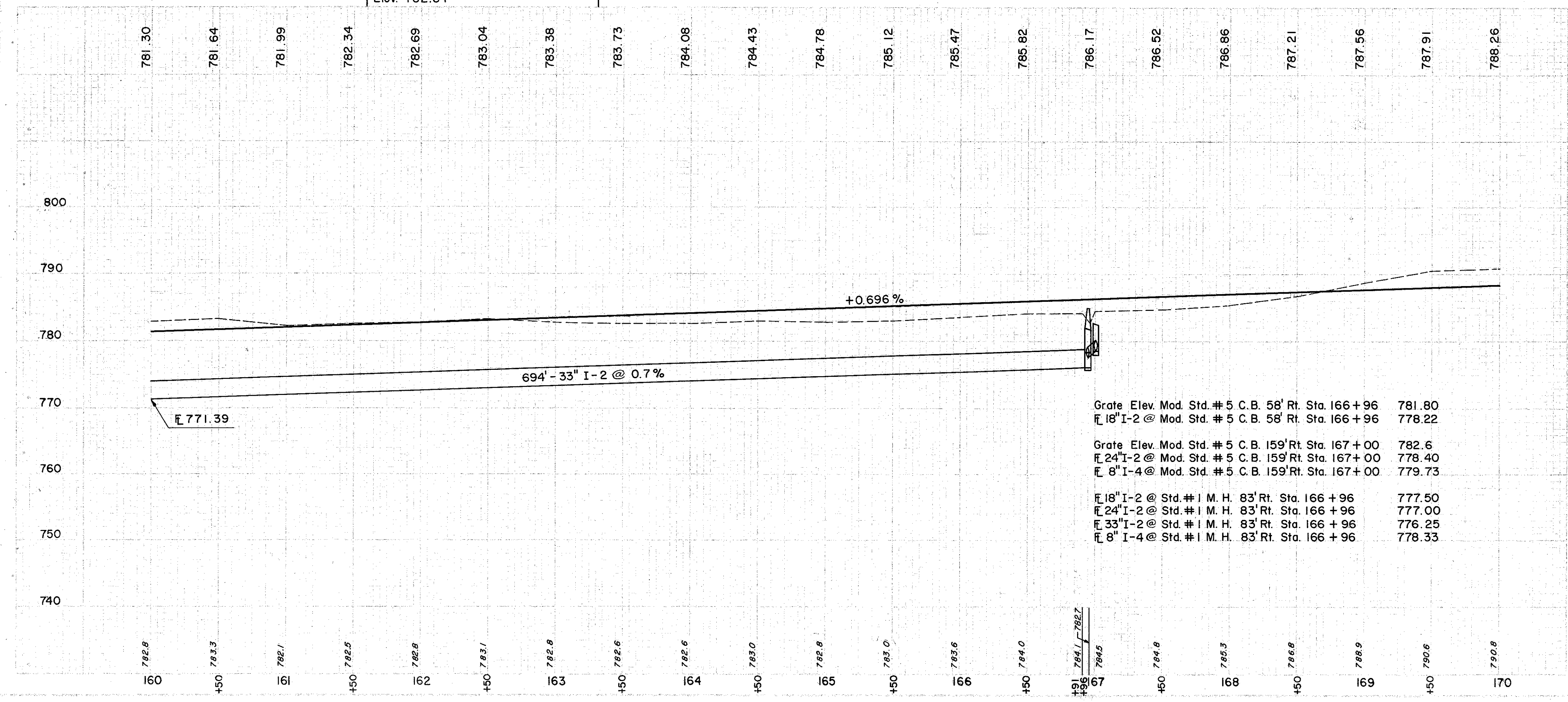

Grate Elev. Mod. Std. # 5	C. B. 58' Rt. Sta. 166 + 96	781.80
16" I-2 @ Mod. Std. # 5	C. B. 58' Rt. Sta. 166 + 96	778.22
Grate Elev. Mod. Std. # 5	C. B. 159' Rt. Sta. 167 + 00	782.6
24" I-2 @ Mod. Std. # 5	C. B. 159' Rt. Sta. 167 + 00	778.40
6" I-4 @ Mod. Std. # 5	C. B. 159' Rt. Sta. 167 + 00	779.73
16" I-2 @ Std. # 1 M. H.	83' Rt. Sta. 166 + 96	777.50
24" I-2 @ Std. # 1 M. H.	83' Rt. Sta. 166 + 96	777.00
33" I-2 @ Std. # 1 M. H.	83' Rt. Sta. 166 + 96	776.25
8" I-4 @ Std. # 1 M. H.	83' Rt. Sta. 166 + 96	778.33

(D) DRAINAGE

REF. NO.	STATION	FROM	TO	L.F.	SHALLOW DEEP	M-6.4(a)	OUTLET PIPE	6" 60° BEND	6" 60° WYE	MOD. STD. # 5 CATCH BASIN	STD. # 1 SODDING MANHOLE	L-10
I-D	160+00	170+00	LT.	1000	1000		10					
2-D	160+00	170+00	LT.	1001	1017		10					
3-D	160+00	170+00	RT.	74	22	694				2	1	53
4-D	160+00	170+00	RT.									
5-D	160+00	166+96	RT.									
6-D	166+96	168+50	RT.									150

(R) ROADWAY

REF. NO.	STATION	L-6	SIDE ROADSIDE	CLEANUP	UNITS	TOTAL
I-R	160 + 00	166 + 75	€	75		
2-R	167 + 30	170 + 00	€	26		
						101

EXCAVATION	=	10,152 C.Y.
EMBANKMENT	=	2,031 C.Y.
EMBANKMENT - 18"	=	2,397 C.Y.