

NOTE: A quantity of paving material has been provided for the repair of Baldwin Road surface disturbed by placing the pipe culvert, 2" T-35 on 5" B-19.

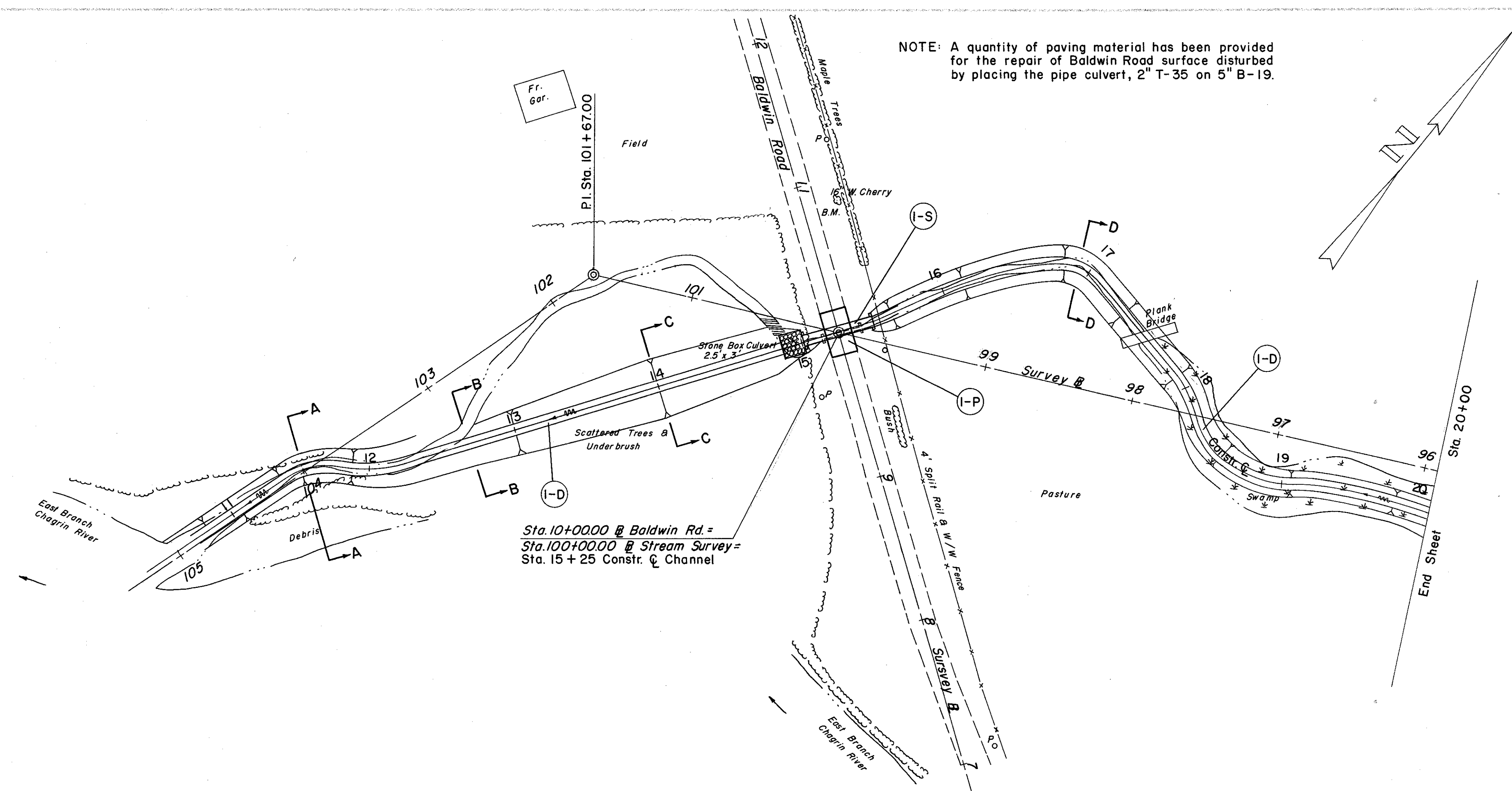

(S) STRUCTURE

REF. NO.	STATION	S I D E	S-27 PIPE FOR ROADWAY CULVERTS SEC. M- 206.6(b) 83" X 53"	S-1 CONC. FOR STRUCT. CL."E"	E-2 EXC. FOR STRUCT.	I-10 DUMPED ROCK CHANNEL PROTECT.
FROM TO		L.F.		C.Y.		
I-S	10+00 Baldwin Rd.		48	5.9	30	22

(P) PAVEMENT

REF. NO.	STATION	S I D E	T-35 ASPHALTIC CONCRETE SURFACE COURSE	B-19 AGGR. BASE COURSE
FROM TO		C.Y.		
I-P	9+85 10+15	3	8	

(D) DRAINAGE

REF. NO.	STATION	S I D E	E-3 CHANNEL EXC.
FROM TO		C.Y.	
I-D	10+30 20+00		1680

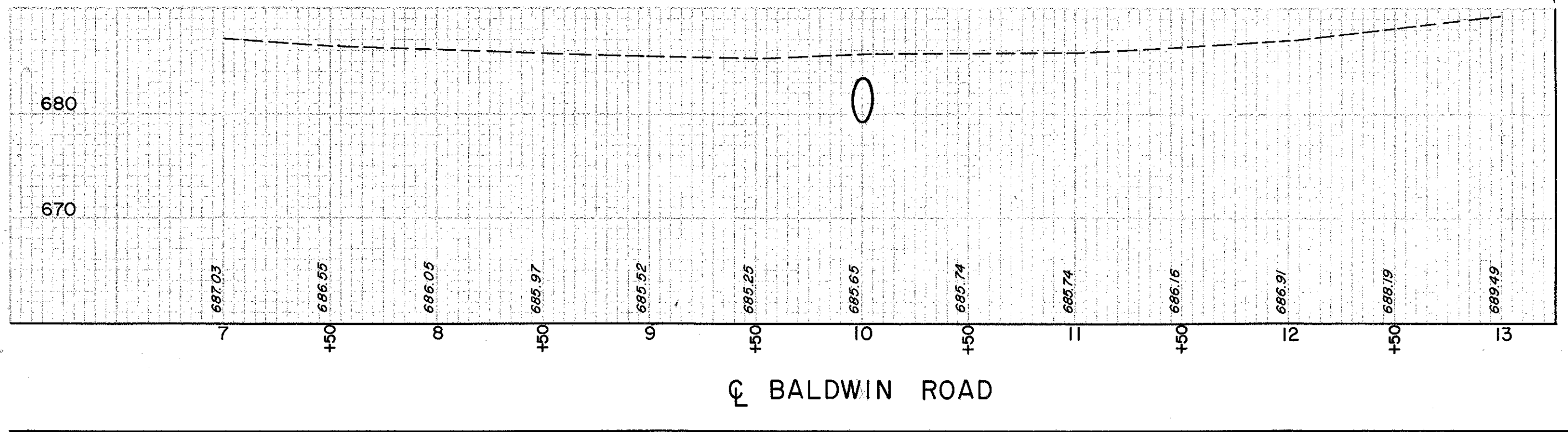

B.M. - R.R. Spike in 16" W. Cherry Tree  
24' Rt. Baldwin Rd. Sta. 10 + 85  
Elev. 687.45

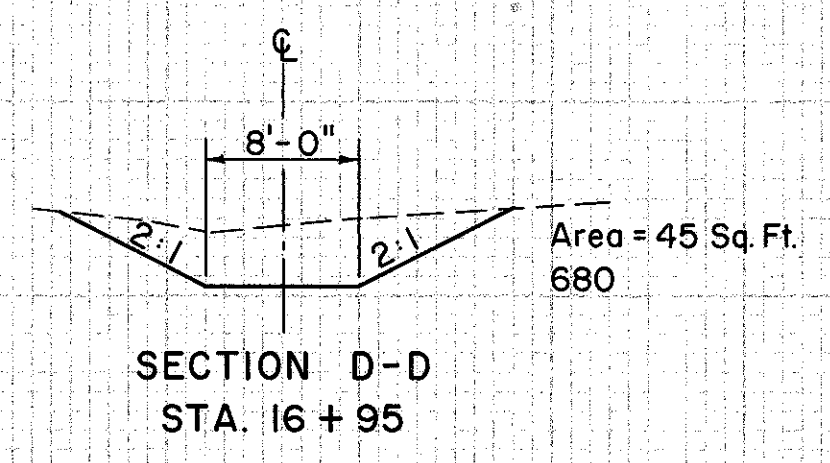

HEADWATER = 5.40 FT.  
OUTLET VELOCITY = 11.4 F.P.S.

AREA = 330 ACRES  
Q<sub>10</sub> = 206 C.F.S.

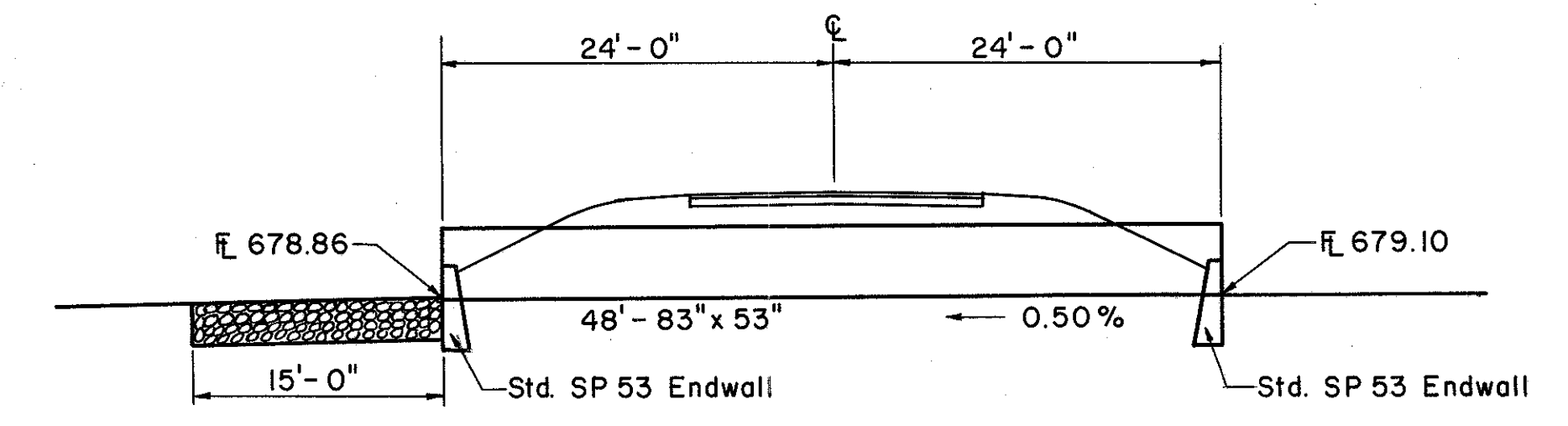
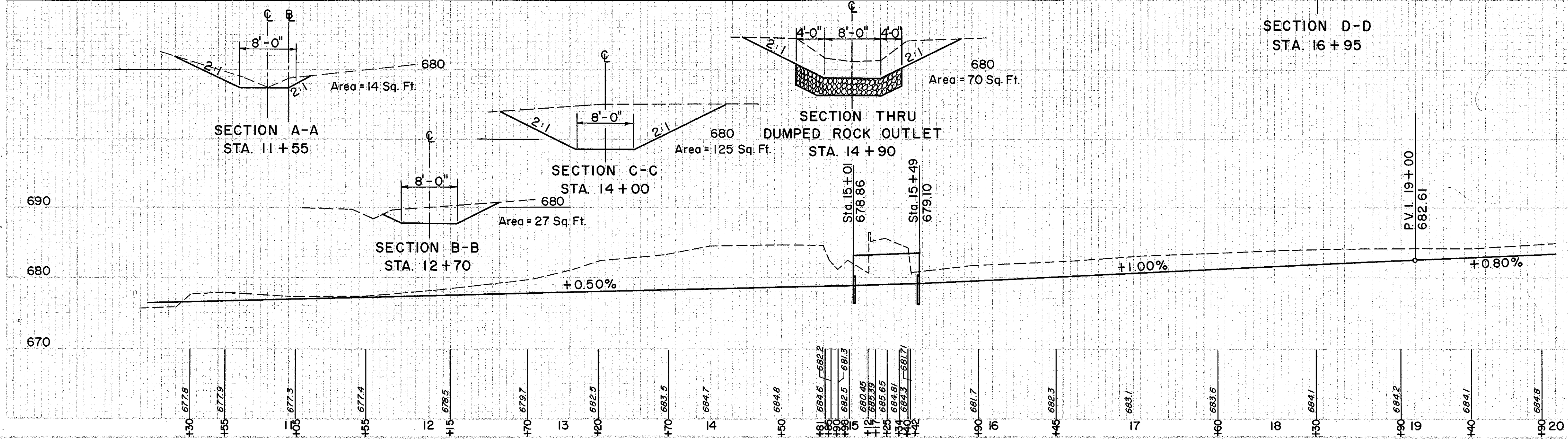

CULVERT DATA  
TYPE: Pipe Culvert S-27 Sec. M-206.6 (b)  
SIZE: 83" x 53" x 48"  
WORK REQUIRED: Build a pipe culvert with SP 53 Endwalls Lt & Rt.

DETAILS OF PIPE CULVERT  
STA. 10 + 00 BALDWIN RD.

PIPE CULVERT AT BALDWIN RD. & DRAINAGE CHANNEL FROM RT. STA. 126 + 00 ±  
S.R. 1 TO EAST BRANCH CHAGRIN RIVER STA. 10 + 30 TO STA. 20 + 00