

**SOIL PROFILE**  
**LAKE COUNTY**  
**LAK-1-6.97**  
**STATE HIGHWAY TESTING AND RESEARCH LABORATORY**  
 O. S. U. CAMPUS, COLUMBUS, OHIO

6  
9

Revised July 31, 1959  
 Revised Oct. 6, 1959

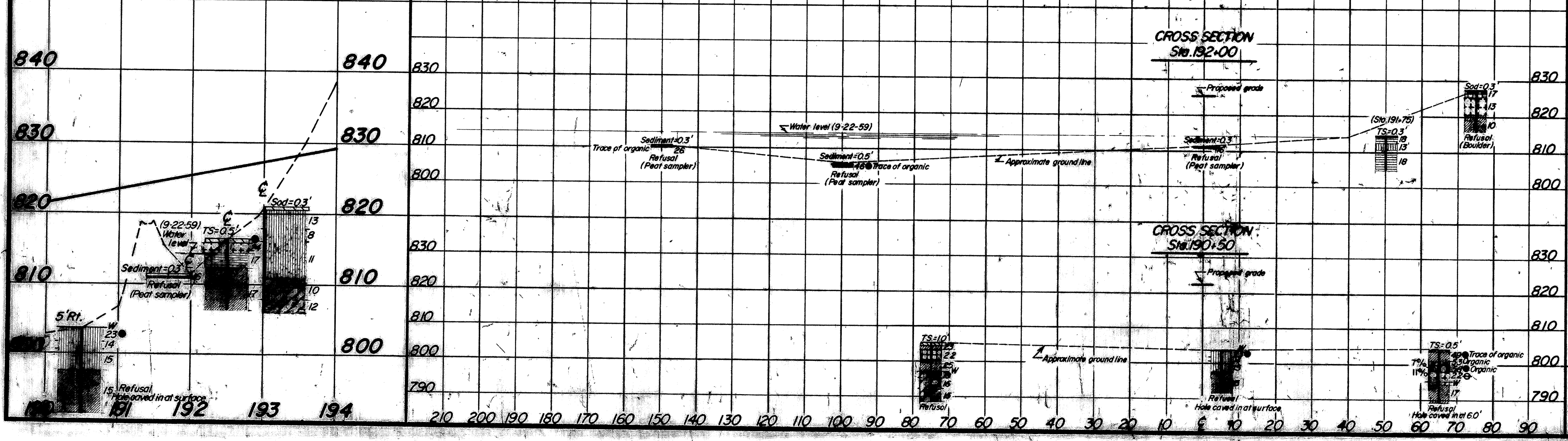
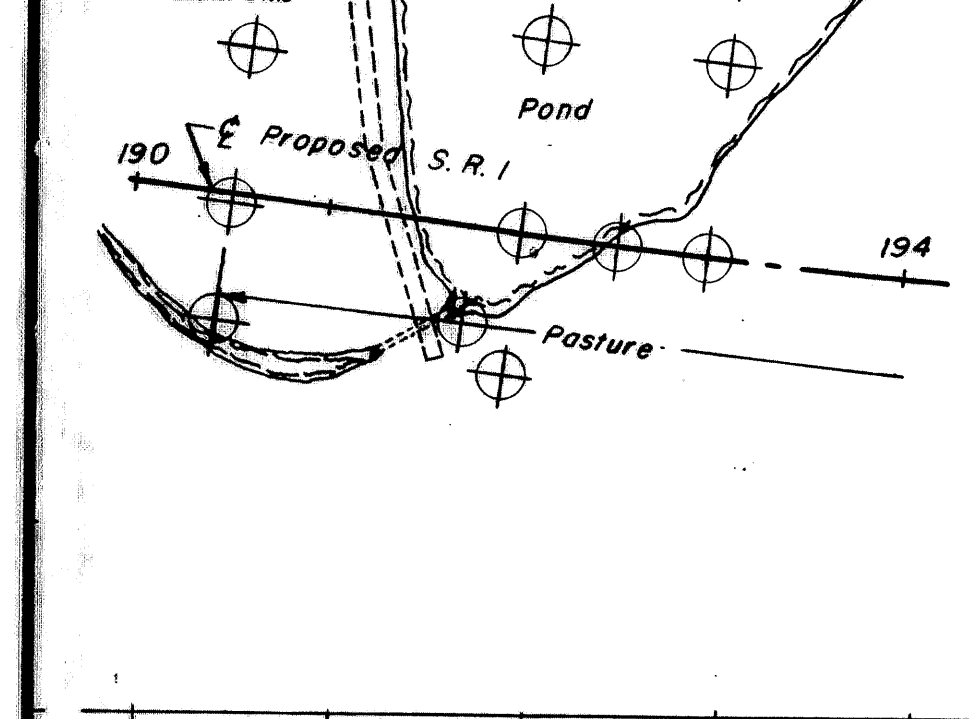
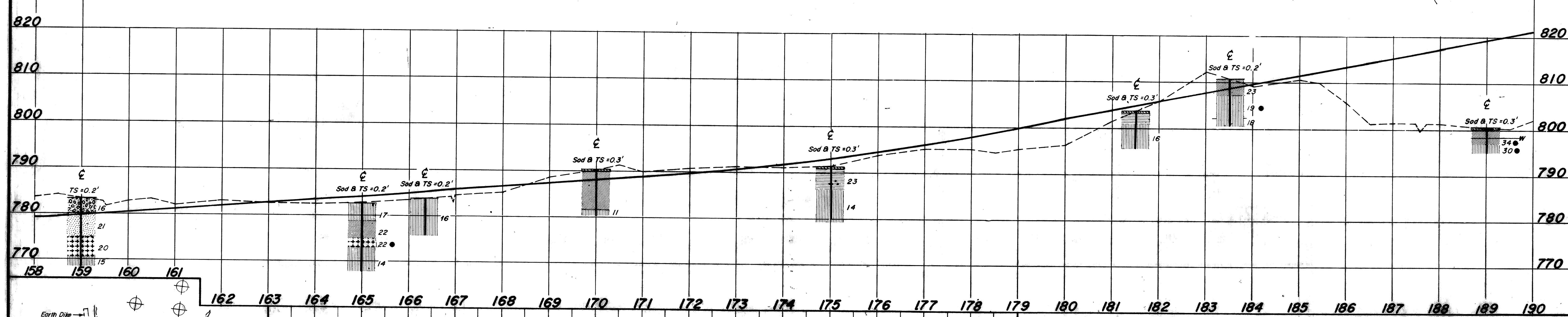
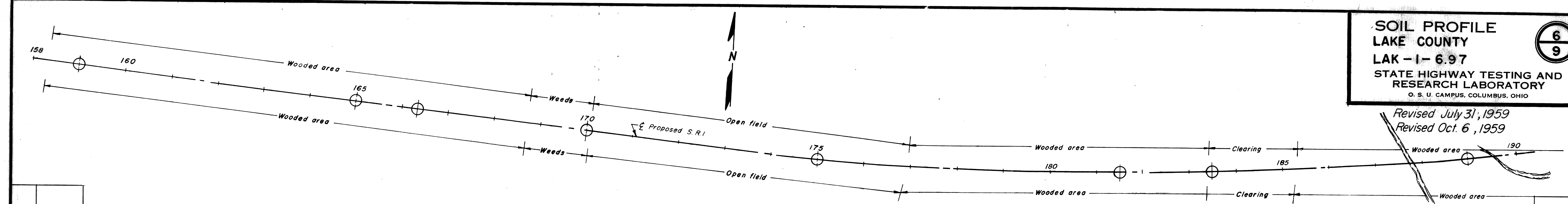

**SUPPLEMENTARY SOIL TEST DATA**  
 NOTE: NP shown in Liquid Limit and Plasticity Index columns indicates that the material is non-plastic.

STATION & OFFSET	DEPTH	W.C.	L.L.	P.I.	SILT	CLAY	L.L.	P.I.	CLASS.	SH/L
190+50 75' Lt.	1'-2.0'	8	5	15	34	37	27	11	23	A-5a
	2'-5.0'	4	7	3	36	55	42	17	22	A-7-5
	5'-10.0'	0	1	4	32	43	37	17	25	A-5a
	10.0-15.0'								16	Visual
190+50 5' Rt.	0'-2.0'	5	3	18	43	51	24	7	23	A-4a
	2'-5.0'	1	5	30	37	18	16	NP	14	A-4a
	3'-8.0'	23	19	15	24	18	21	5	15	A-4a
	5'-12.0'	33	1	1	33	32	31	11	15	A-5a
190+50 65' Rt.	0.5-3.0'	4	8	15	36	35	31	11	40	A-5a
	3.0-5.0'	0	3	8	46	43	63	26	53	A-7-5
	5.0-7.0'	8	13	41	23	15	40	18	58	A-7-5
	7.0-10.0'	0	3	15	59	23	NP	NP	22	A-4a
191+75 50' Rt.	0.3-2.0'	1	3	2	38	56	38	15	18	A-5b
	2'-4.0'	38	12	4	20	26	28	7	13	A-4a
	4'-10.0'	9	5	4	33	40	38	15	18	A-5b
192+00 150' Lt.	0.3-0.5'								26	Visual
192+00 100' Lt.	0.5-0.8'	0	3	10	77	10	28	8	46	A-4b
192+00 CL	0.3-0.5'								16	Visual
192+00 75' Rt.	0.3-2.0'	0	1	1	36	62	42	20	17	A-7-5
	2.0-7.0'	0	2	3	50	45	33	9	13	A-4b
	7.0-11.5'	13	2	3	48	34	32	13	10	A-5a
192+50 CL	16.5-2.0'	0	1	6	50	43	27	2	24	A-4b
	2.0-4.0'	0	1	3	34	62	38	15	17	A-5b
	4.0-10.0'	0	4	3	43	50	34	11	17	A-5a
193+00 200' Lt.	0.3-0.5'								30	Visual
193+00 CL	0.3-3.0'	9	13	21	27	30	20	0	13	A-4a
	3.0-5.0'	27	11	12	30	20	24	0	13	A-7a
	5.0-10.0'	15	17	5	34	27	20	8	11	A-4a
	10.0-13.0'								10	Visual
	13.0-15.0'								12	Visual