

FENCE LAYOUT

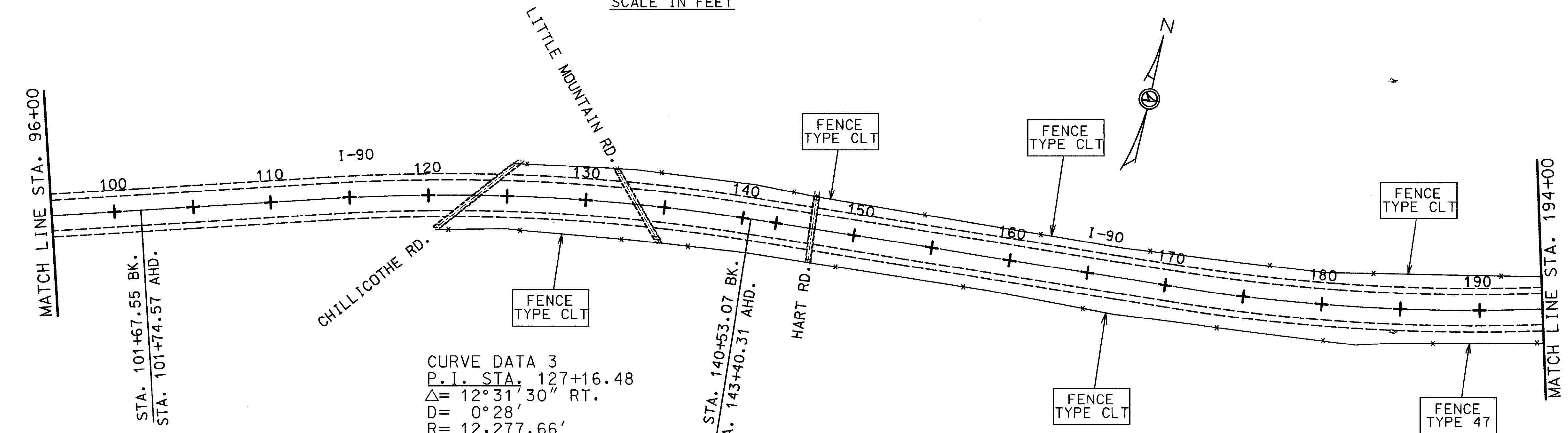
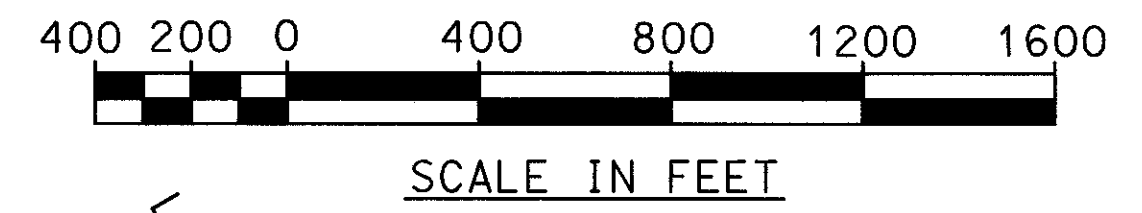

CURVE DATA 3
P.I. STA. 127+16.48
 $\Delta = 12^\circ 31' 30''$ RT.
D = $0^\circ 28'$
R = 12,277.66'
T = 1347.33'
L = 2683.92'
E = 73.70'
P.C. STA. 113+69.15
P.T. STA. 140+53.07
NORMAL CROWN

STA. = 308+41.00 TO 375+00.00 (BACK) = 6659.00 LIN. FT.
= 10+99.63 (AHEAD) TO 101+67.55 (BACK) = 9067.92 LIN. FT.
= 101+74.57 (AHEAD) TO 140+53.07 (BACK) = 3878.50 LIN. FT.
= 143+40.31 (AHEAD) TO 241+39.02 (BACK) = 9798.71 LIN. FT.
= 242+80.20 (AHEAD) TO 280+89.00 = 3808.80 LIN. FT.

LENGTH OF PROJECT = 33,212.93 LIN. FT.
OR 6.290 MILES

PARTICIPATION	FENCE QUANTITIES	
	FENCE REMOVED	FENCE TYPE CLT
I	32,292	32,292
II		

QUANTITIES CARRIED TO GENERAL SUMMARY

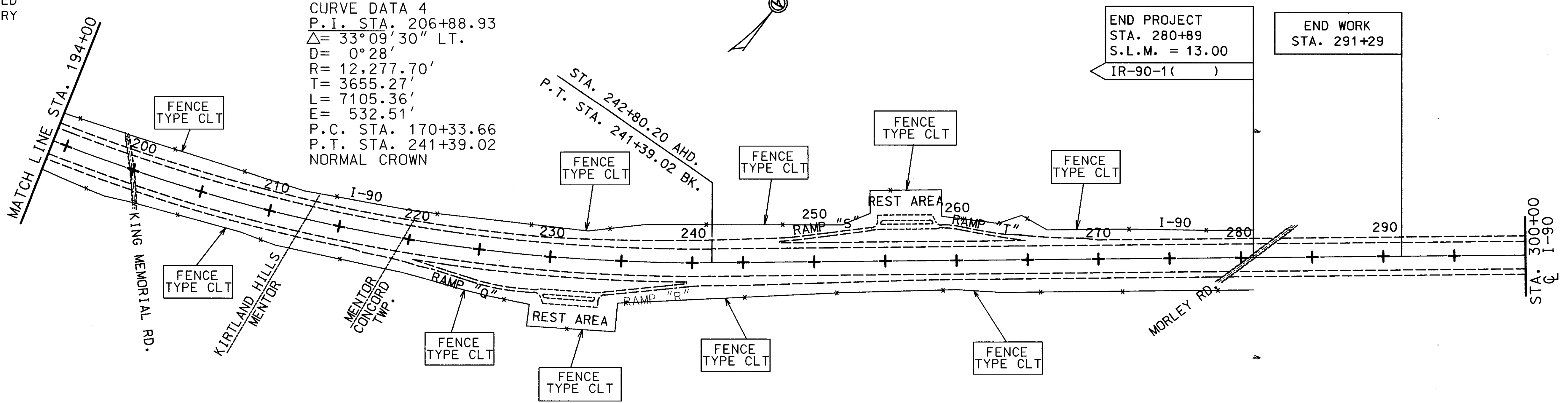

CURVE DATA 4
P.I. STA. 206+88.93
 $\Delta = 33^\circ 09' 30''$ LT.
D = $0^\circ 28'$
R = 12,277.70'
T = 3655.27'
L = 7105.36'
E = 532.51'
P.C. STA. 170+33.66
P.T. STA. 241+39.02
NORMAL CROWN