

TRAFFIC MAINTENANCE

LAKE COUNTY
LAK-90-6.71

OHIO
FHWA
REGION 5

158
182

SCHEDULE OF THRU LANES TO BE MAINTAINED *

APPROXIMATE STATION LIMITS	BASIC ROADWAY TYPICAL SECTION	NUMBER OF THRU LANES TO BE MAINTAINED DURING PAVEMENT WORK	NUMBER OF THRU LANES TO BE MAINTAINED DURING REMOVAL & RESURFACING
MAINLINE			
STA. 308+41 TO STA. 375+00 WB = STA. 10+99.63 STA. 308+41 TO STA. 375+00 EB = STA. 10+99.63	3 LANES EACH DIRECTION	2 LANES EACH DIRECTION	2 LANES EACH DIRECTION
STA. 10+99.63 TO STA. 86+00 WB STA. 10+99.63 TO STA. 101+67.55 EB = STA. 101+74.57 STA. 101+74.57 TO STA. 131+00 EB	3 LANES EACH DIRECTION	2 LANES EACH DIRECTION	2 LANES EACH DIRECTION
STA. 86+00 TO STA. 101+67.55 WB = STA. 101+74.57 STA. 86+00 TO STA. 101+67.55 WB = STA. 101+74.57 STA. 131+00 TO STA. 140+53.07 EB = STA. 143+40.31	2 LANES EACH DIRECTION	2 LANES EACH DIRECTION	2 LANES EACH DIRECTION
STA. 101+74.57 TO STA. 140+53.07 WB STA. 143+40.31 TO STA. 241+39.02 EB & WB STA. 242+80.20 TO STA. 280+89 EB & WB	2 LANES EACH DIRECTION	2 LANES EACH DIRECTION	2 LANES EACH DIRECTION
RAMP L	1 LANE		1 LANE USING SHOULDER
RAMP M	1 LANE		1 LANE USING SHOULDER
RAMP N	1-3 LANES		1-2 LANES USING SHOULDER
RAMP P	1 LANE		1 LANE USING SHOULDER
BRIDGES			
S.R. 306 - REYNOLDS RD.	4 LANES - TWO LANES EACH DIRECTION		2 LANES EACH DIRECTION
CHILLICOTHE RD.	1 LANE EACH DIRECTION		1 LANE EACH DIRECTION USING FLAGGERS
LITTLE MOUNTAIN RD.	1 LANE EACH DIRECTION		1 LANE EACH DIRECTION USING FLAGGERS
KIRTLAND RD.	1 LANE EACH DIRECTION		1 LANE EACH DIRECTION USING FLAGGERS
KING MEMORIAL	1 LANE EACH DIRECTION		1 LANE EACH DIRECTION USING FLAGGERS

* DURING THE SET UP AND TAKE DOWN OF TRAFFIC CONTROL ZONES A MINIMUM OF 2 THRU LANES SHALL BE MAINTAINED ON THE 3 LANE SECTIONS.

TRAFFIC WORK TIME LIMITATIONS:

WESTBOUND I-90

MAINTAIN TWO (2) LANES OF TRAFFIC FROM 6:00 AM TO 10:00 AM (4 HRS.)
MAINTAIN ONE (1) LANE OF TRAFFIC FROM 10:00 AM TO 6:00 AM (20 HRS.)

EASTBOUND I-90

MAINTAIN TWO (2) LANES OF TRAFFIC FROM 3:00 PM TO 7:00 PM (4 HRS.)
MAINTAIN ONE (1) LANE OF TRAFFIC FROM 7:00 PM TO 3:00 PM (20 HRS.)

LIQUIDATED DAMAGES

FIRST HOUR \$60.00 PER MINUTE
SECOND AND ADDITIONAL HOURS \$200.00 PER MINUTE

WEEKENDS

E.B. MAINTAIN ONE (1) LANE OF TRAFFIC FROM 7:00 PM FRIDAY TO 3:00 PM MONDAY
W.B. MAINTAIN ONE (1) LANE OF TRAFFIC FROM 10:00 AM FRIDAY TO 6:00 AM MONDAY

NOTE: LANES ONLY TO BE CLOSED IF WORK IS SCHEDULED FOR THAT TIME PERIOD.

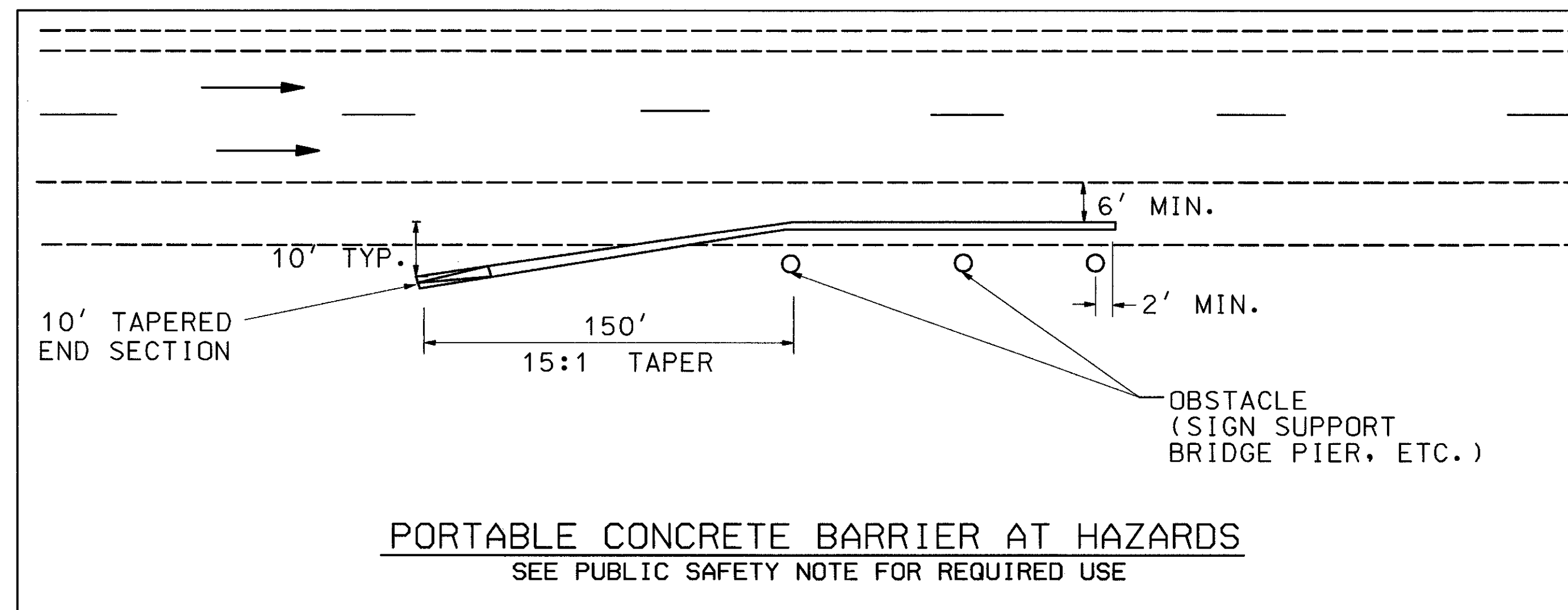

ADVANCE WARNING SIGNS

	DISTANCE *	SIGN	SIZE	DISCUSSION		
LEFT LANE CLOSED	500'	OW-60D	48"X48"	WIDTH TRANSITION (SYMBOLIC)	DUAL SIGN INSTALLATION	
	1000'	OW-143	24"X24"	35 MPH		
		OW-123 MOD	48"X48"	LEFT LANE CLOSED 1000 FT.		
	2000'	OW-123 MOD	48"X48"	LEFT LANE CLOSED 2000 FT.		
	3000'	OW-134	48"X48"	ROAD WORK AHEAD		
5200'	OW-134	48"X48"	ROAD WORK AHEAD			
RIGHT LANE CLOSED	500'	OW-60C	48"X48"	WIDTH TRANSITION (SYMBOLIC)		
	1000'	OW-143	24"X24"	35 MPH		
		OW-122 MOD	48"X48"	RIGHT LANE CLOSED 1000 FT.		
	2000'	OW-122 MOD	48"X48"	RIGHT LANE CLOSED 2000 FT.		
	3000'	OW-134	48"X48"	ROAD WORK AHEAD		
5200'	OW-134	48"X48"	ROAD WORK AHEAD			
LANE SHIFT (ADVANCE)	500'	OW-5.5A OR 5B	48"X48"	LANE SHIFT (SYMBOLIC)	DUAL SIGN INSTALLATION	
		OW-143	24"X24"	35 MPH		
	1000'	OC-53	36"X36"	MAINTAIN PRESENT LANE		
		OC-49R	48"X48"	RIGHT LANE MUST USE SHOULDER		
	2000'	OW-145A	30"X16"	2000 FT.		
3000'	OC-59AL	48"X48"	ALL TRUCKS LEFT 2 LANES			
LANE SHIFT (THRU)	500'	OC-49R	48"X48"	RIGHT LANE MUST USE SHOULDER		SINGLE
	1500' c/c	OC-49R	48"X48"	RIGHT LANE MUST USE SHOULDER		
LANE SHIFT (END)	0'	OC-6.6A OR 6B	48"X48"	LANE SHIFT (SYMBOLIC)		DUAL
		OC-143	24"X24"	35 MPH		
EXIT RAMP ACROSS CLSD LANE	GORE	OW-SPEC	48"X48"	EXIT RAMP	SINGLE INSTALLATION	
	500'	OW-SPEC	48"X48"	EXIT RAMP 500 FT.		
	1000'	OW-SPEC	48"X48"	EXIT RAMP 1000 FT.		
EXIT ONLY LANE	500'	OW-SPEC	48"X48"	RIGHT LANE MUST EXIT	SINGLE	
	1000'	OW-SPEC	48"X48"	RIGHT LANE MUST EXIT		
	2000'	OW-SPEC	48"X48"	RIGHT LANE MUST EXIT		

* DISTANCES ARE MEASURED FROM BEGINNING OF LANE CLOSURE, LANE SHIFT OR PAINTED GORE.

EXTRA ADVANCE WARNING SIGN GROUPS AS PER STANDARD DRAWING MT-95.30 SHALL BE INSTALLED WHEN DIRECTED BY THE ENGINEER.

SEE STANDARD DRAWING MT-98.15 FOR ENTRANCE RAMPS APPROACHING A CLOSED LANE.