

TRAFFIC CONTROL

LAKE COUNTY
LAK-90-6.71

OHIO
FHWA
REGION 5

134
182

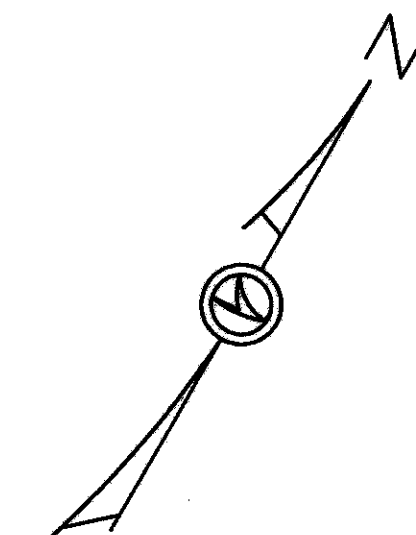

BEGIN WORK
STA. 248+10

MATCH LINE STA. 293+00

MATCH LINE STA. 308+00

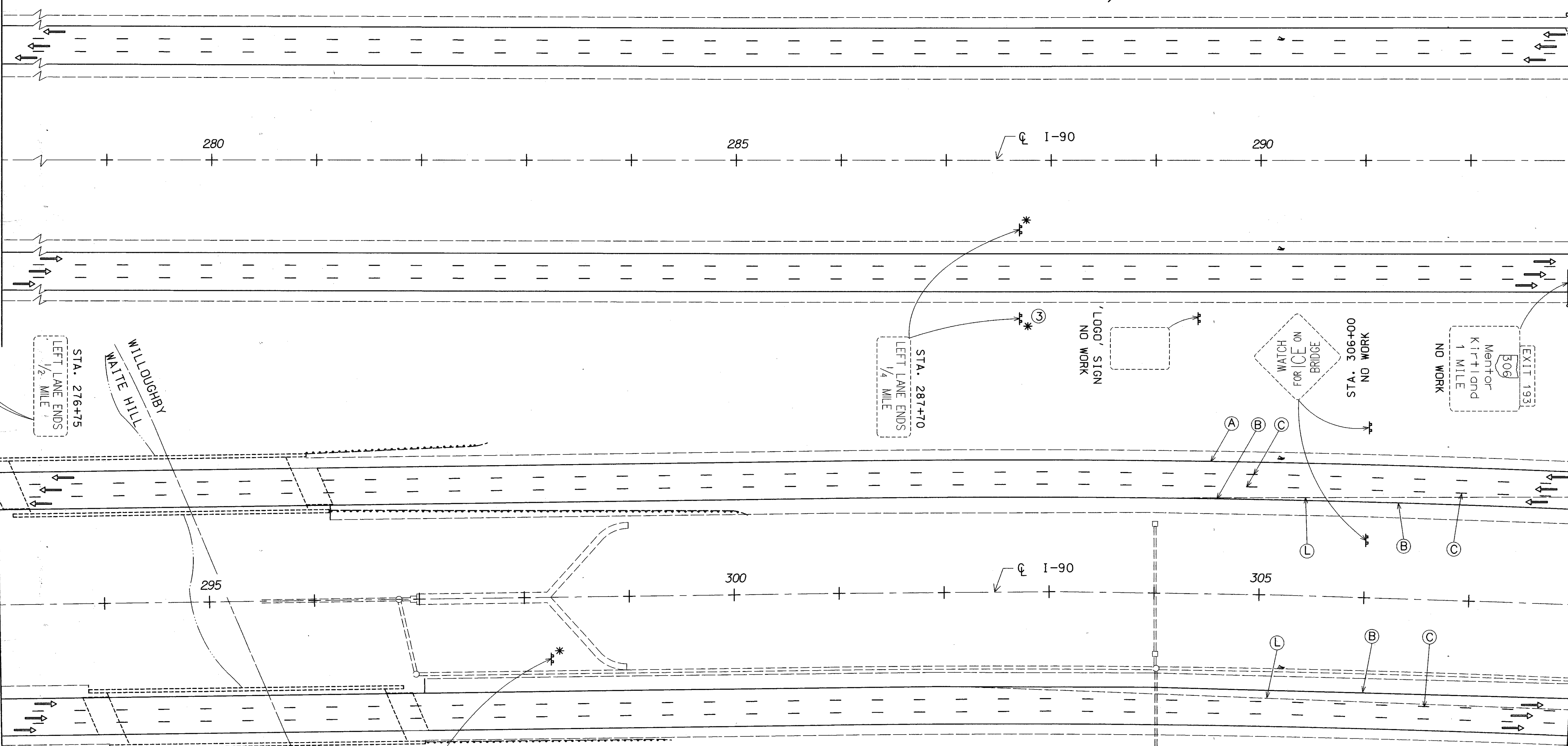

- LEGEND**
- (A) - EDGE LINE (WHITE)
 - (B) - EDGE LINE (YELLOW)
 - (C) - LANE LINE
 - (D) - CHANNELIZING LINE
 - (E) - TRANSVERSE LINE (WHITE), 12' c/c
 - (F) - TRANSVERSE LINE (YELLOW), 100' c/c
 - (G) - STOP LINES
 - (H) - LANE ARROWS
 - (I) - WORD "ONLY" ON PAVEMENT
 - (J) - CROSSWALK LINES
 - (K) - REMOVAL OF PAVEMENT MARKING

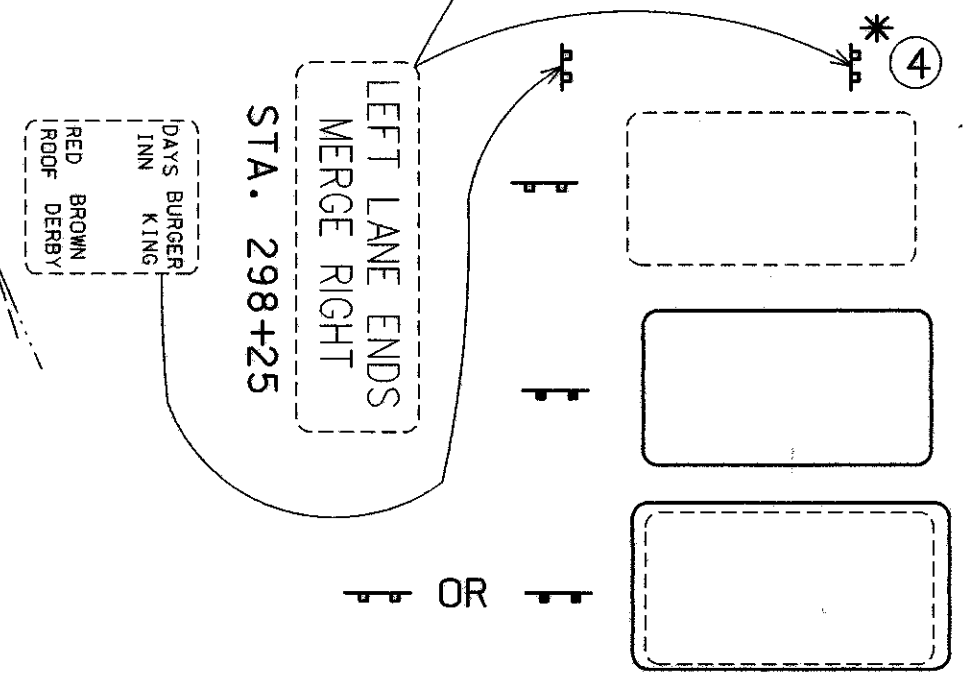

- (1) - EXISTING SIGN
(TO BE REMOVED
UNLESS "NO WORK"
SHOWN)
- (2) - PROPOSED SIGN
(WITH NEW LEGEND)
- (3) - PROPOSED SIGN
(WITH SAME LEGEND AS
EXISTING)

D - PROPOSED DUCT CABLE
(BURIED)

NOTE: GUARDRAIL BARRIER LOCATIONS SHOWN
ARE PROPOSED LOCATIONS AS SHOWN ON
THE ROADWAY PLAN SHEETS.

* SIGNS TO BE LEFT IN PLACE UNTIL
ALL THREE EASTBOUND LANES ARE
OPEN TO TRAFFIC, THEN IMMEDIATELY
REMOVED THEREAFTER.

REFERENCES:

ITEM	SHT. NO
PLAN SHEET	20
CROSS SECTIONS	-
SIGN DETAILS	151

T:\DGN\LAK-90\TRAFFCON\5774TPADGN

E:\Vign\lak-90\traffcon\5774tpadgn.dwg 13-DEC-90 10:37:32