

PLOTTED FROM: I:\PROJECTS\PI\23129\23129.mmb.dgn

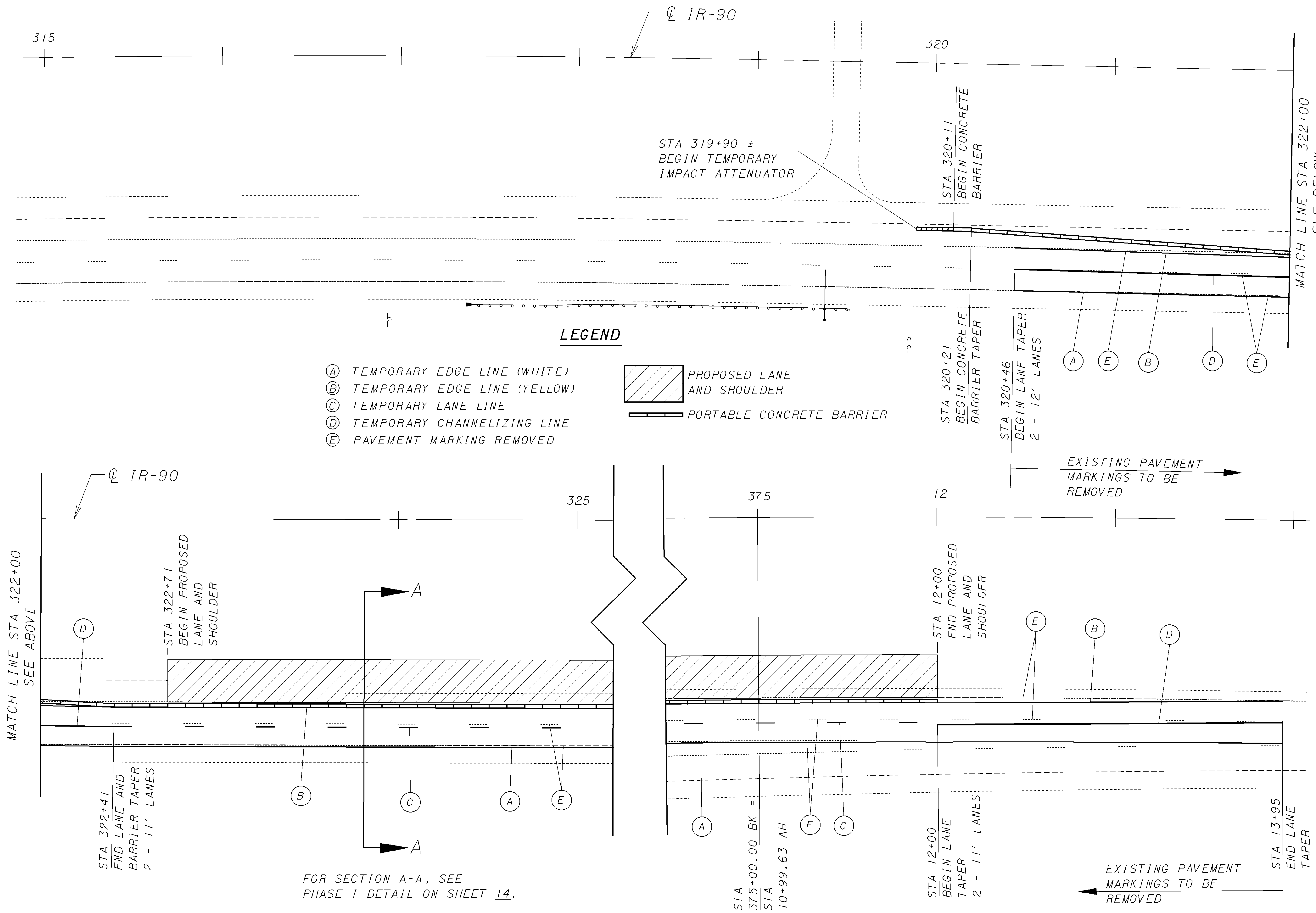

FOR SECTION A-A, SEE PHASE I DETAIL ON SHEET 14.

LEGEND

- (A) TEMPORARY EDGE LINE (WHITE)
- (B) TEMPORARY EDGE LINE (YELLOW)
- (C) TEMPORARY LANE LINE
- (D) TEMPORARY CHANNELIZING LINE
- (E) PAVEMENT MARKING REMOVED



STA 319+90 ±
BEGIN TEMPORARY
IMPACT ATTENUATOR

STA 320+11
BEGIN CONCRETE
BARRIER

STA 320+21
BEGIN CONCRETE
BARRIER TAPER

STA 320+46
BEGIN LANE TAPER
2 - 12' LANES

STA 322+41
END LANE AND
BARRIER TAPER
2 - 11' LANES

STA 322+71
BEGIN PROPOSED
LANE AND
SHOULDER

STA 12+00
BEGIN LANE
TAPER
2 - 11' LANES

STA 12+00
END PROPOSED
LANE AND
SHOULDER

STA 13+95
END LANE
TAPER
2 - 12' LANES

EXISTING PAVEMENT
MARKINGS TO BE
REMOVED

EXISTING PAVEMENT
MARKINGS TO BE
REMOVED

MATCH LINE STA 322+00
SEE BELOW

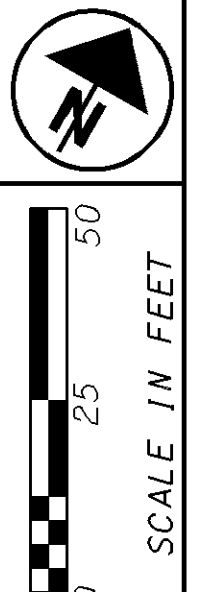

CALCULATED
EMK
CHECKED
LDH

MAINTENANCE OF TRAFFIC DETAIL

LAK-90-6.71