

NORMAL
 STA. 308+41.00 TO STA. 322+71.00 (EB SHOWN) = 1,430.00 LIN. FT.
 STA. 308+41.00 TO STA. 322+71.00 (WB MIRROR) = 1,430.00 LIN. FT.

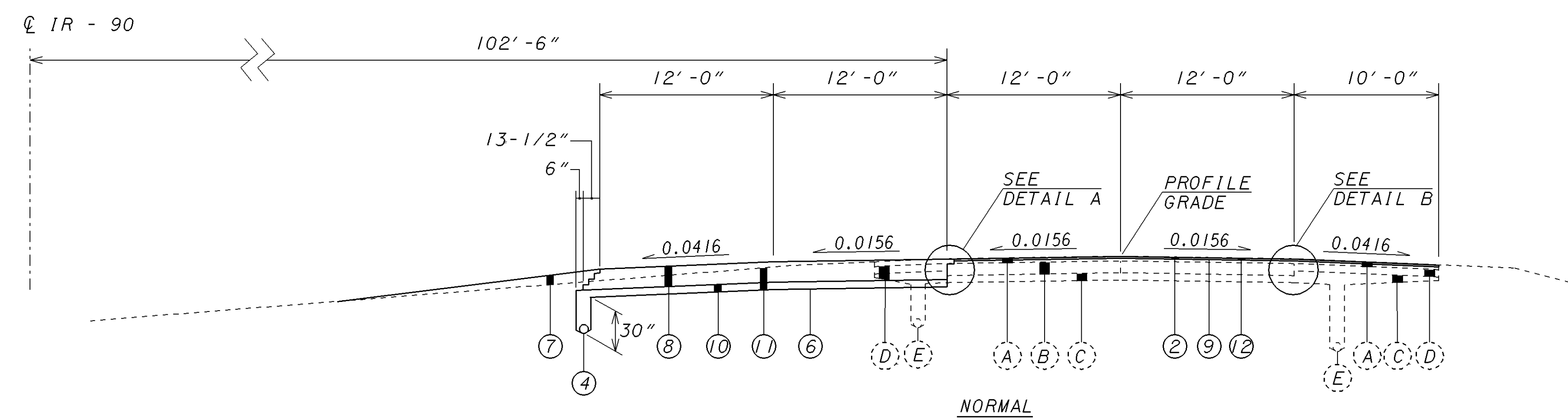

NORMAL
 STA. 322+71.00 TO STA. 375+00.00 BK. (EB) = 5229.00 LIN. FT.
 STA. 10+99.63 AH. TO STA. 12+00.00 (EB) = 100.37 LIN. FT.

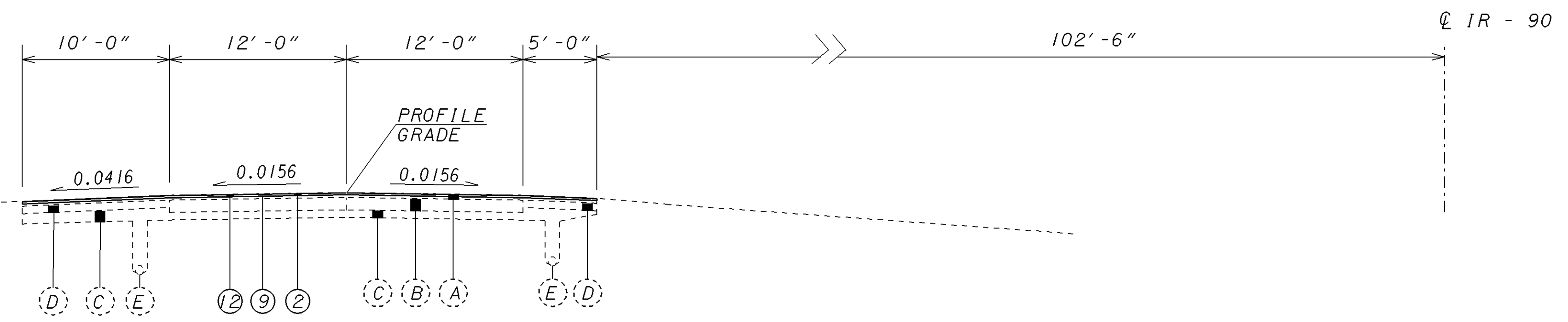

NORMAL

STA. 322+71.00 TO STA. 375+00.00 BK. (WB) = 5229.00 LIN. FT.
 STA. 10+99.63 AH. TO STA. 15+00.00 (WB) = 400.37 LIN. FT.

EXISTING

- (A) ASPHALT OVERLAY (4"±)
- (B) 10" REINFORCED CONCRETE BASE
- (C) SUBBASE
- (D) BIT. AGGREGATE BASE OR AGGREGATE BASE
- (E) UNDERDRAIN
- (F) 12" REINFORCED CONCRETE BASE

PROPOSED

- (1) ITEM 203 - LINEAR GRADING, METHOD A
- (2) ITEM 254 - PAVEMENT PLANING, BITUMINOUS, 1-1/2"
- (3) ITEM 448 - 3" ASPHALT CONCRETE INTERMEDIATE COURSE, TYPE 1, PG64-22, (UNDER GUARDRAIL)
- (4) ITEM 605 - 6" SHALLOW PIPE UNDERDRAIN
- (5) ITEM 606 - GUARDRAIL, TYPE 5
- (6) ITEM 203 - SUBGRADE COMPACTION
- (7) ITEM 203 - EMBANKMENT
- (8) ITEM 880 - 17" ASPHALT CONCRETE (7 YEAR WARRANTY)
- (9) ITEM 407 - TACK COAT
- (10) ITEM 304 - 6" AGGREGATE BASE, AS PER PLAN
- (11) ITEM 203 - EXCAVATION NOT INCLUDING EMBANKMENT CONSTRUCTION
- (12) ITEM 858 - 1-1/2" ASPHALT CONCRETE SURFACE COURSE, 12.5 MM, TYPE A (446)
- (13) ITEM 251 - PARTIAL DEPTH PAVEMENT REPAIR, AS PER PLAN

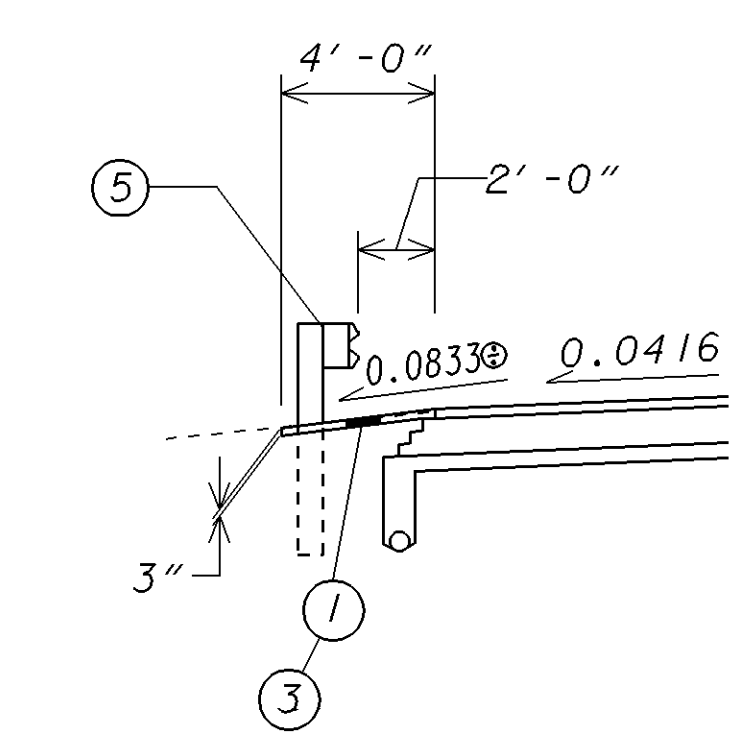

TYPICAL SHOULDER TREATMENT WITH GUARDRAIL

⊕ - THE 4'-0" OF ASPHALT UNDER GUARDRAIL ADJACENT TO THE PROPOSED TYPE E-98 ANCHOR ASSEMBLY (50'±) SHALL HAVE NO SLOPE.

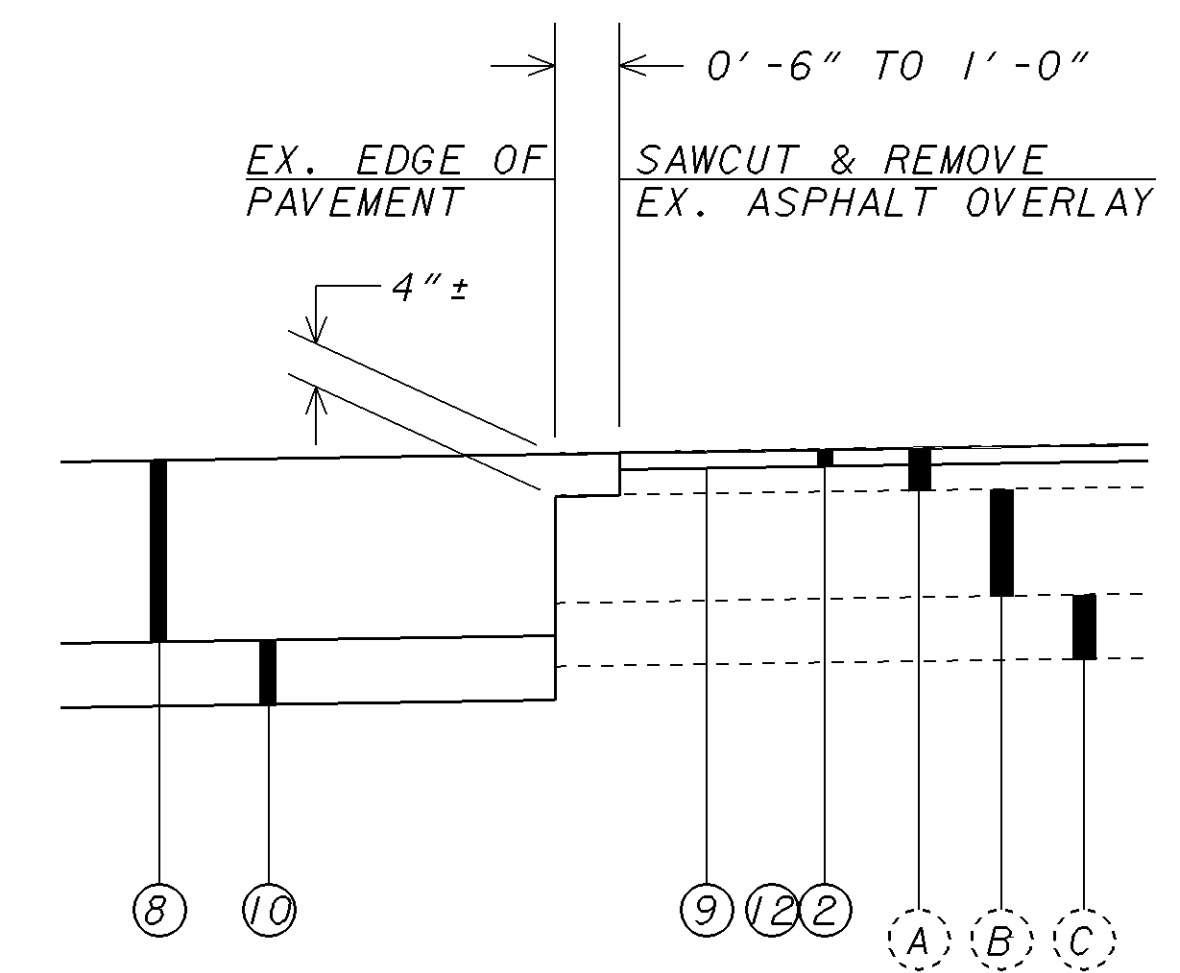

DETAIL A

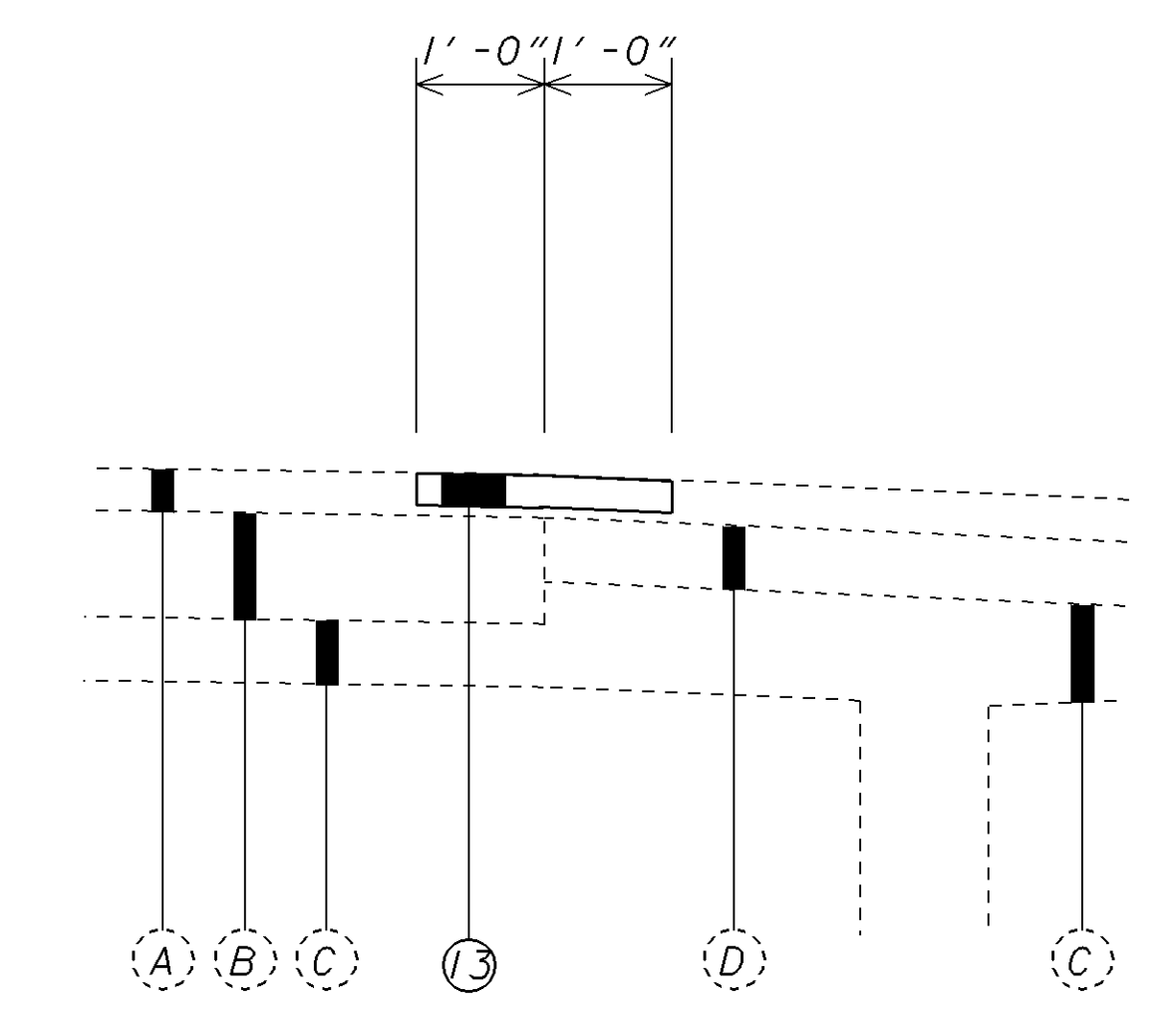

DETAIL B

NOTE: PERFORM WORK PRIOR TO PHASE 1

PLOTTED FROM: ..\PROJECTS\PI123129\23129gga.dgn