

LAKE COUNTY
LAK. 90-3.56

QUANTITIES
Made: LDJ 2-21-72
Ckd: REM 2-23-72

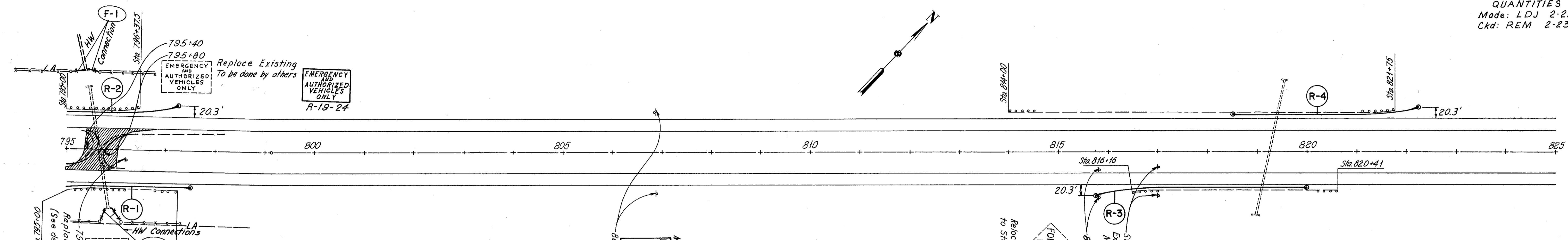

FENCE			
Ref. No.	Station	Side	607 Fence Type
	From	To	Lin. Ft.
F-1	795+00	WB	Lt. 49
F-2	795+00	EB	Rt. 72
Total			121

Ref. No.	Station	Side	GUARD RAIL											
			202 GR Removed for Reuse or Storage Painted	202 GR Removed for Reuse or Storage Galv.	202 BR Reuse or Storage Painted	606 GR as per plan	606 BR as per plan	606 Anchor Assembly	606 Anchor Assembly Barrier Design	606 Bridge Terminal Assembly				
	From	To	Lin. Ft.	Lin. Ft.	Lin. Ft.	Lin. Ft.	Lin. Ft.	Each	Each	Each	Type E	Type FM		
R-1	795+00	797+50	Rt. 232			225			1					
R-2	795+00	797+25	Lt. 137.5			200			1					
R-3	815+75	820+00	Rt. 412.5	12.5		375			2					
R-4	818+50	822+25	Lt. 775			325			2					
R-5	827+50	830+25	Rt. 87.5	75	150	175	75			1	1			
R-6	826+92.5	829+80	Lt. 125	200		262.5			1			1		
R-7	828+75	830+25	Rt. 300			125			1		1			
R-8	838+60	842+72.5	Lt. 537.5			387.5			1		1			
R-9	838+60	842+72.5	Lt. 250			262.5	75		1	1	1			
R-10	839+10	843+10	Rt. 287.5	212.5		375			1			1		
Totals						3144.5	500	412.5	2762.5	150	10	2	4	2

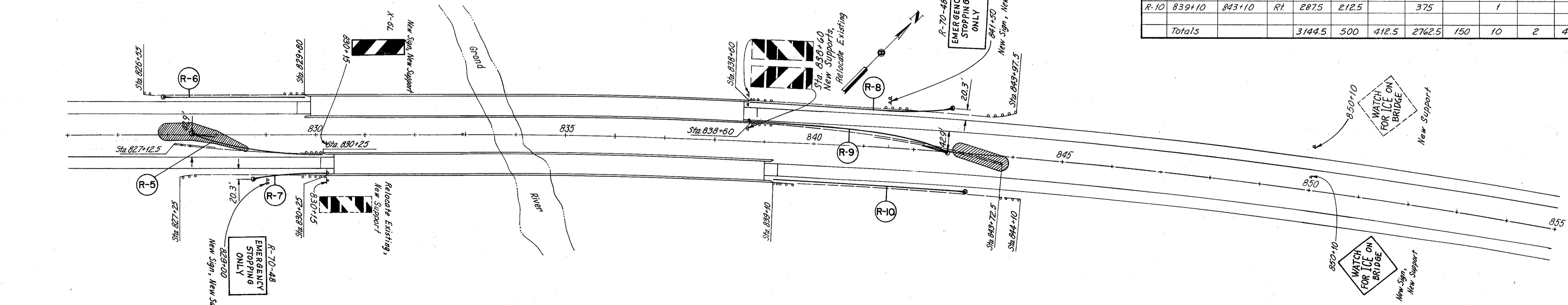

Note:
Existing "bridge end marker" signs are located in front of guard rail in shoulder. Move them 2' behind guard rail. See Detail Sheet 35.

Note:
For Guard Rail placement, See Sheet 47.
For Signing Quantities, See Sheets 37 & 90.