

QUANTITIES  
 Made: LJD 2-14-72  
 Ckd: REM 2-16-72

FED. RD. DIVISION	STATE	PROJECT
5	OHIO	

16  
 III

LAKE COUNTY  
 LAK. 90-3.56

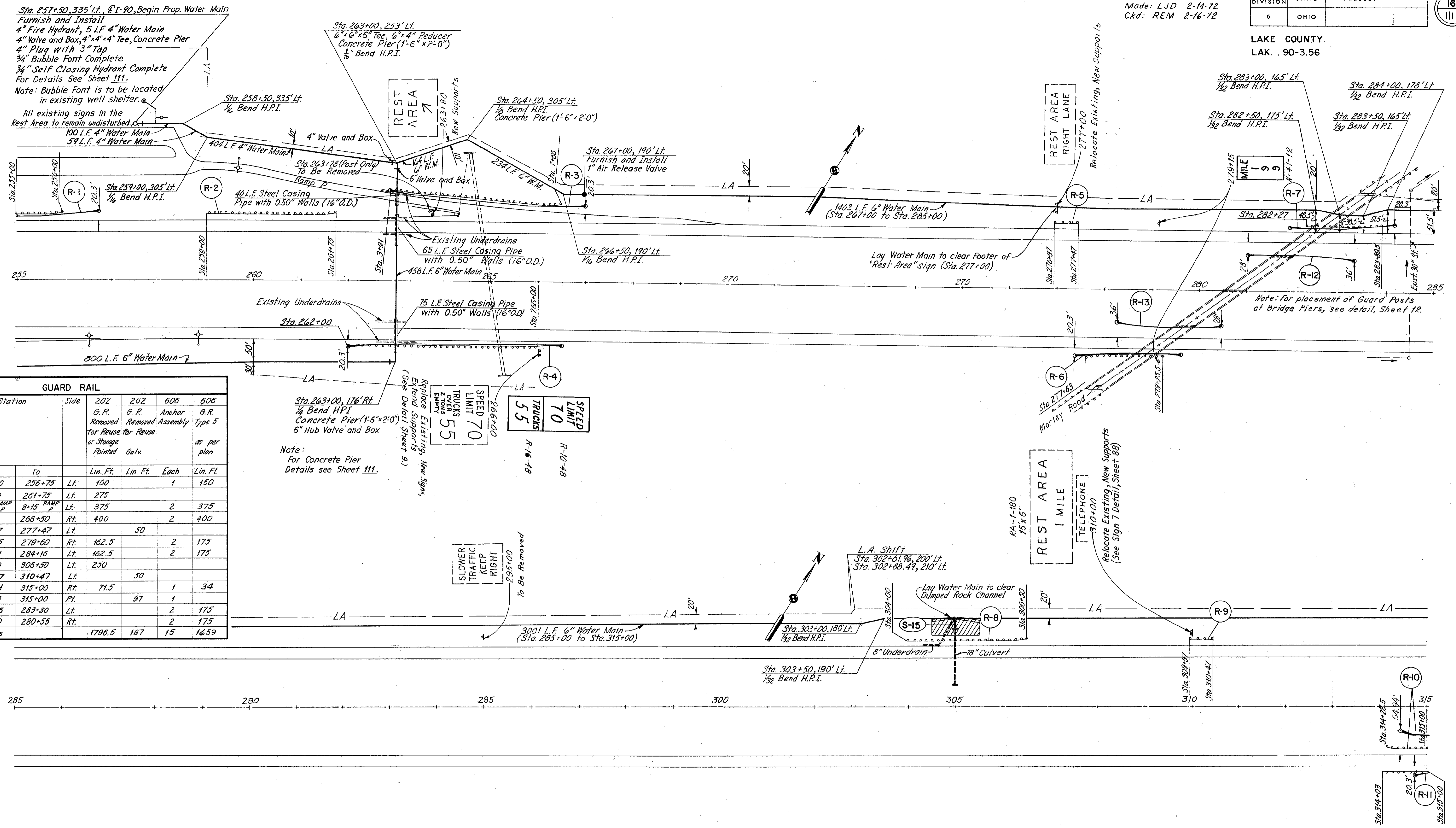

GUARD RAIL							
Ref. No.	Station	Side	202	202	606	606	
			G.R. Removed for Reuse or Storage	G.R. Removed for Reuse or Storage	Anchor Assembly	G.R. Type 5	
	From	To	Lin. Ft.	Lin. Ft.	Each	Lin. Ft.	
R-1	255+00	256+75	Lt.	100		1	150
R-2	259+00	261+75	Lt.	275			
R-3	3+90	8+15	RAMP	375		2	375
R-4	262+00	266+30	Rt.	400		2	400
R-5	276+97	277+47	Lt.		50		
R-6	277+35	279+00	Rt.	162.5		2	175
R-7	281+91	284+16	Lt.	162.5		2	175
R-8	304+00	306+30	Lt.	230			
R-9	309+97	310+47	Lt.		50		
R-10	314+41	315+00	Rt.	71.5		1	34
R-11	314+78	315+00	Rt.		97	1	
R-12	281+05	283+30	Lt.			2	175
R-13	278+30	280+55	Rt.			2	175
Totals				1796.5	197	15	1659

Note:  
 For Concrete Pier  
 Details see Sheet 111.

Note:  
 For Guard Rail placement See Sheet 47.  
 For Signing Quantities See Sheets 36 & 40.  
 For Water Main Profiles See Sheets 107, 108 & 109.

For Culvert Detail  
 See Sheet No. 56.

SCALE 1" = 100'  
 HOWARD, NEEDLES, TAMMEN & BERGENDOFF  
 MADE LJD DATE 2-14-72  
 TRCD. G.T. DATE 2-15-72  
 CKD. REM. DATE 2-16-72  
 CONSULTING ENGINEERS  
 KANSAS CITY CLEVELAND NEW YORK

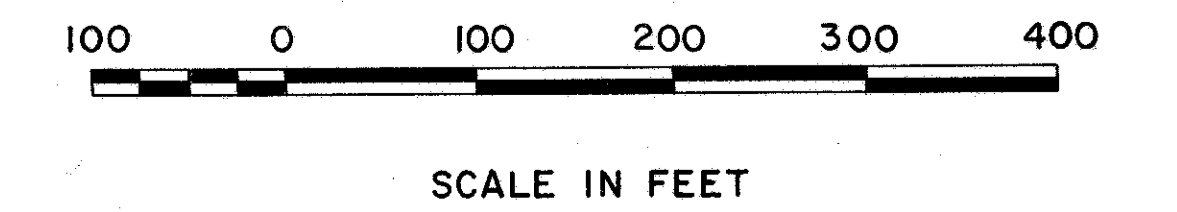

STA 255+00 TO STA 315+00