

F.H.W.A. REG.	STATE	PROJECT
5	OHIO	

25  
38

LAK-90-3.28  
LAKE COUNTY

EXISTING STRUCTURE DATA

- TYPE: CONTINUOUS RIVETED STEEL GIRDERS WITH REINFORCED CONCRETE DECK AND SUBSTRUCTURE
- SPANS: 90'-0"±, 129'-11"±, 102'-8"±, 101'-8"±, 101'-10"±, 97'-0"± CENTERLINE TO CENTERLINE OF BEARINGS
- SKEW: 45° 57' 16"± RIGHT FORWARD
- ROADWAY: 70'-0" FACE TO FACE OF CURBS WITH 2'-0" SAFETY CURB AND 1'-0" PARAPET EACH SIDE. MEDIAN BARRIER VARIES 3'-0" TO 14'-0"
- LOADING: C.F. 2000 (57) ADEQUATE FOR AASHO ALTERNATE LOADING
- WEARING SURFACE: 1" MONOLITHIC CONCRETE AND VARIABLE DEPTH ASPHALT CONCRETE (1 1/2"±)
- APPROACH SLAB: 25' LONG
- ALIGNMENT: TANGENT
- SLOPE PROTECTION: CRUSHED AGGREGATE SLOPE PROTECTION

PROPOSED STRUCTURE DATA

- TYPE: EXISTING STEEL GIRDERS AND REINFORCED CONCRETE SUBSTRUCTURE WITH NEW REINFORCED CONCRETE DECK
- SPANS: 90'-0"±, 129'-11"±, 102'-8"±, 101'-8"±, 101'-10"±, 97'-0"±
- SKEW: 45° 57' 16"± RIGHT FORWARD
- ROADWAY: 66'-0" FACE TO FACE OF CURBS WITH 5'-0" SIDEWALK AND 1'-0" PARAPET EACH SIDE. MEDIAN BARRIER CONCRETE 3'-0" WIDE.
- LOADING: HS20-44, CASE II AND ALTERNATE MILITARY LOADING.
- WEARING SURFACE: MONOLITHIC CONCRETE
- APPROACH SLAB: 25' LONG, AS-1-81
- ALIGNMENT: TANGENT
- SLOPE PROTECTION: CRUSH AGGREGATE SLOPE PROTECTION

TRAFFIC: ADT: 1990 45,470  
2010 52,570

ADDT: 1990 7275  
2010 8410

URS

3/16

GENERAL PLAN & ELEVATION

BRIDGE N° LAK-90-0328

S.R.91 OVER I-90

LAKE COUNTY WILLOUGHBY HILLS  
STA 26+74.51 TO STA 33+04.07

DESIGNED	DRAWN	TRACED	CHECKED	REVIEWED	DATE	REVISED
JAL	LWW		R.J.P.	JAL	3/19/90	

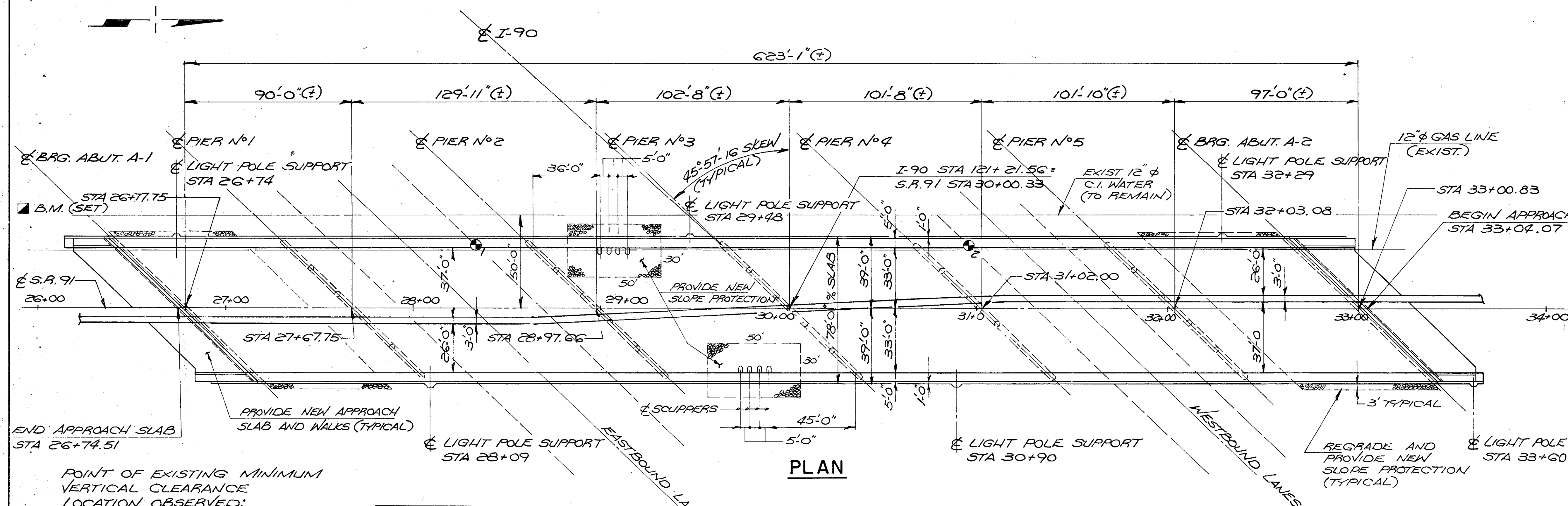

PLAN

POINT OF EXISTING MINIMUM VERTICAL CLEARANCE LOCATION OBSERVED:

- <sub>1</sub> = 15.98'
- <sub>2</sub> = 18.05'

■ BENCH MARK = EL. 751.64  
□ SET ON NORTHEAST CORNER OF BASE FOR SIGNAL GUY. STA 25+20 ± LT. OF S.R. 91

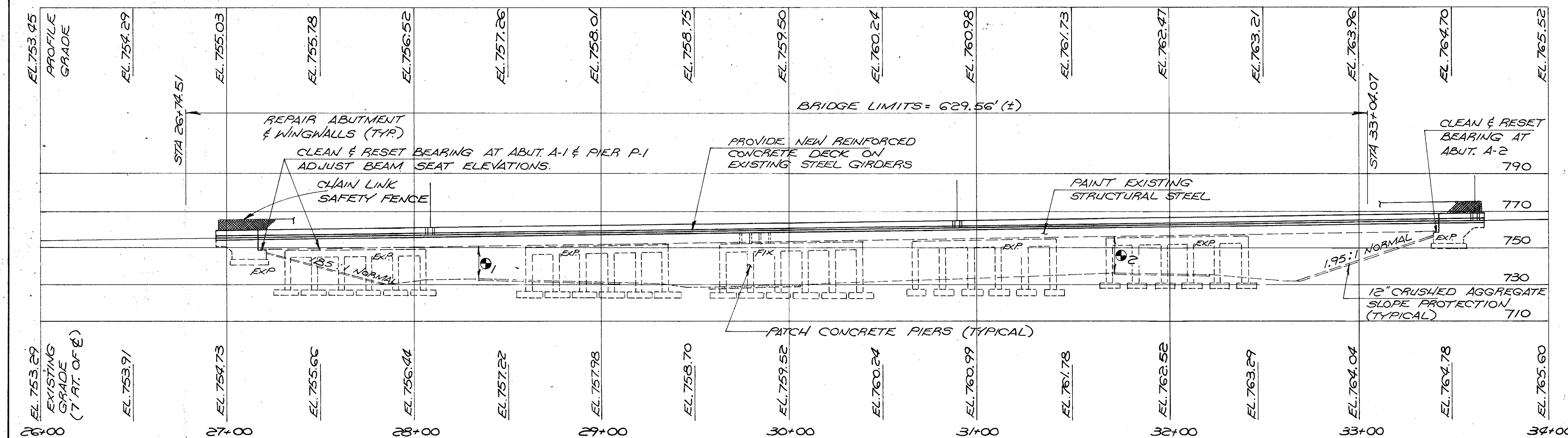

ELEVATION