

b-m

W-9

FED. RD. DIVISION	STATE	PROJECT	256 280
2	OHIO	ACI-1103(29)	

LAKE COUNTY
 SEC. LAK-1-22.60
LAK-90-23-27.13

Sta. 100 + 00.00 \bar{C} Reloc. S. R. 307 =
 Sta. 957 + 30.00 \bar{C} S. R. 1

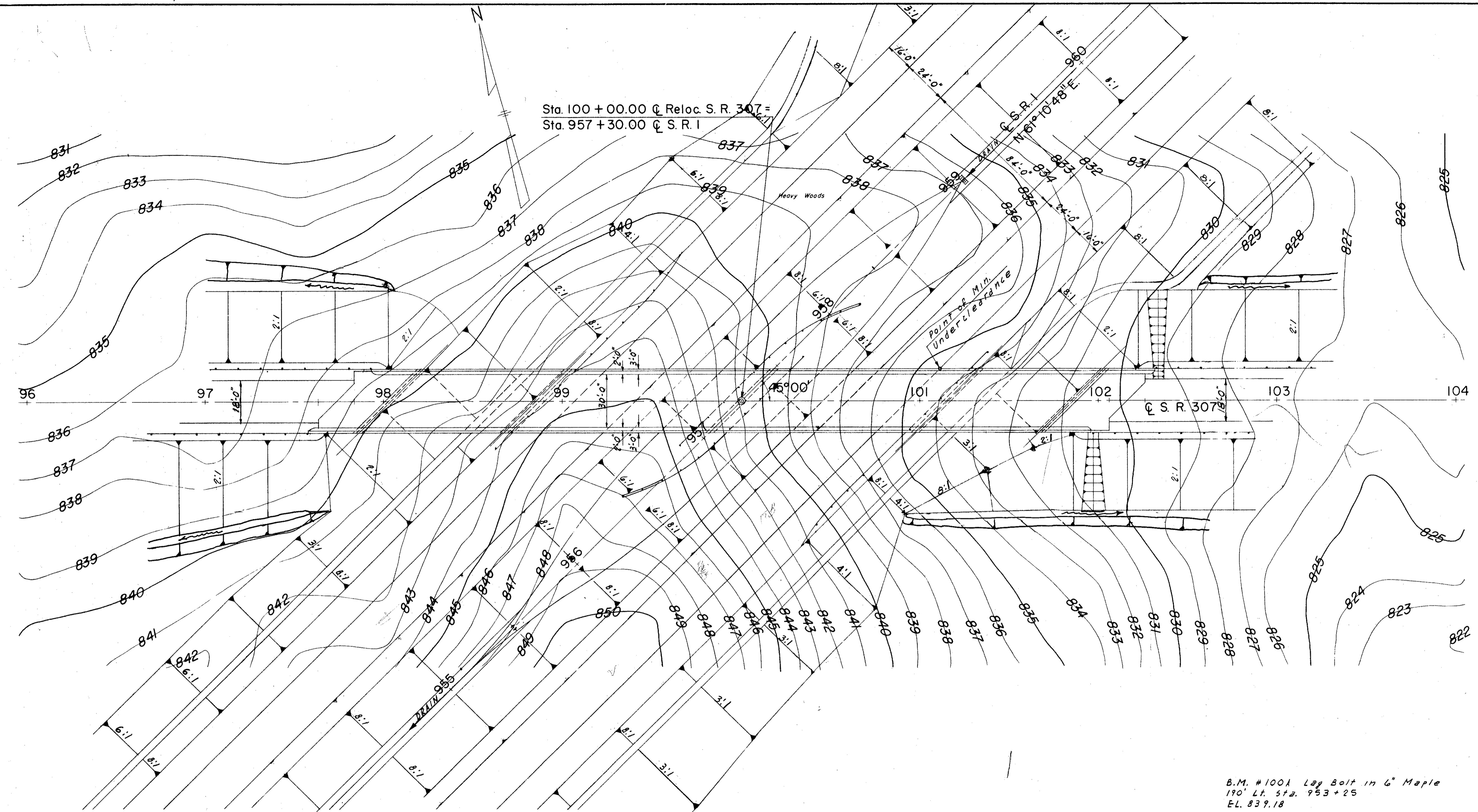

FOUNDATION SOUNDINGS:
 Foundation design and foundation quantities are based on a study of borings and soil-sampling soundings made at the site. This sounding information may be inspected in the Interstate Projects Office and in the Division Office, but the state does not guarantee the accuracy thereof.

PROPOSED STRUCTURE
 TYPE: Continuous Plate Girder with Reinf. Conc. Deck & Substructure.
 SPANS: 81'-0", 115'-4", 115'-4", 64'-3" c/c BRGS.
 ROADWAY: 30'-0" Face to Face, 2'-0" Safety Curbs.
 LOAD FREQUENCY: CF-130
 SKEW: 45°-00' Left Forward
 WEARING SURFACE: 3" Monolithic
 APPROACH SLAB: 25'-0" LONG
 ALIGNMENT: Tangent
 ADT: 1460

B.M. #100A Lag Bolt in 6" Maple
 190' Lt. Sta. 953+25
 EL. 839.18

B.M. #101A Lag Bolt in root 8" Ash
 170' Rt. Sta. 961+50
 EL. 825.48

P.V.C. Sta. 100+50
 ELEV. 864.25
 L.V.C. = 90°
 M = 6.58'

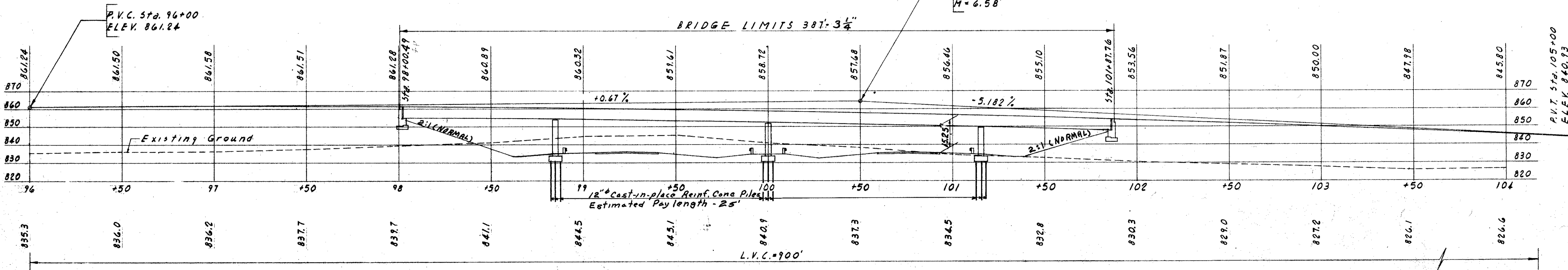

SEC. C-35 FED. AID PROJ. NO. ACI-1103(29)

PREPARED BY
 CAPITOL ENGINEERING ASSOCIATES, DILLSBURG, PA.
 FOR
 STATE OF OHIO
 DEPARTMENT OF HIGHWAYS

SITE PLAN
 BRIDGE NO. LAK-1-2417
 S.R.I. UNDER RELOC. S. R. 307
 LAKE COUNTY
 STA. 957 + 30.00

DESIGNED	DRAWN	TRACED	CHECKED	REVISED	DATE	REVISED
PJP	PJP					7-9-58