

LAKE COUNTY  
LAK-I-22.60

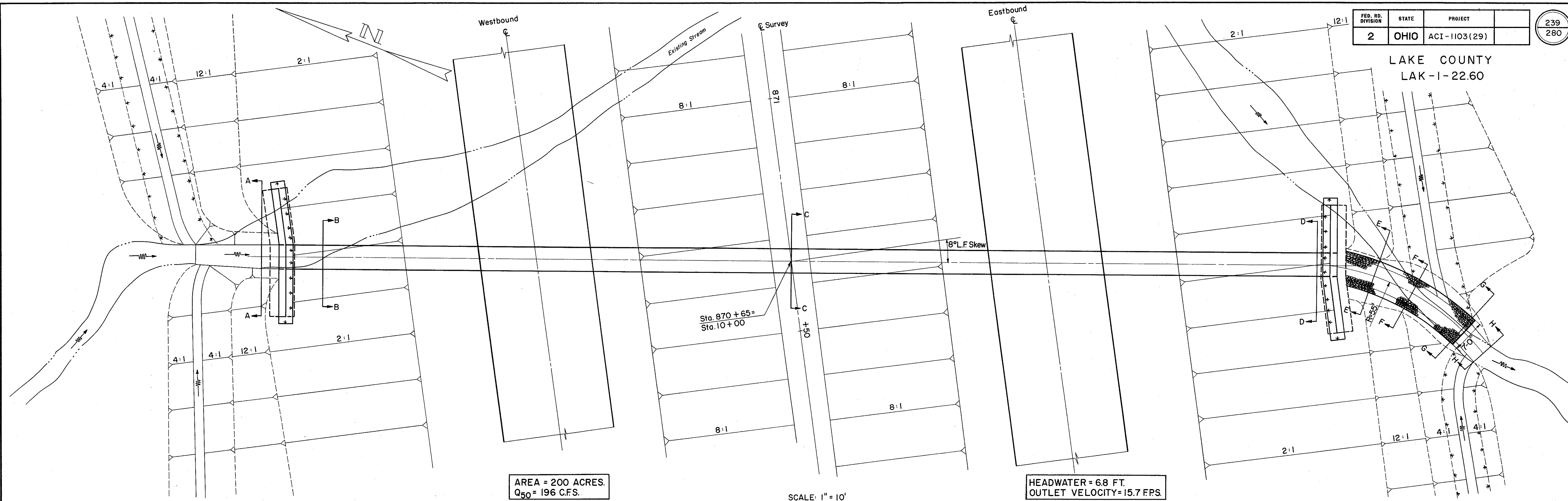

AREA = 200 ACRES.  
Q<sub>50</sub> = 196 C.F.S.

SCALE: 1" = 10'

HEADWATER = 6.8 FT.  
OUTLET VELOCITY = 15.7 FPS.

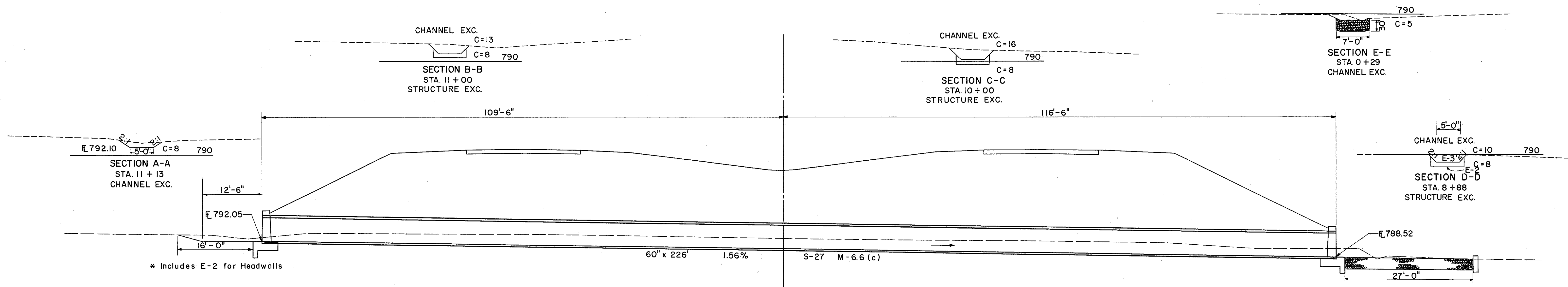

**ESTIMATED QUANTITIES**

|       |                                |      |  |
|-------|--------------------------------|------|--|
| * E-2 | Excavation for Structures " "  | 103  | C.Y.                                       |
| S-1   | Conc. for Structures Class C   | 42.7 | C.Y. (End Sill Concrete Included 0.9 C.Y.) |
| S-27  | 60" Pipe for Roadway Culverts  | 226  | L.F.                                       |
| L-10  | Sodding                        | 11.2 | S.Y.                                       |
| I-10  | Dumped Rock Channel Protection | 17.5 | C.Y.                                       |
| E-3   | Channel Excavation             | 124  | C.Y.                                       |
| S-4   | Reinforcing Steel              | 2072 | Lbs.                                       |

**CULVERT DATA**

TYPE: S-27, M-6.6 (c)  
 SIZE: 60" x 226'  
 WORK REQ'D. Build a pipe culvert with Type B Headwalls, Sodding Rt. & Lt., dumped rock on Rt. as shown.

FOR CONCRETE END SILL DETAILS  
SEE SHEET NO. 252

STRUCTURE NO. LAK-I-2320

PIPE CULVERT STA. 870+65