

LAKE COUNTY
LAK-1-22.60

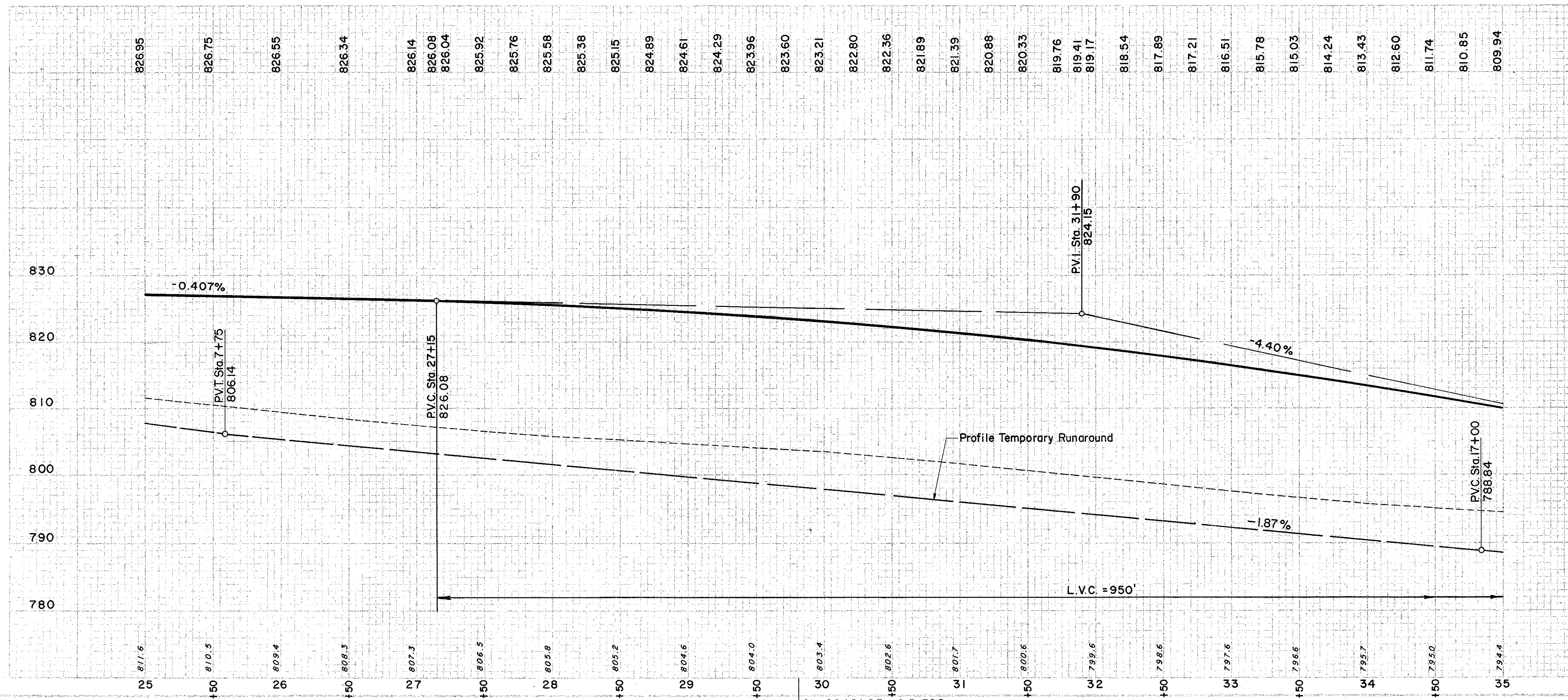
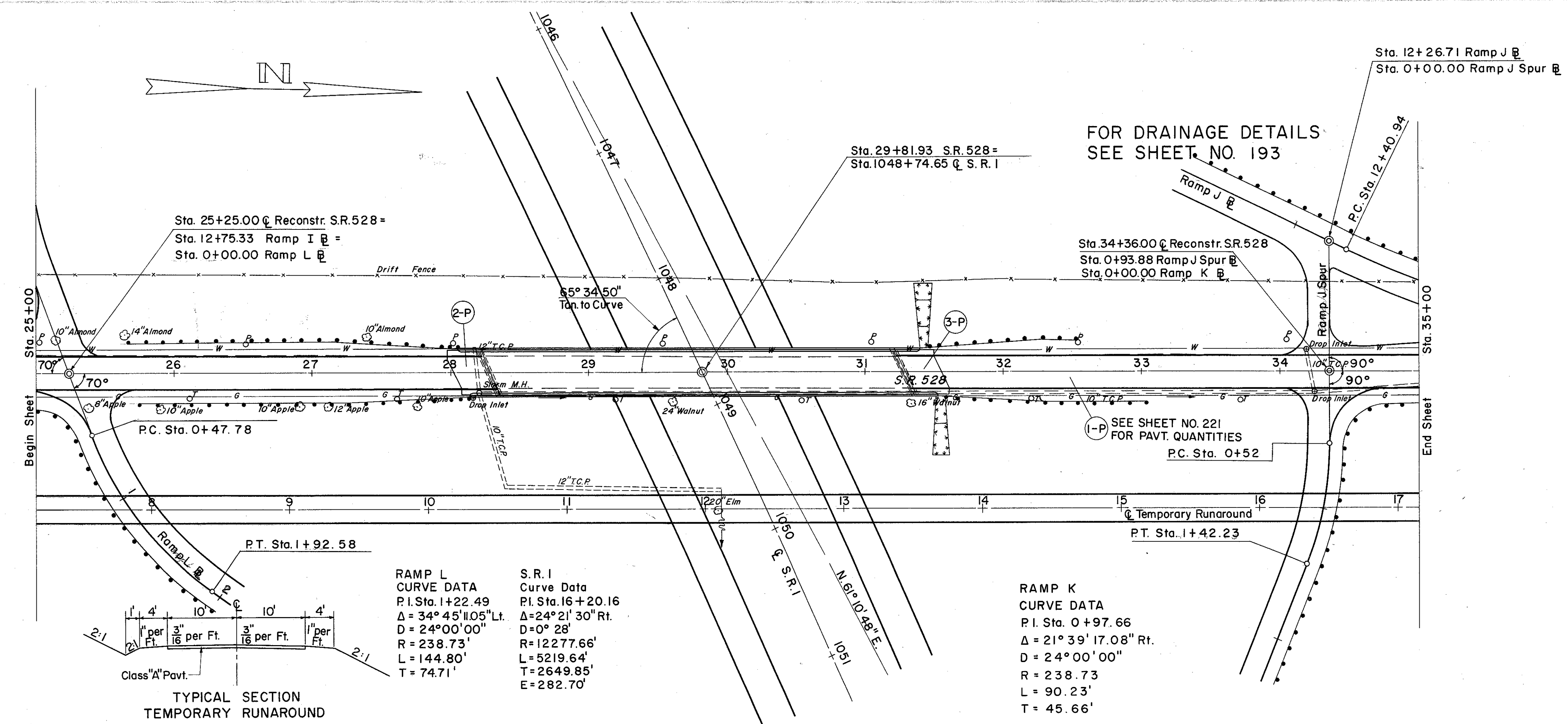

(P) PAVEMENT

REF. NO.	SIDE	STATION		I-7	S-15
		FROM	TO	REINF. CONC. APPR. SLAB S.Y.	TEMP. RUNAROUND CLASS "A" PAVT. EA.
2-P		28+02.96	28+27.96	89	
3-P		31+27.90	31+52.90	89	
4-P		0+00	22+66.07		1
TOTAL				178	1

EXCAVATION	=	263 C.Y.
EMBANKMENT	=	65,158 C.Y.
EMBANKMENT + 22%	=	79,493 C.Y.

Sta. 29+81.93 S.R. 528 =
 Sta. 1048+74.65 @ Reloc. S.R. 1