

TAPER CURVE DATA
 $\Delta = 8^{\circ}00'02''$ Rt.
 $D = 0^{\circ}40'14''$
 $R = 8544.41'$
 $L = 1193.08'$
 $T = 597.51'$

CURVE DATA
 P.I. Sta. 16+20.16
 $\Delta = 24^{\circ}21'30''$ Rt.
 $D = 0^{\circ}28'$
 $R = 12,277.66'$
 $L = 5219.64'$
 $T = 2649.85'$
 $E = 282.70'$

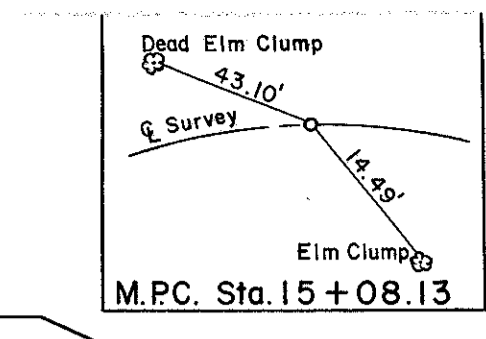

MARKER TO BE FURNISHED AND ERECTED ON THE LEFT BY THE STATE OF OHIO BEFORE ACCEPTANCE OF THE PROJECT

TYPICAL SECTION OF ADJOINING PAVEMENT IS THE SAME AS THAT SHOWN FOR THIS PROJECT.

ACI-1103(29) I-1103(15)

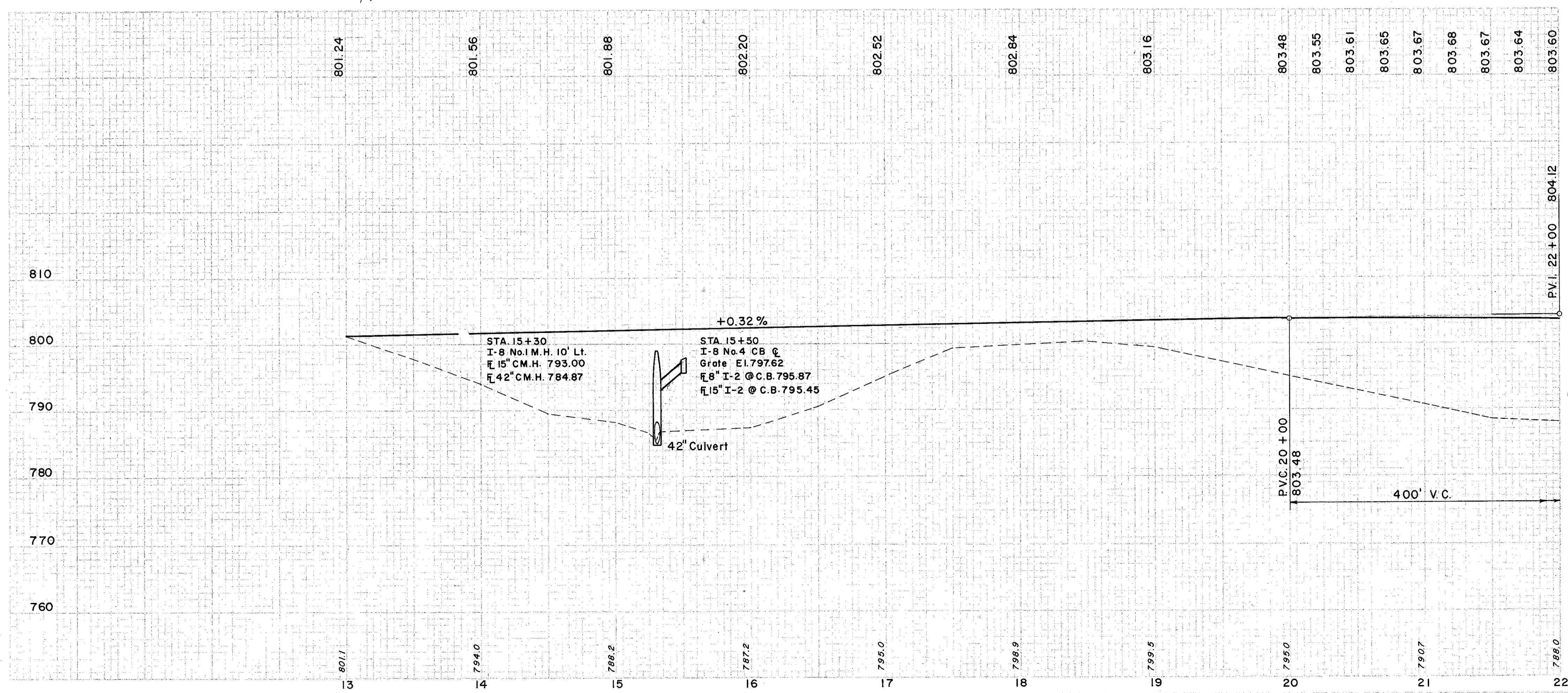

STA. 15+30
 I-8 No. 1 M.H. 10' Lt.
 E 15" C.M.H. 793.00
 E 42" C.M.H. 784.87

STA. 15+50
 I-8 No. 4 C.B. C
 Grate E1.797.62
 E 8" I-2 @ C.B. 795.87
 E 15" I-2 @ C.B. 795.45

(D) DRAINAGE

REF. NO.	SIDE	STATION	STATION		I-4	I-2	I-1	I-8	S-29	STD. TYPE I
			FROM	TO						
I-D	71	Lt.	13+00	19+00	630	10	10	10	0.3	
2-D	37	Lt.	13+00	19+00	626	10	10			
3-D	37	Rt.	13+00	19+00	626	10	10			
4-D	71	Rt.	13+00	19+00	626	10	10			
5-D	Lt.	C	13+00	17+00						
6-D	Rt.	C	13+00	19+00						
7-D	C	C	15+30	15+50	20					

(S) STRUCTURES

REF. NO.	SIDE	STATION	STATION		E-2	E-3	I-10	S-1	S-4	S-27
			FROM	TO						
I-S			15+28	15+28	122	69	131	21.2	10.23	218

(P) PAVEMENT

REF. NO.	SIDE	STATION	STATION		I-71	I-22	E-101
			FROM	TO			
I-P	Rt.		13+00	17+20	140	23.3	140
2-P	Lt.		13+00	15+60	280	46.7	280
				TOTAL	420	70.0	420

(R) ROADWAY

REF. NO.	SIDE	STATION	STATION		I-15
			FROM	TO	
I-R	Lt.		14+50	17+75	325
2-R	Rt.		13+00	17+00	400
				TOTAL	725

EXCAVATION = 1,672 C.Y.
 EMBANKMENT = 3,130 C.Y.
 PAVEMENT = 3,819 C.Y.