

LAKE COUNTY
LAK-1-22.60

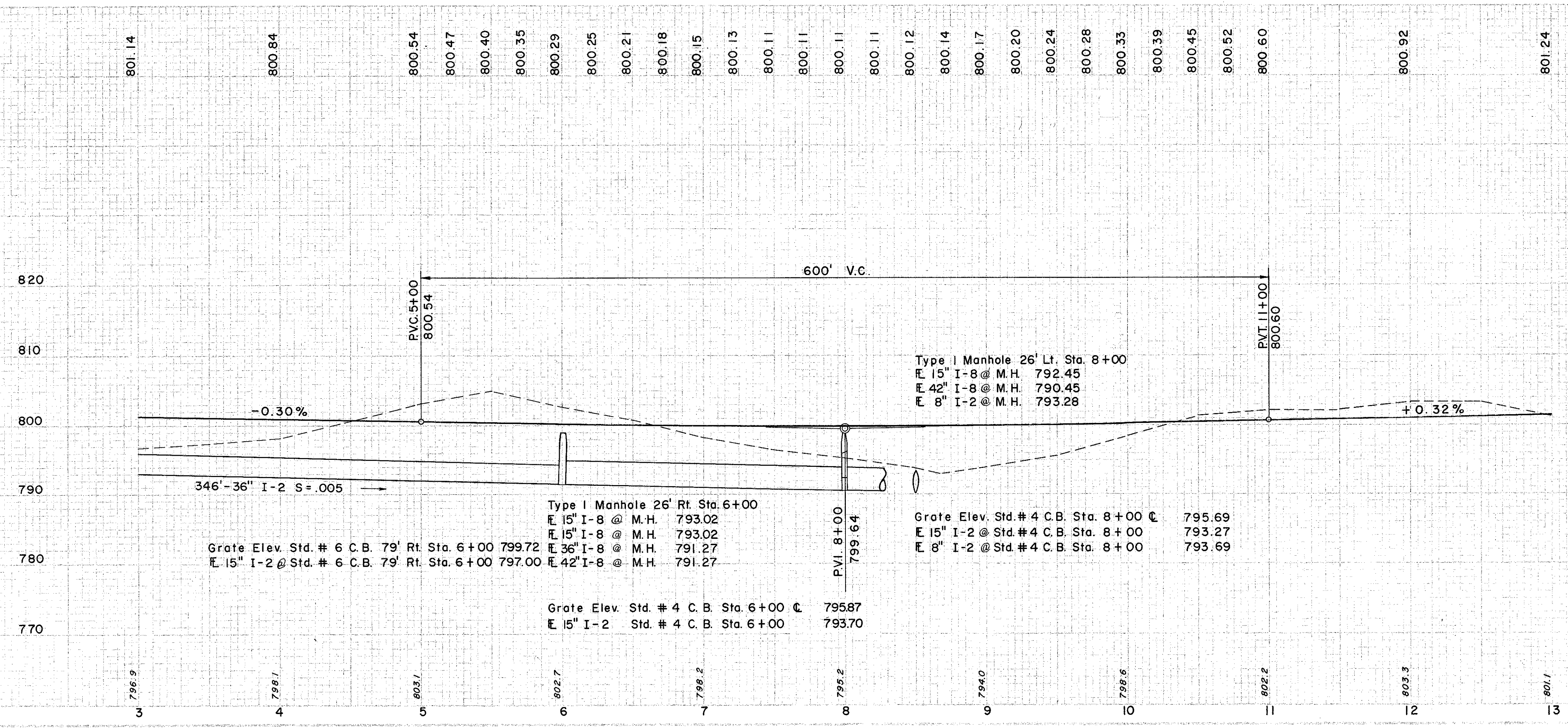
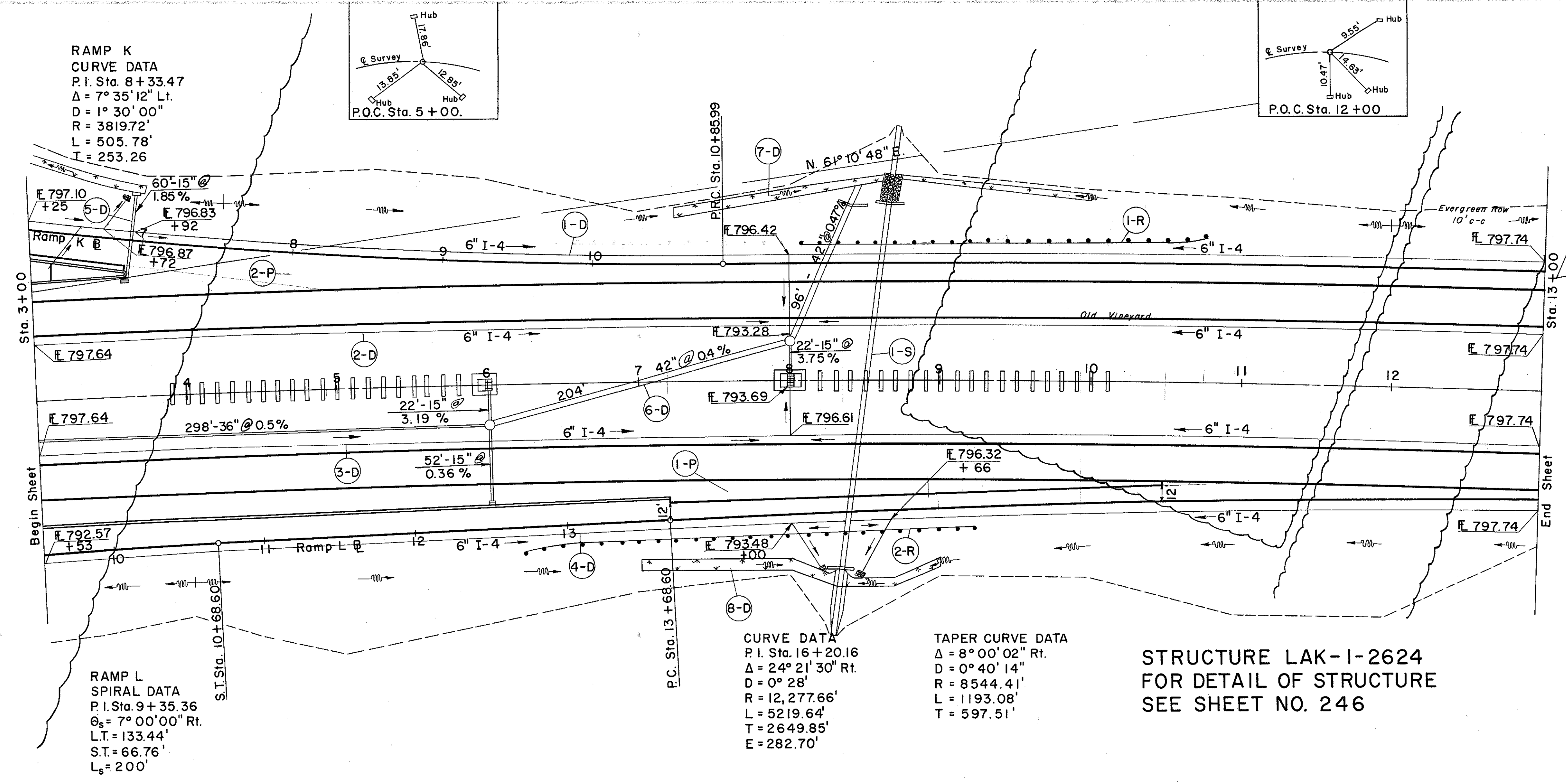

STRUCTURE LAK-1-2624
FOR DETAIL OF STRUCTURE
SEE SHEET NO. 246

IN

REF. NO.	STATION	STATION		STATION		STATION		STATION		STATION		E-2 EXC. FOR STRUCT. C.Y.	E-3 EXC. FOR STRUCT. C.Y.	E-4 REINF. STEEL LBS.	E-5 REINF. STEEL LBS.	E-6 EXC. FOR STRUCT. C.Y.	E-7 EXC. FOR STRUCT. C.Y.
		FROM	TO	FROM	TO	FROM	TO	FROM	TO	FROM	TO						
I-10	3+00	3+00	13+00	L-10	10+00	10+00	148	I-11	11+00	11+00	158	7+00	7+00	870			
I-2	13+00	13+00	13+00	I-2	13+00	13+00	148	I-12	12+00	12+00	1205.3	E-2	8+51	209			
I-4	13+00	13+00	13+00	I-4	13+00	13+00	204	I-13	13+00	13+00	420	I-14	14+00	486			
I-6	13+00	13+00	13+00	I-6	13+00	13+00	0.26	I-15	15+00	15+00	333	I-16	16+00	1024			
I-8	13+00	13+00	13+00	I-8	13+00	13+00	12.1	I-17	17+00	17+00	1743	I-18	18+00	591			
I-10	13+00	13+00	13+00	I-10	13+00	13+00	2948.0	I-19	19+00	19+00	333	I-20	20+00	982			
I-12	13+00	13+00	13+00	I-12	13+00	13+00	1742.6	I-21	21+00	21+00	420	I-22	22+00	242			
I-14	13+00	13+00	13+00	I-14	13+00	13+00	1205.3	I-23	23+00	23+00	207	I-24	24+00	486			
I-16	13+00	13+00	13+00	I-16	13+00	13+00	97.6	I-25	25+00	25+00	420	I-26	26+00	486			
I-18	13+00	13+00	13+00	I-18	13+00	13+00	420	I-27	27+00	27+00	420	I-28	28+00	486			
I-20	13+00	13+00	13+00	I-20	13+00	13+00	322.4	I-29	29+00	29+00	420	I-30	30+00	486			
I-22	13+00	13+00	13+00	I-22	13+00	13+00	322.4	I-31	31+00	31+00	420	I-32	32+00	486			
I-24	13+00	13+00	13+00	I-24	13+00	13+00	322.4	I-33	33+00	33+00	420	I-34	34+00	486			
I-26	13+00	13+00	13+00	I-26	13+00	13+00	322.4	I-35	35+00	35+00	420	I-36	36+00	486			
I-28	13+00	13+00	13+00	I-28	13+00	13+00	322.4	I-37	37+00	37+00	420	I-38	38+00	486			
I-30	13+00	13+00	13+00	I-30	13+00	13+00	322.4	I-39	39+00	39+00	420	I-40	40+00	486			
I-32	13+00	13+00	13+00	I-32	13+00	13+00	322.4	I-41	41+00	41+00	420	I-42	42+00	486			
I-34	13+00	13+00	13+00	I-34	13+00	13+00	322.4	I-43	43+00	43+00	420	I-44	44+00	486			
I-36	13+00	13+00	13+00	I-36	13+00	13+00	322.4	I-45	45+00	45+00	420	I-46	46+00	486			
I-38	13+00	13+00	13+00	I-38	13+00	13+00	322.4	I-47	47+00	47+00	420	I-48	48+00	486			
I-40	13+00	13+00	13+00	I-40	13+00	13+00	322.4	I-49	49+00	49+00	420	I-50	50+00	486			
I-42	13+00	13+00	13+00	I-42	13+00	13+00	322.4	I-51	51+00	51+00	420	I-52	52+00	486			
I-44	13+00	13+00	13+00	I-44	13+00	13+00	322.4	I-53	53+00	53+00	420	I-54	54+00	486			
I-46	13+00	13+00	13+00	I-46	13+00	13+00	322.4	I-55	55+00	55+00	420	I-56	56+00	486			
I-48	13+00	13+00	13+00	I-48	13+00	13+00	322.4	I-57	57+00	57+00	420	I-58	58+00	486			
I-50	13+00	13+00	13+00	I-50	13+00	13+00	322.4	I-59	59+00	59+00	420	I-60	60+00	486			

(P) PAVEMENT

REF. NO.	STATION	FROM	TO	ITEM	QTY	UNIT
I-10	3+00	3+00	13+00	42" CL" B" CONC. FOR STORM SEWER	204	L.F.
				15' STORM SEWER UNDER PAVEMENT	60	L.F.
				6" x 6" WYE	2	E.A.
I-12	13+00	13+00	STANDARD CURB	207	L.F.	
			SPECIAL CURB	207	L.F.	
			SODDING	333	S.Y.	
I-21	13+00	13+00	PORTLAND CEMENT	333	S.Y.	
			CONCRETE	333	S.Y.	
			PAVEMENT	2948	S.Y.	
I-101	13+00	13+00	COMPACT. SUBGRADE	1743	S.Y.	
			CONC. CLASS "C"	1205	S.Y.	
			STEEL	2948	LBS.	
TOTALS	2948.0	4200		207	L.F.	
				420	L.F.	

(S) STRUCTURES

REF. NO.	STATION	FROM	TO	ITEM	QTY	UNIT
I-2	13+00	13+00	13+00	STANDARD CURB	207	L.F.
				SPECIAL CURB	207	L.F.
I-10	13+00	13+00	13+00	SODDING	333	S.Y.
				CONC. CLASS "C"	1205	S.Y.
I-21	13+00	13+00	13+00	PORTLAND CEMENT	333	S.Y.
				CONCRETE	333	S.Y.
E-101	13+00	13+00	13+00	COMPACT. SUBGRADE	1743	S.Y.
				CONC. CLASS "C"	1205	S.Y.
S-27	13+00	13+00	13+00	REINF. STEEL	982	LBS.
				STEEL	982	LBS.
TOTALS	13+00	13+00	13+00		207	L.F.
					420	L.F.

(R) ROADWAY

REF. NO.	STATION	FROM	TO	ITEM	QTY	UNIT
I-15	13+00	13+00	13+00	ROADWAY	1480	S.Y.
				SUBTOTAL	1480	S.Y.
I-25	13+00	13+00	13+00	ROADWAY	75	S.Y.
				SUBTOTAL	75	S.Y.
I-44	13+00	13+00	13+00	ROADWAY	67	S.Y.
				SUBTOTAL	67	S.Y.
I-51	13+00	13+00	13+00	ROADWAY	133	S.Y.
				SUBTOTAL	133	S.Y.
I-1480	13+00	13+00	13+00	ROADWAY	610	S.Y.
				SUBTOTAL	610	S.Y.
TOTALS	13+00	13+00	13+00		20,567	C.Y.
					9,147	C.Y.
					11,159	C.Y.