

LAKE COUNTY
LAK-I-22.60

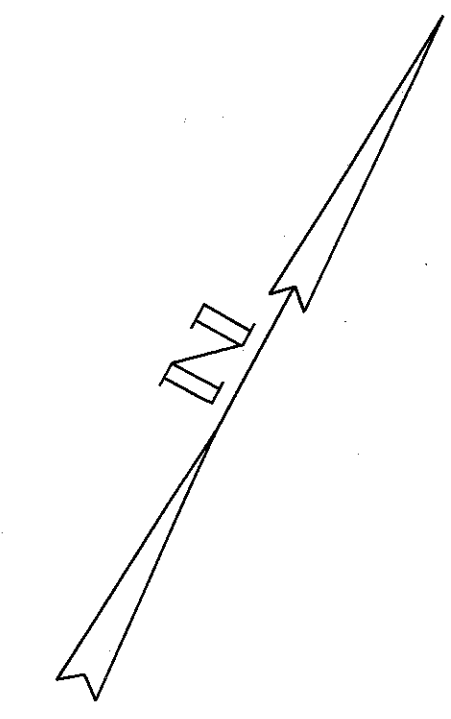
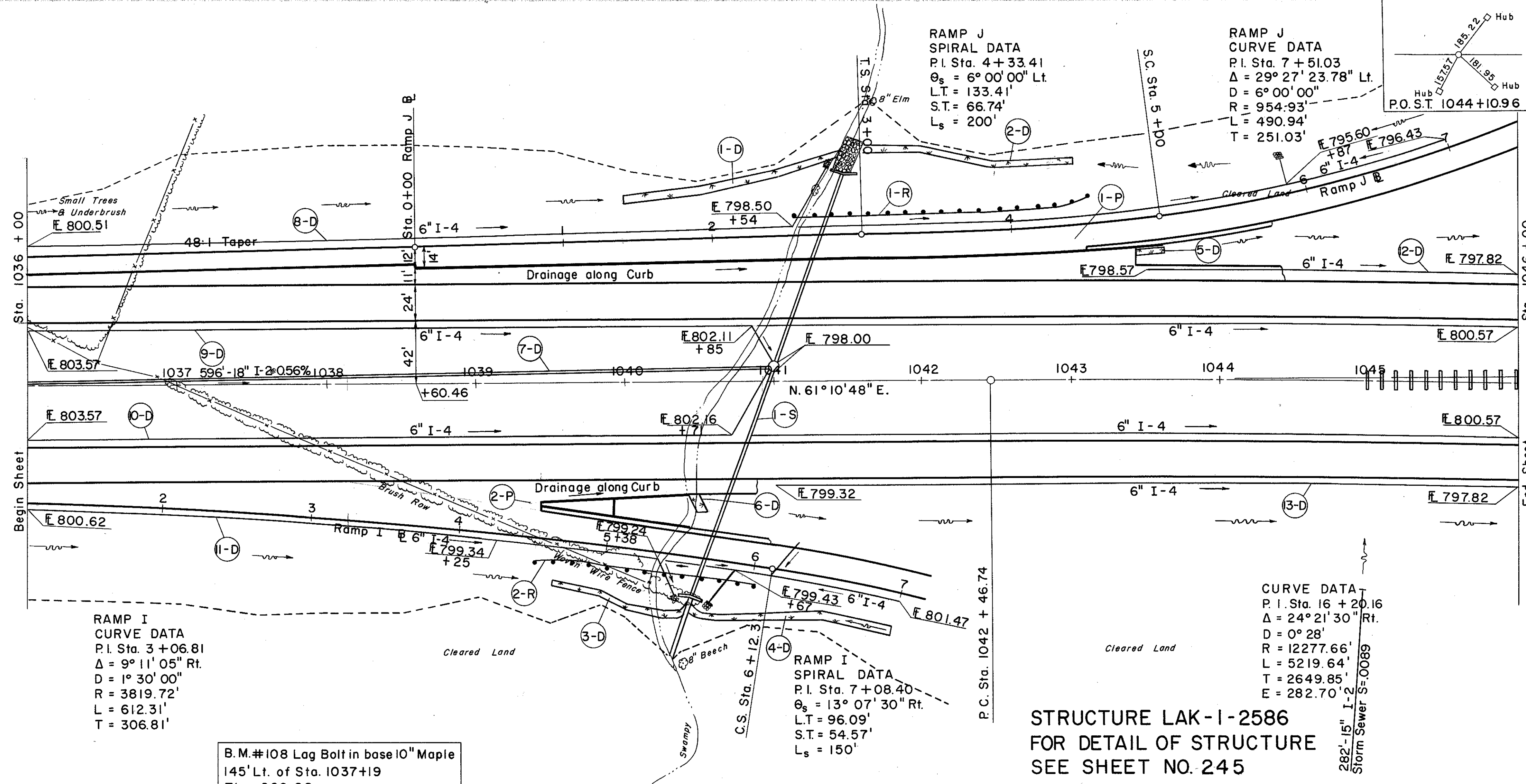

SODDING LEFT DITCH

STATION	WIDTH	DEPTH	LENGTH	S.Y.
1040+00	60	45	150	88.0
1041+50	40	45	98	50.0
1042+50	40	45	50	23.0
1043+00	40	45		
SUBTOTAL			161.0	

SODDING RIGHT DITCH

STATION	WIDTH	DEPTH	LENGTH	S.Y.
1036+00	40	45	50	27.0
1037+00	40	45	50	38.0
1038+00	40	45	42	19.0
1039+00	40	45	50	32.0
1040+00	40	45	50	42.0
1041+00	40	45	50	42.0
1042+00	40	45	50	42.0
SUBTOTAL			158.0	

(R) ROADWAY

REF. NO.	STATION	STATION		TOTAL
		FROM	TO	
		1-15	GUARD RAIL STEEL BEAM TYPE NO. 2-B	200
		1-R	2+54 Ramp J	150
		2-R	4+50 Ramp J	150
			TOTAL	350

RAMP I CURVE DATA
 P.I. Sta. 3+06.81
 Δ = 9° 11' 05" Rt.
 D = 1" 30' 00"
 R = 3819.72'
 L = 612.31'
 T = 306.81'

RAMP I SPIRAL DATA
 P.I. Sta. 7+08.40
 θs = 13° 07' 30" Rt.
 L.T. = 96.09'
 S.T. = 54.57'
 Ls = 150'

CURVE DATA
 P.I. Sta. 16+20.16
 Δ = 24° 21' 30" Rt.
 D = 0° 28'
 R = 12277.66'
 L = 5219.64'
 T = 2649.85'
 E = 282.70'

STRUCTURE LAK-I-2586
 FOR DETAIL OF STRUCTURE
 SEE SHEET NO. 245

B.M. #108 Lag Bolt in base 10" Maple
 145' Lt. of Sta. 1037+19
 Elev. 809.98

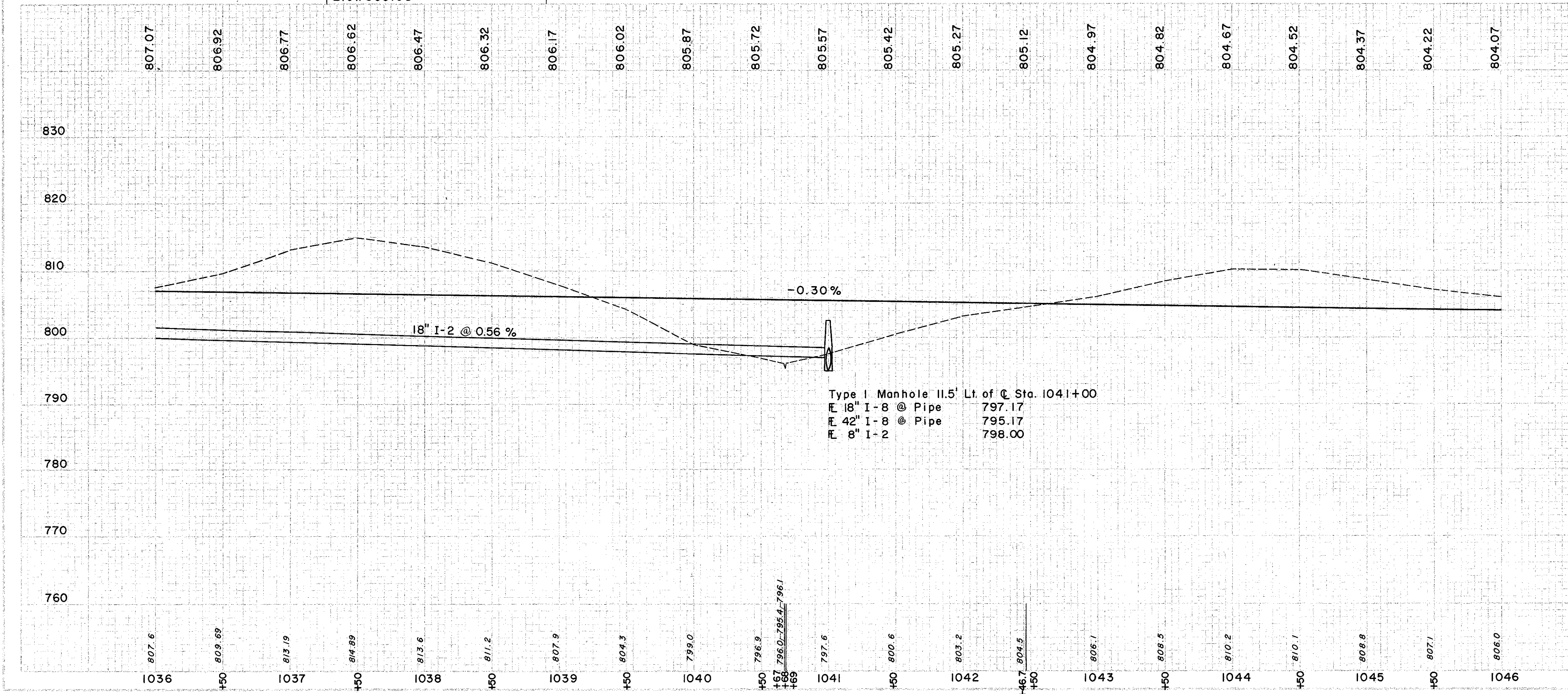

Type I Manhole 11.5' Lt. of @ Sta. 1041+00
 18" I-8 @ Pipe 797.17
 42" I-8 @ Pipe 795.17
 8" I-2 798.00

(D) DRAINAGE

REF. NO.	STATION	STATION		SODDING
		FROM	TO	
1-D	1040+00	1041+50	98	
2-D	1040+52	1043+00	73	
3-D	1039+50	1040+38	63	
4-D	1039+00	1040+00	99	
5-D	1040+50	1045+63	10	
6-D	1036+00	1041+00	498	
7-D	1036+00	1040+00	1014	
8-D	1036+00	1046+00	1038	
9-D	1036+00	1046+00	750	
10-D	1036+00	1046+00	250	
11-D	1043+50	1046+00	500	
12-D	1041+00	1046+00		
13-D	1041+00	1046+00		
TOTALS			3602	

(P) PAVEMENT

REF. NO.	STATION	STATION		CONCRETE	AGGREGATE	CURB	MEDIAN	PAVT. TYPE	L.F.	S.Y.
		FROM	TO							
I-7	1036+00	1046+00	1980.0						482	33.3
I-11	1036+00	1046+00	3546.25						207	482
I-12	1036+00	1046+00	889.71						207	482
I-21	1036+00	1046+00							33.3	
TOTALS			3602						482	33.3

(S) STRUCTURES

REF. NO.	STATION	STATION		CONCRETE	STEEL	SODDING	DUMPED ROCK
		FROM	TO				
E-2	1040+96	1041+50	230				
E-3	1040+96	1041+50	14				
S-27	1040+96	1041+50	300				
S-4	1040+96	1041+50	1109				
S-1	1040+96	1041+50	226				
I-10	1040+96	1041+50	9				
I-10	1040+96	1041+50	300				
I-10	1040+96	1041+50	290				

EXCAVATION	44,630	C.Y.
EMBANKMENT	9,939	C.Y.
EMBANKMENT	12,126	C.Y.