

LAKE COUNTY
LAK-I-22.60

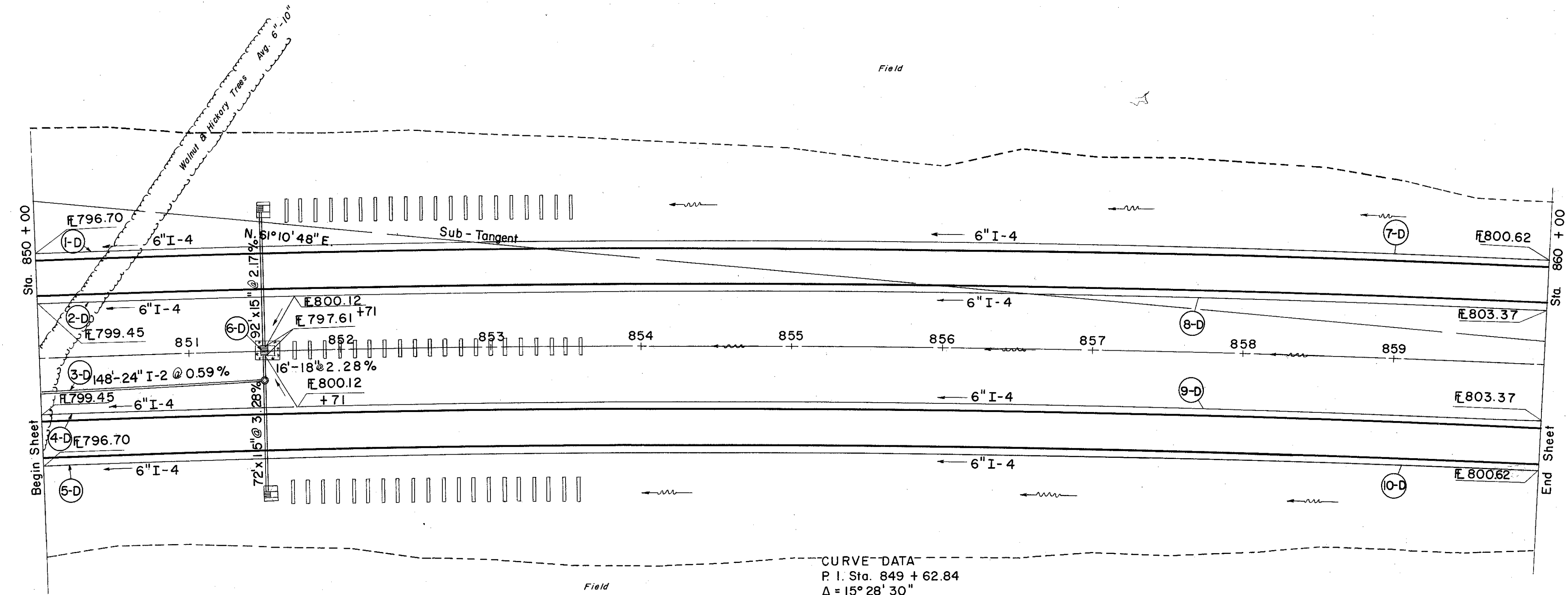

CURVE DATA
P.I. Sta. 849 + 62.84
Δ = 15° 28' 30"
D = 0° 28' 00"
R = 12277.66'
L = 3316.87'
T = 1668.19'
E = 112.83'

B.M. # 92A Lag Bolt in 4" Ash
120' Lt. of Sta. 851+00
Elev. 818.53

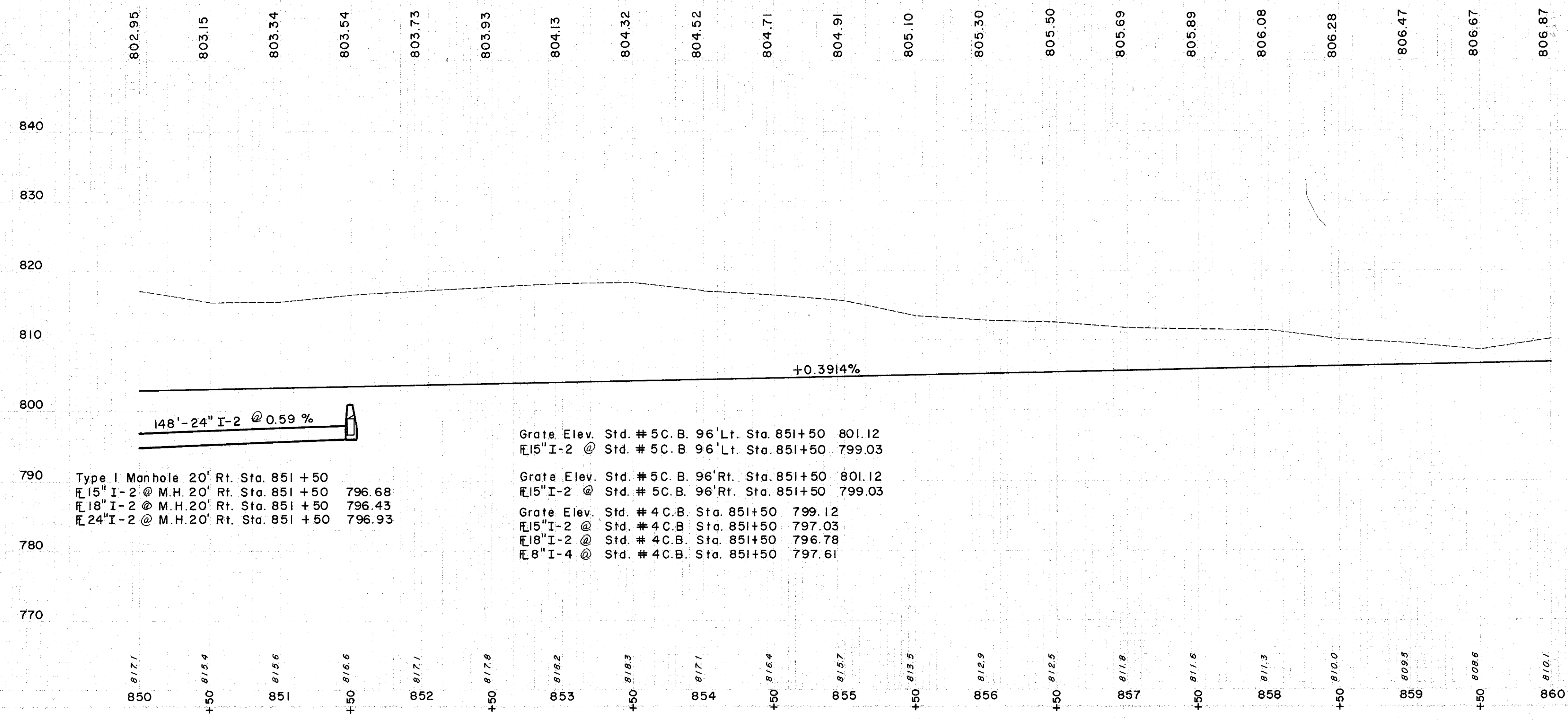

Type I Manhole 20' Rt. Sta. 851 + 50
E 15" I-2 @ M.H. 20' Rt. Sta. 851 + 50 796.68
E 18" I-2 @ M.H. 20' Rt. Sta. 851 + 50 796.43
E 24" I-2 @ M.H. 20' Rt. Sta. 851 + 50 796.93

Grate Elev. Std. # 5C. B. 96' Lt. Sta. 851+50 801.12
E 15" I-2 @ Std. # 5C. B. 96' Lt. Sta. 851+50 799.03
Grate Elev. Std. # 5C. B. 96' Rt. Sta. 851+50 801.12
E 15" I-2 @ Std. # 5C. B. 96' Rt. Sta. 851+50 799.03
Grate Elev. Std. # 4C. B. Sta. 851+50 799.12
E 15" I-2 @ Std. # 4C. B. Sta. 851+50 797.03
E 18" I-2 @ Std. # 4C. B. Sta. 851+50 796.78
E 8" I-4 @ Std. # 4C. B. Sta. 851+50 797.61

DRAINAGE * TO BE INCLUDED IN LAK - I - 22.43 AND NOT A PART OF THIS CONTRACT.

REF. STATION NO.	FROM	TO	SIDE OR	STORM SEWER SEC. M-6.5(a) OR SEC. M-6.8(g) OR SEC. M-6.8(h)	15" CL. "A" SEWER UNDER PAVT. OR SEC. M-6.5(b) OR SEC. M-6.8(i)	6" PIPE UNDER DRAIN SHALLOW FT.	6" PIPE UNDER DRAIN DEEP FT.	6" PIPE UNDER OUTLET PIPE M-6.4(g)	I-4 6" PIPE UNDER 60° BEND	I-5 6" PIPE UNDER 60° BEND	I-8 STD.#4 CATCH BASIN	I-10 STD.#5 CATCH BASIN	L-10 STD.#1 SODDING M.H.	S. Y.
** 1-D	850+00	858+16	7/LL			853	816	10						
** 2-D	850+00	858+16	5/LL			853	816	10						
** 3-D	850+00	851+50	CL	148		853	816	10						
** 4-D	850+00	858+16	5/RL			853	816	10						
** 5-D	850+00	858+16	7/RL			853	816	10						
** 6-D	851+50	851+50	CL	16	16.4	184	184				2		161	
** 7-D	858+16	860+00	7/LL			184	184							
** 8-D	858+16	860+00	3/LL			184	184							
** 9-D	858+16	860+00	3/RL			184	184							
** 10-D	858+16	860+00	7/RL			184	184							

EXCAVATION	=	95,019 C.Y.
EMBANKMENT	=	0 C.Y.
EMBANKMENT + 22 %	=	0 C.Y.