

LAKE COUNTY
LAK - I - 22.60

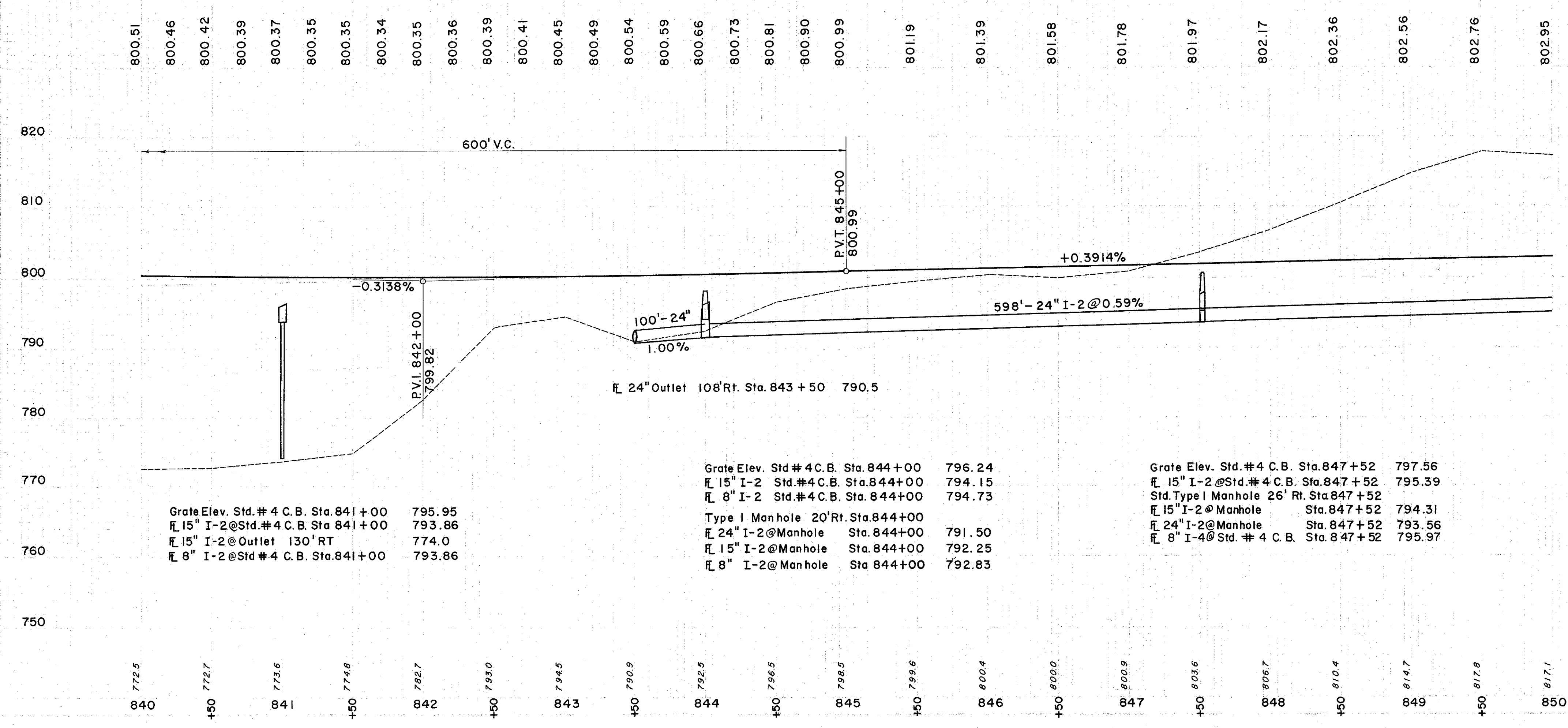
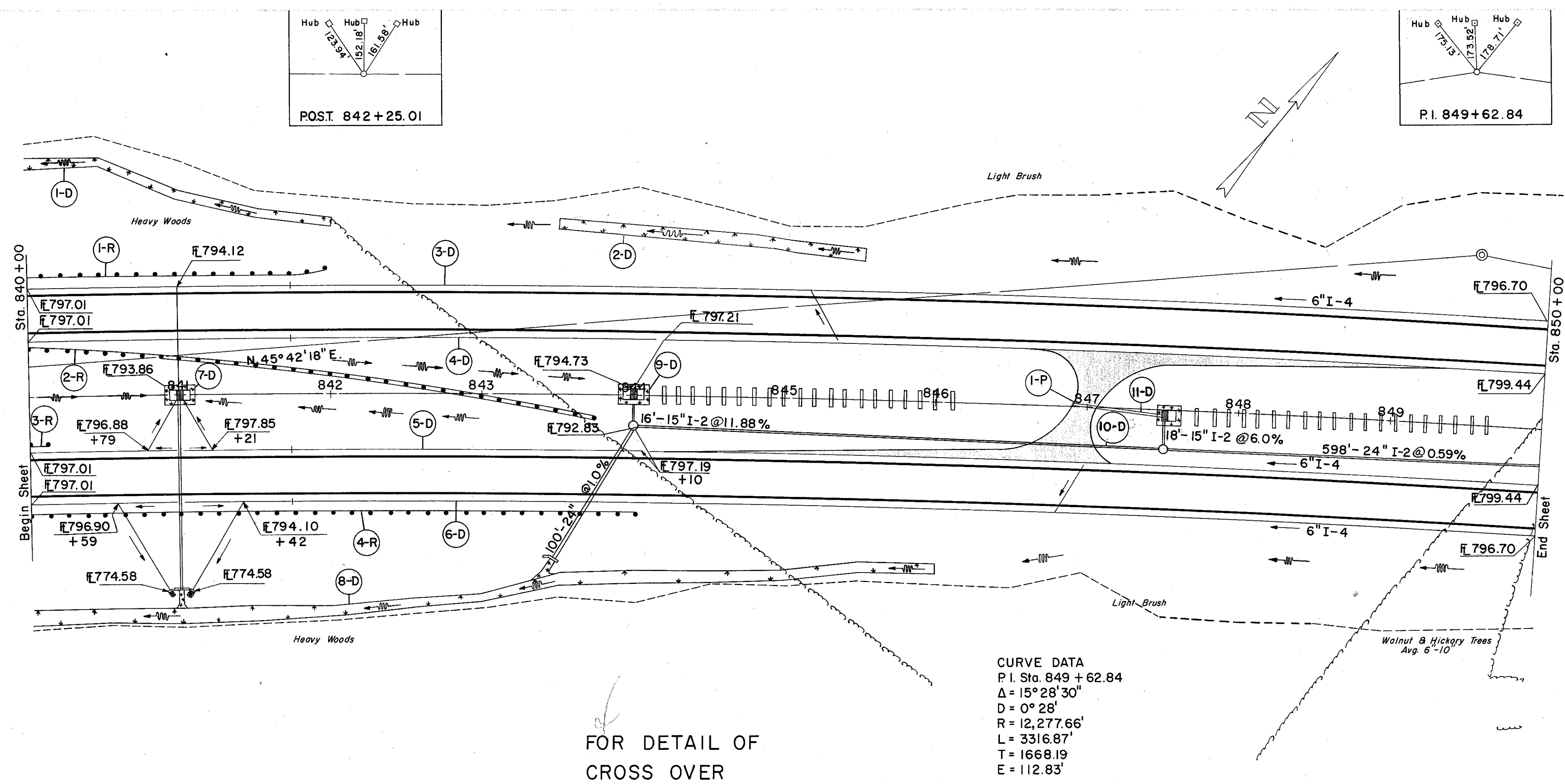

* DRAINAGE * TO BE INCLUDED IN LAK - I - 22.43 AND NOT A PART OF THIS CONTRACT

REF. NO.	STATION	SIDE OR STRUCT.	EXCAV. FOR STRUCT. C.Y.	CLASS A STORM SEWER UNDER PAVEMENT SEC. M-6.5(b) OR SEC. M-6.8(b)	STORM SEWER SEC. M-6.5(g)	15" STORM 8" SEWER OUTLET PIPE SEC. M-6.4(c)	6" PIPE UNDER DRAIN DEEP	6" PIPE 8" UNDER DRAIN SHALLOW	6" I-4 OUTLET PIPE SEC. M-6.4(g)	6" 60° WYE	6" 60° BEND	6" x 8" INCREASER M-6.8(b)	6" x 8" DOUBLE TEE M-6.8(b)	15" 30° BENDS NO. 2-B	STD. #4 CATCH BASIN	STD. #4 M.H.	L-10 SODDING	S-1 CONC. FOR STRUCT. CLASS C	S-4 REINF. STEEL LBS.	S-29 DRAINAGE OF STRUCT. NO. 2 AGGR. C.Y.	
																					FROM
*1-D	840+00	RT																			
*2-D	843+50	LT																			
*3-D	845+00	LT																			
*4-D	840+00	RT																			
*5-D	840+00	RT																			
*6-D	840+00	RT																			
*7-D	841+00	RT																			
*8-D	840+00	RT																			
*9-D	843+50	RT																			
*10-D	844+00	RT																			
*11-D	846+90	RT																			
TOTAL																					
EACH																					
S.Y.																					
C.Y.																					

(R) ROADWAY

REF. NO.	STATION	SIDE	I-15 GUARD RAIL BARRIER	
			RAIL TYPE	BEAM TYPE
1-R	840+00	LT	200	287.5
2-R	840+00	RT	12.5	87.5
3-R	840+00	RT	400	700
4-R	840+00	RT	400	700
TOTAL			700	287.5

(S) SODDING - LEFT DITCH

STATION	DEPTH OF SODDING, FT.	SLOPES		WIDTH OF SODDING, FT.	S.Y.
		F	B		
840+00	0.45	4:1	4:1	7.5	161
842+00	0.35	4:1	4:1	7.0	178
843+50	0.3	4:1	6:1	9.0	584
845+50	0.35	8:1	6:1	9.0	
TOTAL					584

(P) PAVEMENT

REF. NO.	STATION	SIDE	E-101 B-33 BIT. MAT. L. AGGR.		T-31 T-31 BIT. NO. 46 MAT. L. AGGR.				
			SUBGR.	S.Y.	GAL.	C.Y.	S.Y.	C.Y.	
1-P	847+00	LT	473	473	236.5	3.8	3.8	66.0	81.4

EXCAVATION	= 29,763 C.Y.
EMBANKMENT	= 52,472 C.Y.
EMBANKMENT + 22 %	= 64,016 C.Y.