

LAKE COUNTY
LAK - 90 - 21.51

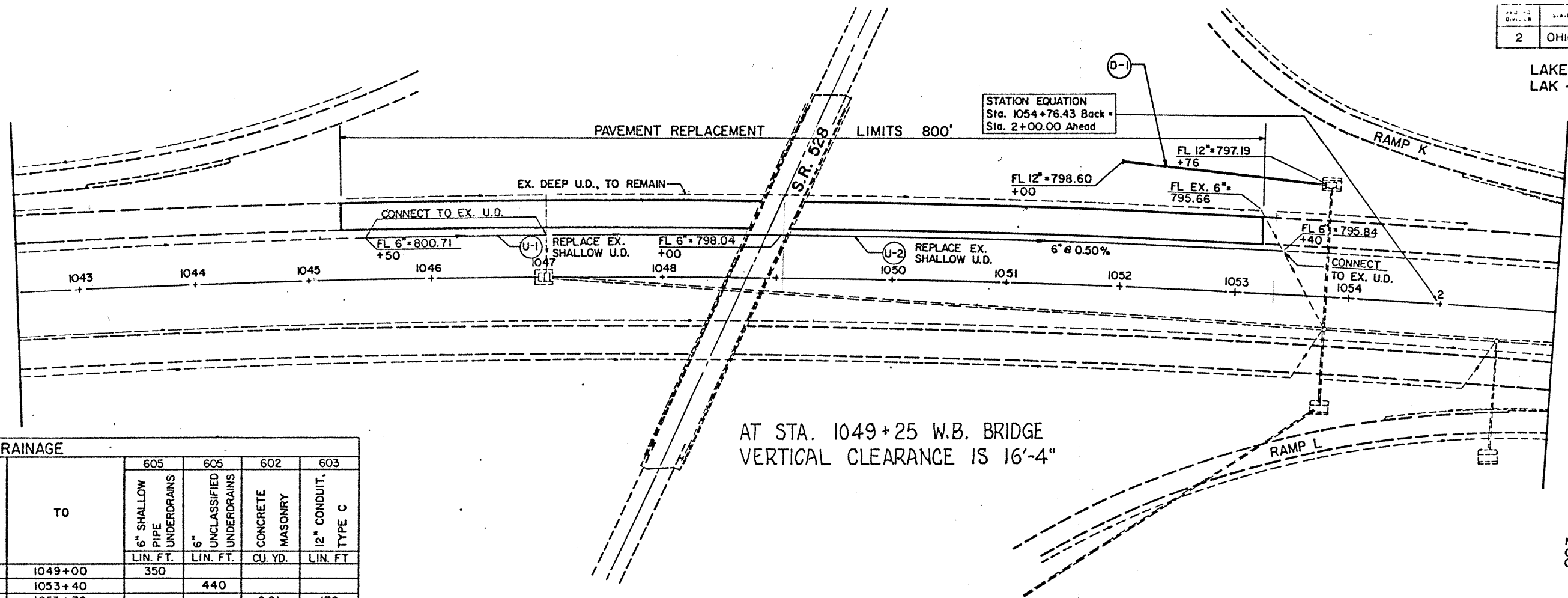

AT STA. 1049+25 W.B. BRIDGE
VERTICAL CLEARANCE IS 16'-4"

NOTE: GUARDRAIL WORK SHOWN ON ROADWAY PLAN

DRAINAGE						
REFERENCE	FROM	TO	605	605	602	603
			6" SHALLOW PIPE UNDERDRAINS	6" UNCLASSIFIED UNDERDRAINS	CONCRETE MASONRY	12" CONDUIT, TYPE C
			LIN. FT.	LIN. FT.	CU. YD.	LIN. FT.
U-1	1045+50	1049+00	350			
U-2	1049+00	1053+40		440		
D-1	1052+00	1053+76			0.21	176
TOTALS			350	440	0.21	176

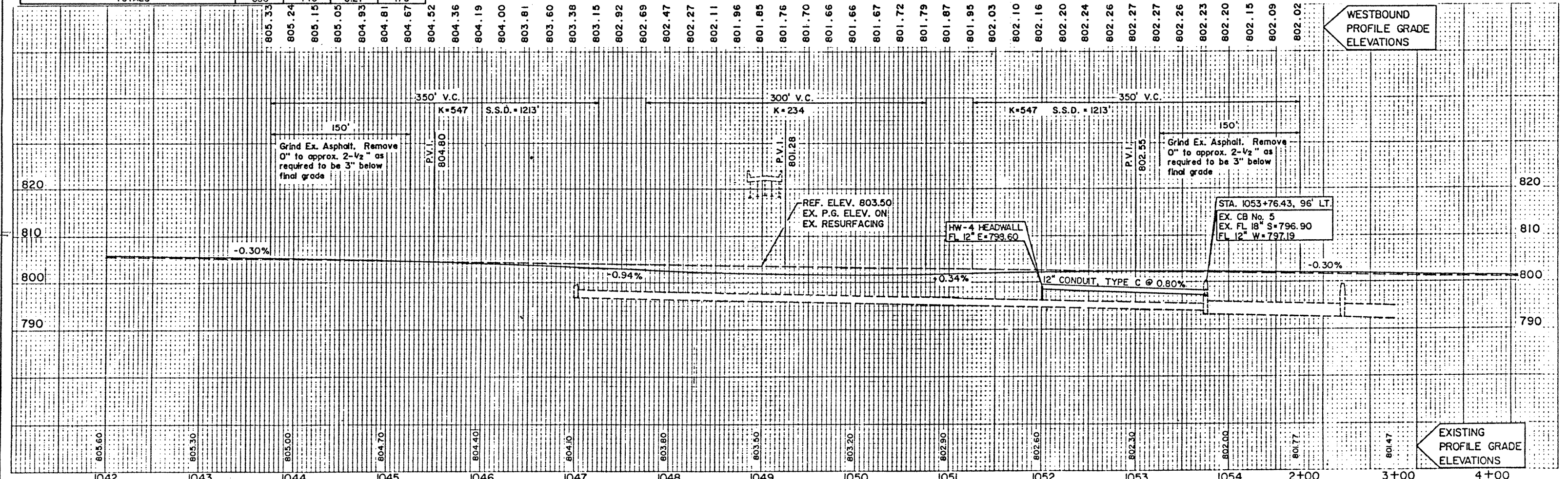

PAVEMENT LOWERING WESTBOUND, STA. 1042+50 TO STA. 3+00 (Ahead)