

MICROFILMED  
APR 6 1988

Dumped Rock Channel Protection  
on cut face to Elev. 669.0'  
2'-6" Thick

EXISTING BRIDGES

UP STREAM: 1.0 Mile  
TYPE: Pony Truss  
ROADWAY: Cl. 21.8'  
SPAN: 64'-0"

DOWN STREAM: 1/2 Mile  
TYPE: Pony Truss  
ROADWAY: Cl. 20'  
SPAN: 67'-0"

FOUNDATION SOUNDINGS: Foundation design and foundation quantities are based on a study of rod sounding, and soil sampling soundings made at the site.  
This sounding information may be inspected in the Interstate Project Office or in the Division Office but the State does not guarantee the accuracy thereof.

FED. RD. DIVISION	STATE	PROJECT
2	OHIO	ACI-1103 (27)

385  
413

LAKE COUNTY  
SEC. LAK -I- 16.55

CURVE DATA  
P.I. Sta. 656+14.21  
 $\Delta = 28^\circ - 46'$   
 $D = 0^\circ - 36'$   
R = 9549.30  
T = 2448.88  
L = 4794.44  
E = 309.02

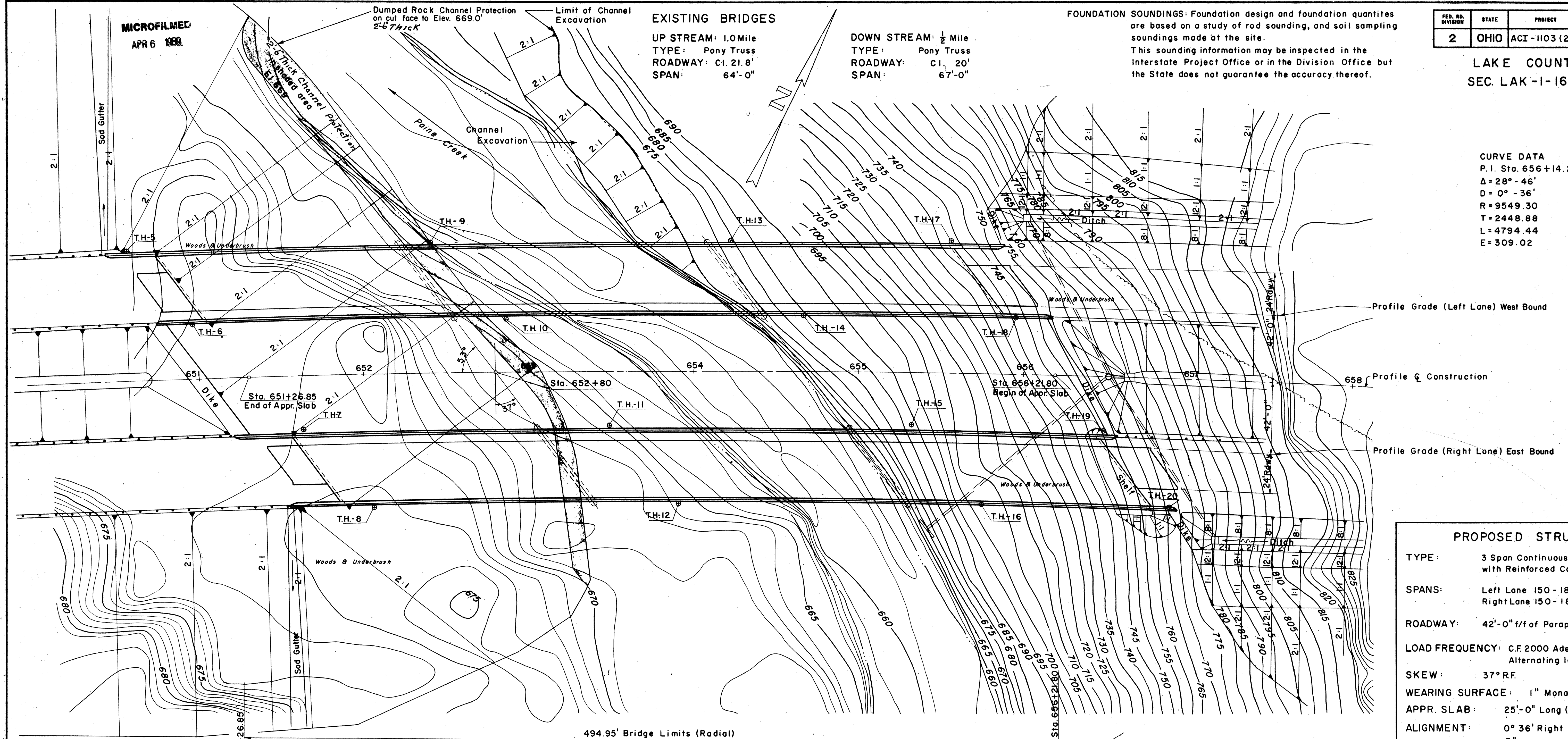

**PROPOSED STRUCTURES**

TYPE: 3 Span Continuous Plate Girder with Reinforced Concrete Deck

SPANS: Left Lane 150'-188'-150'  
Right Lane 150'-188'-150'

ROADWAY: 42'-0" f/f of Parapets

LOAD FREQUENCY: C.F. 2000 Adequate for A.A.S.H.O. Alternating loading

SKREW: 37° R.F.

WEARING SURFACE: 1" Monolithic Conc.

APPR. SLAB: 25'-0" Long (AS-1-54)

ALIGNMENT: 0° 36' Right

SUPERELEVATION: 3/16" per ft.

50 Year High Water 3,470 cfs.  
Drainage Area 25.5 Sq. Mi.

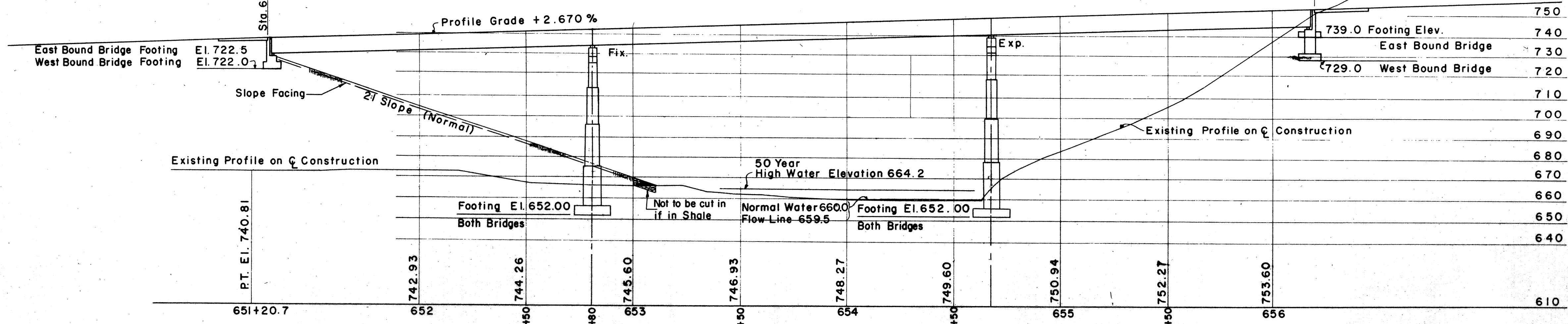

750	B.M. #72A Lag Bolt in base of Tri. Maple
740	150' Rt. of Sta. 650+00
730	Elev. 684.81
720	B.M. #73A Lag Bolt in root of 18" Oak
710	150' Lt. of Sta. 655+65
700	Elev. 744.80
690	B.M. #74A Lag Bolt in root of 12" Cherry
680	157' Rt. of Sta. 669+25
670	Elev. 837.22
660	
650	
640	

PREPARED BY  
CAPITOL ENGINEERING ASSOCIATES, DILLSBURG, PA.  
FOR

STATE OF OHIO  
DEPARTMENT OF HIGHWAYS

SITE PLAN  
BRIDGE NO. LAK-I-1905  
S.R.I. OVER PAINE CREEK  
LAKE COUNTY  
STA. 654+75.00

DESIGNED	DRAWN	TRACED	CHECKED	REVISED - DATE	REVISED
LLD	LLD	LL			6-2-58