

9-M

W-5

FED. RD. DIVISION	STATE	PROJECT	368 413
2	OHIO	ACI-1103(27)	

LAKE COUNTY
LAK-1-16.55
LAK-90-19.21

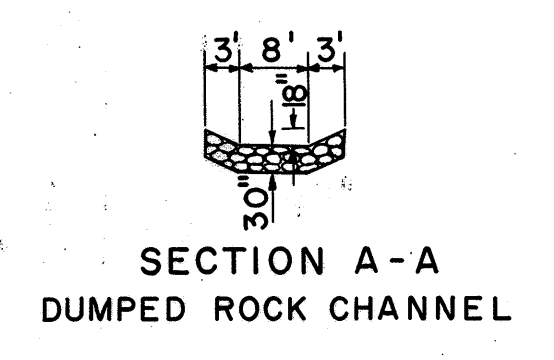
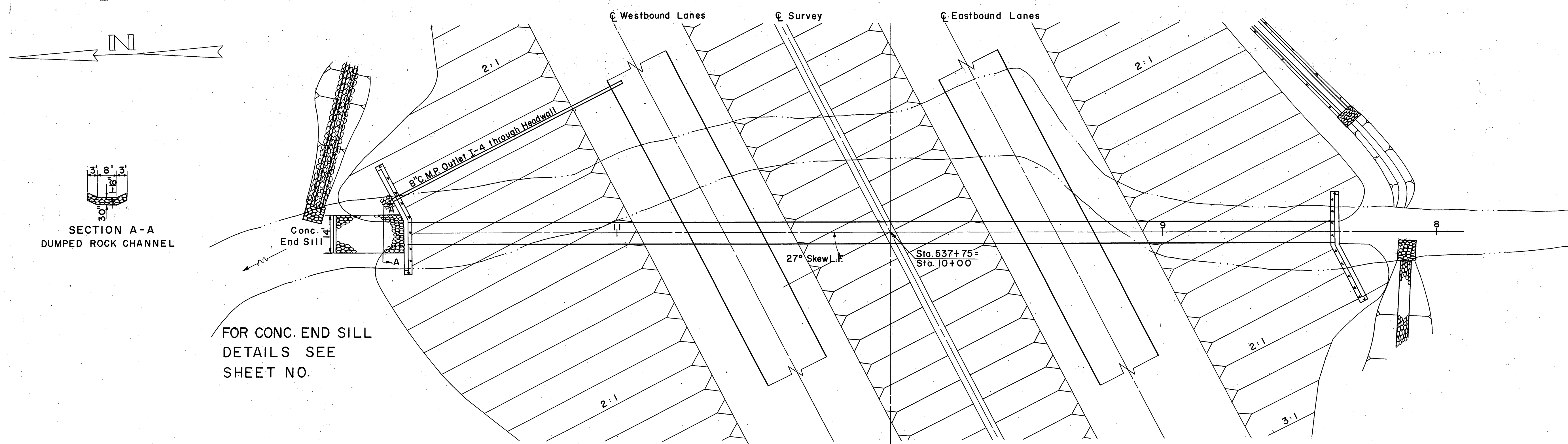

FOR CONC. END SILL
DETAILS SEE
SHEET NO.

AREA = 900 ACRES
Q50 = 580 C.F.S.

SCALE: 1" = 20'-0"

HEADWATER = 10.64 FT.
OUTLET VELOCITY = 14.5 FPS.

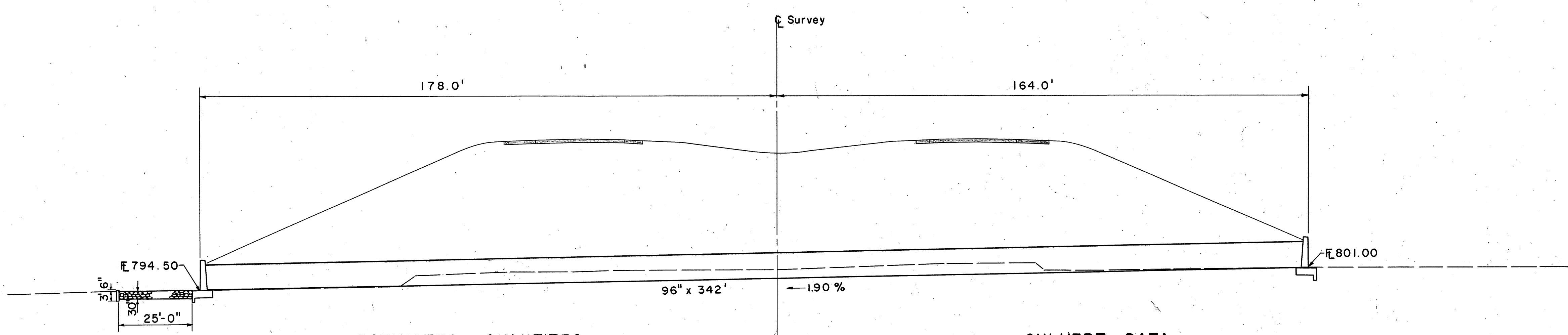
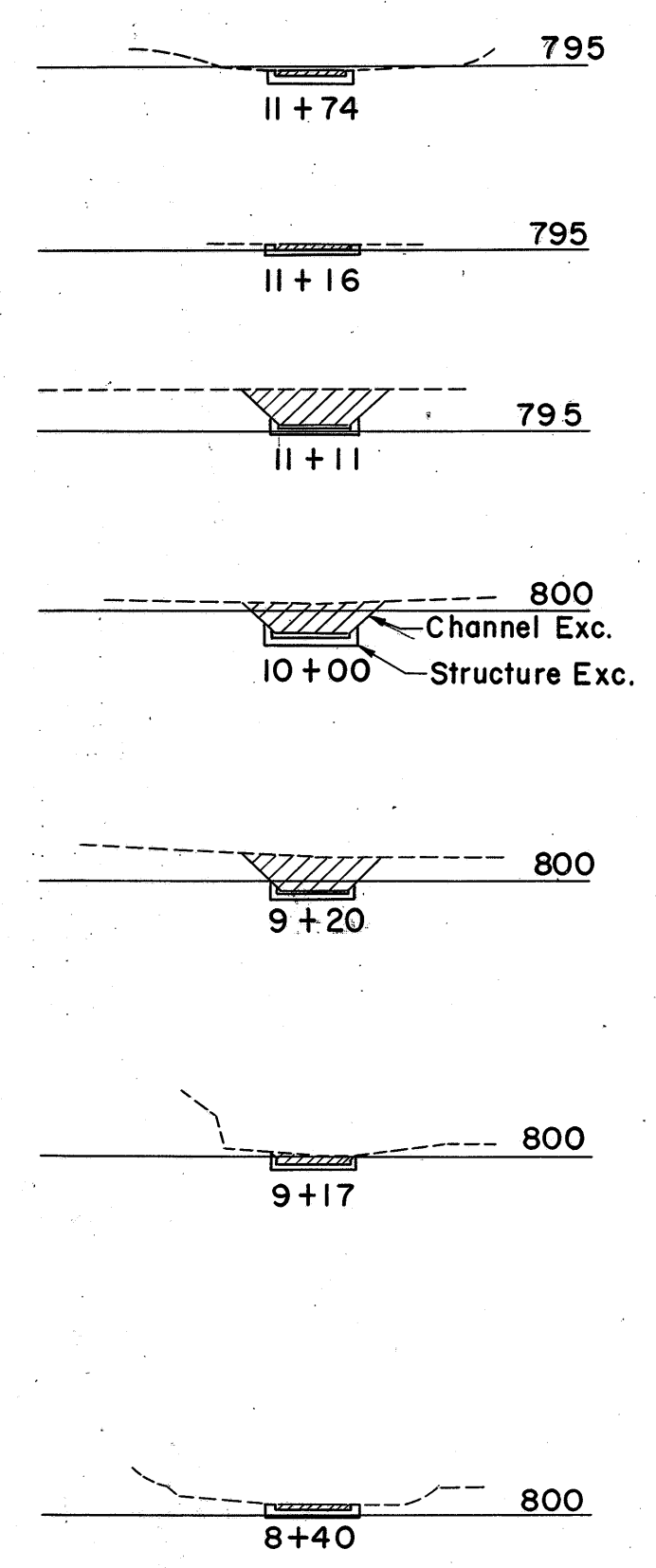

ESTIMATED QUANTITIES

E-2	Excavation for Structures	141 C.Y.
S-1	Concrete for Structure Class C	93.6 C.Y. (End Sill Conc. 2.0 C.Y. Inc.)
S-28	96" Pipe for Roadway Culvert	342 L.F.
L-10	Sodding	1.54 S.Y.
S-4	Reinforcing Steel	4074 Lb.
I-10	Dumped Rock Channel Protection	33 C.Y.
E-3	Channel Excavation	341 C.Y.

CULVERT DATA

TYPE: Pipe Culvert S-28 M-6.4 g 7-5 Gage Type B Hdws.
SIZE: 96" x 342'
WORK REQ'D: Build a pipe culvert with type B Hdws.
Place dumped rock at outlet as shown with concrete End Sill.
Provide Outlet for 8" C.M.P. I-4 through Lt. Headwall.

STRUCTURE NO LAK-1-1689

PIPE CULVERT STA 537+75