

SEEDING
END WIDTH
SQ. YDS.

LAKE COUNTY
LAK-1-16.55

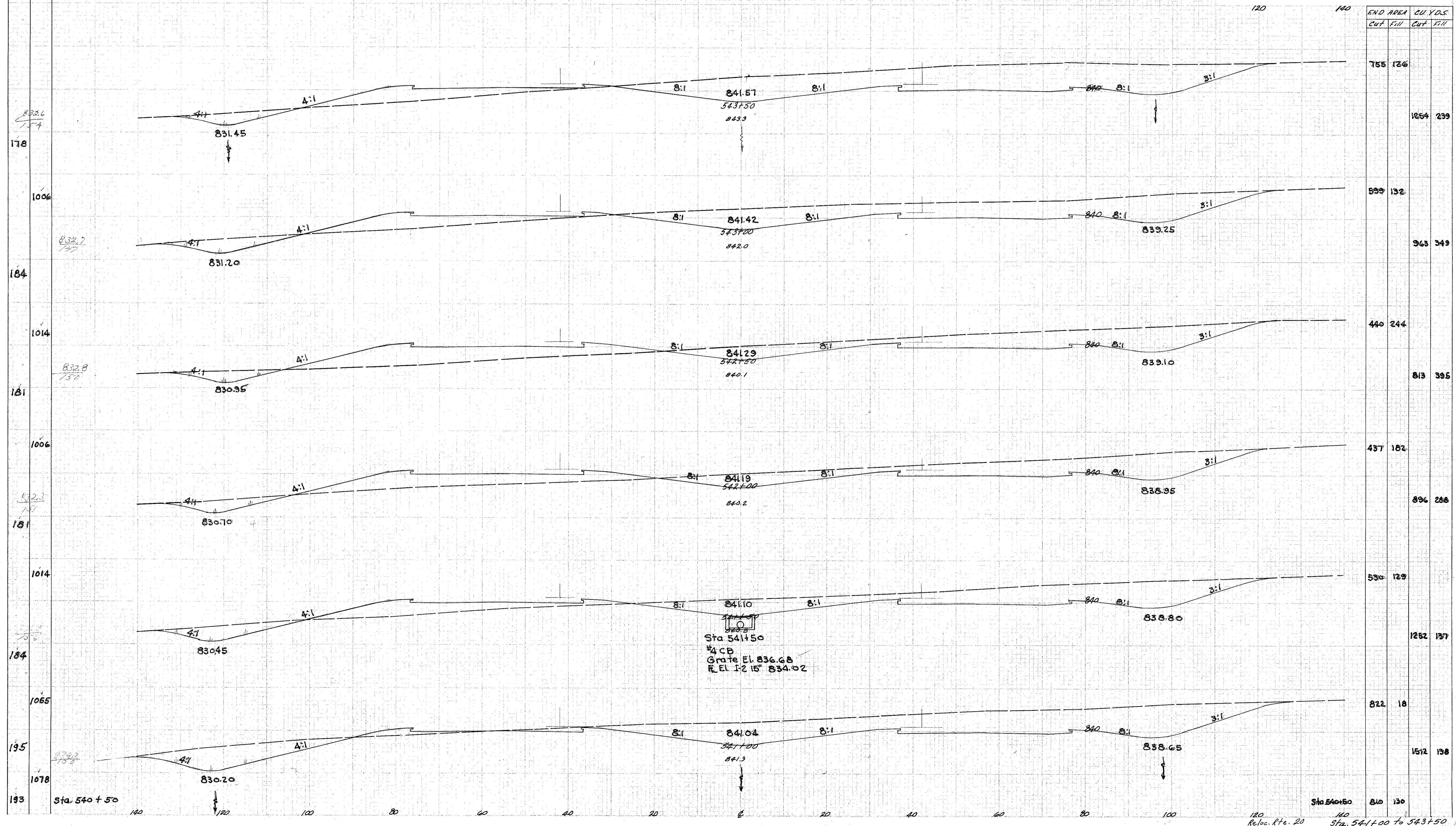

Sta. 541+50
1/2 CB
Grate El. 836.68
R. El. 12' 15" 834.02

832.6
177

832.7
177

832.8
177

832.3
177

832.4
177

832.2
177

Sta. 540+50

Sta. 540+50

Reloc. Rte. 20
Sta. 541+00 to 543+50