

LAKE COUNTY
LAK-1-16.55

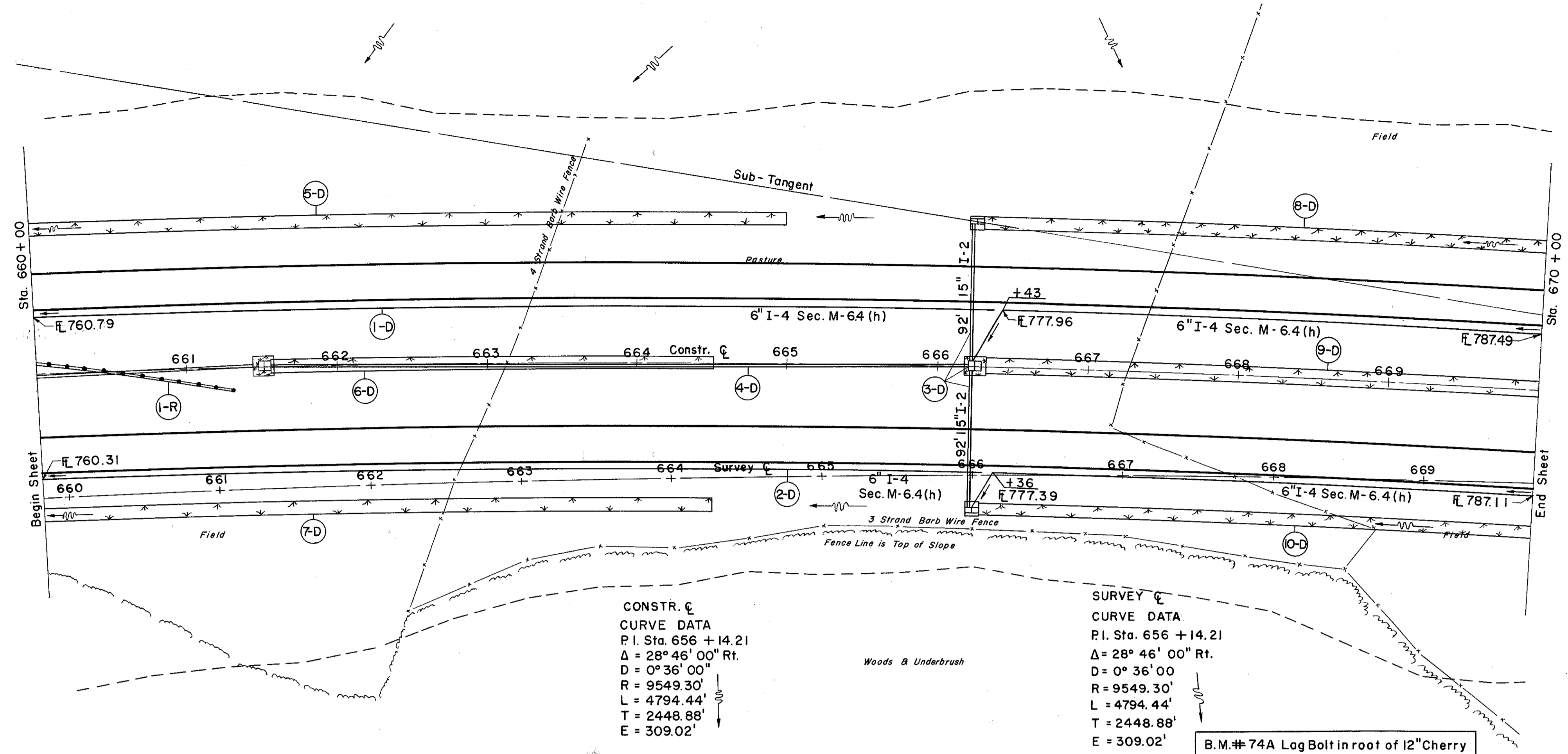

CONSTR. CURVE DATA
 P.I. Sta. 656 + 14.21
 $\Delta = 28^\circ 46' 00''$ Rt.
 $D = 0^\circ 36' 00''$
 $R = 9549.30'$
 $L = 4794.44'$
 $T = 2448.88'$
 $E = 309.02'$

SURVEY CURVE DATA
 P.I. Sta. 656 + 14.21
 $\Delta = 28^\circ 46' 00''$ Rt.
 $D = 0^\circ 36' 00''$
 $R = 9549.30'$
 $L = 4794.44'$
 $T = 2448.88'$
 $E = 309.02'$

B.M.# 74A Lag Bolt in root of 12" Cherry
 157' Rt. of Sta. 669 + 25
 Elev. 837.22

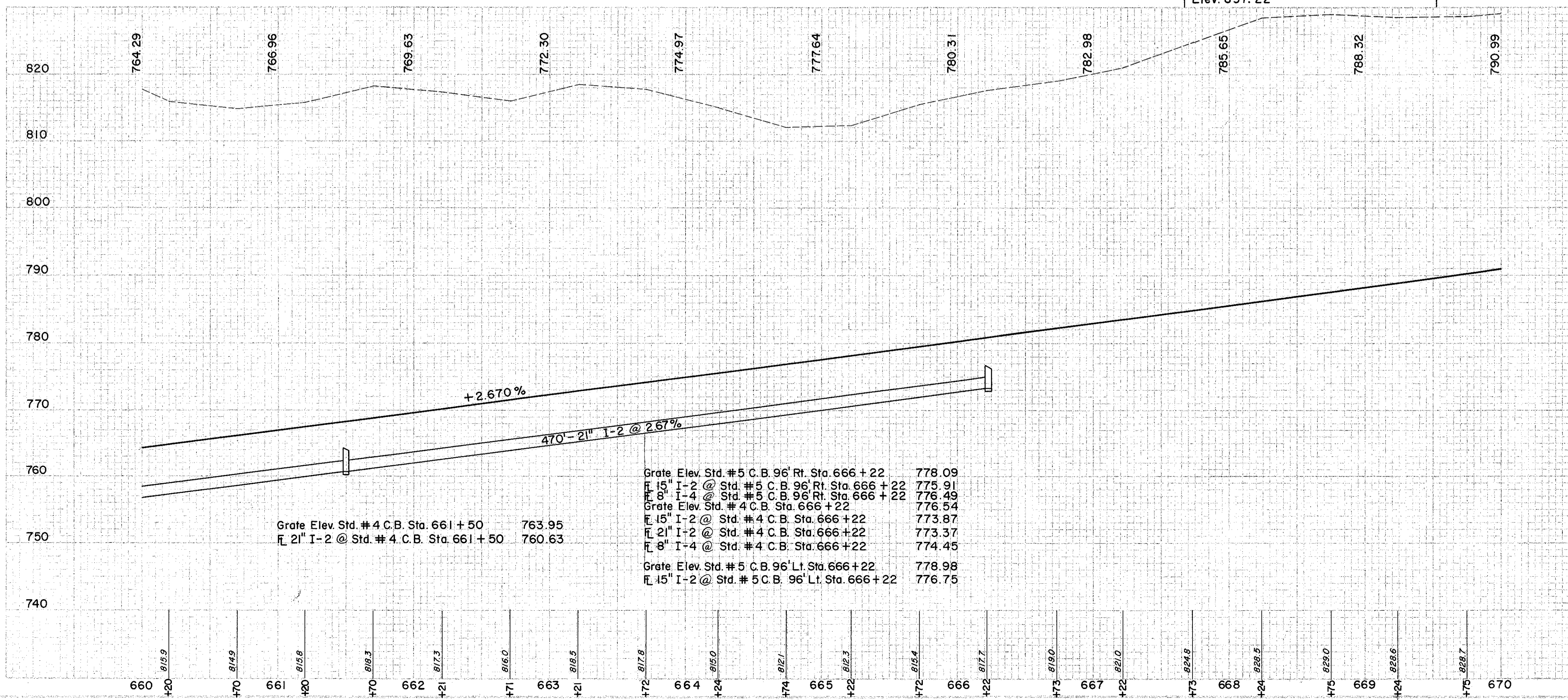

Grate Elev. Std. #4 C.B. Sta. 661 + 50 763.95
 2" I-2 @ Std. #4 C.B. Sta. 661 + 50 760.63

Grate Elev. Std. #5 C.B. 96' Rt. Sta. 666 + 22 778.09
 15" I-2 @ Std. #5 C.B. 96' Rt. Sta. 666 + 22 775.91
 8" I-4 @ Std. #5 C.B. 96' Rt. Sta. 666 + 22 776.49
 Grate Elev. Std. #4 C.B. Sta. 666 + 22 776.54
 15" I-2 @ Std. #4 C.B. Sta. 666 + 22 773.87
 21" I-2 @ Std. #4 C.B. Sta. 666 + 22 773.37
 8" I-4 @ Std. #4 C.B. Sta. 666 + 22 774.45
 Grate Elev. Std. #5 C.B. 96' Lt. Sta. 666 + 22 778.98
 15" I-2 @ Std. #5 C.B. 96' Lt. Sta. 666 + 22 776.75

① DRAINAGE

REF. NO.	STATION	SIDE	SLOPES		WIDTH	LENGTH	S.Y.	I-2 CL. A STORM SEWER UNDER PAV. SEC. M-6.4(h) SEC. M-6.4(h)	I-4 8" CMP UNDER- OUTLET PIPE SEC. M-6.4(h) SEC. M-6.4(h)	I-5 6" BEND CATCH- BASIN SEC. M-6.4(h)	I-8 STD. #5 CATCH- BASIN	L-10 STD. #4 CATCH- BASIN	S.Y.
			F	B									
1-D	660+00	LT	8:1	8:1	9.5	450	475						
2-D	660+00	RT	8:1	8:1	9.5	450	475						
3-D	666+22	CL	8:1	8:1	8.0	378	329						
4-D	660+00	CL	8:1	8:1	8.0	378	329						
5-D	660+00	LT	8:1	8:1	8.0	378	329						
6-D	660+00	RT	8:1	8:1	8.0	378	329						
7-D	660+00	LT	8:1	8:1	8.0	378	329						
8-D	666+22	LT	8:1	8:1	8.0	378	329						
9-D	666+22	RT	8:1	8:1	8.0	378	329						
10-D	666+22	CL	8:1	8:1	8.0	378	329						
							SUBTOTAL	804					
							SODDING MEDIAN						
661+50	0.3		8:1	8:1	9.0	400	400						
664+50			8:1	8:1	9.0	378	407						
666+22	0.4		8:1	8:1	10.5	378	407						
670+00	0.3		8:1	8:1	8.8	378	407						
							SUBTOTAL	807					
							SODDING LEFT DITCH						
660+00	0.4		8:1	3:1	8.0	500	403						
665+00	2.3		8:1	3:1	6.5	378	271						
666+22	2.7		8:1	2:1	6.7	378	271						
670+00	2.2		8:1	2:1	6.2	378	271						
							SUBTOTAL	674					

Ⓡ ROADWAY

REF. NO.	STATION	SIDE	RAIL STEEL BEAM TYPE	DEPTH
1-R	660+00	RT	DEEPNO.2-B	125

SODDING RIGHT DITCH

STATION	DEPTH	SLOPES	WIDTH	LENGTH	S.Y.	
660+00	0.5	8:1	3:1	9.5	450	
664+50		8:1	3:1	9.5	450	
666+22	0.4	8:1	2:1	8.0	378	
670+00		8:1	2:1	8.0	378	
					SUBTOTAL	804
SODDING MEDIAN						
661+50	0.3	8:1	8:1	9.0	400	
664+50		8:1	8:1	9.0	400	
666+22	0.4	8:1	8:1	10.5	407	
670+00	0.3	8:1	8:1	8.8	407	
					SUBTOTAL	807
SODDING LEFT DITCH						
660+00	0.4	8:1	3:1	8.0	500	
665+00	2.3	8:1	3:1	6.5	378	
666+22	2.7	8:1	2:1	6.7	378	
670+00	2.2	8:1	2:1	6.2	378	
					SUBTOTAL	674

EXCAVATION = 438,519 C.Y.
 EMBANKMENT = 0 C.Y.
 EMBANKMENT - 22' = 0 C.Y.