

LAKE COUNTY
LAK-1-16.55

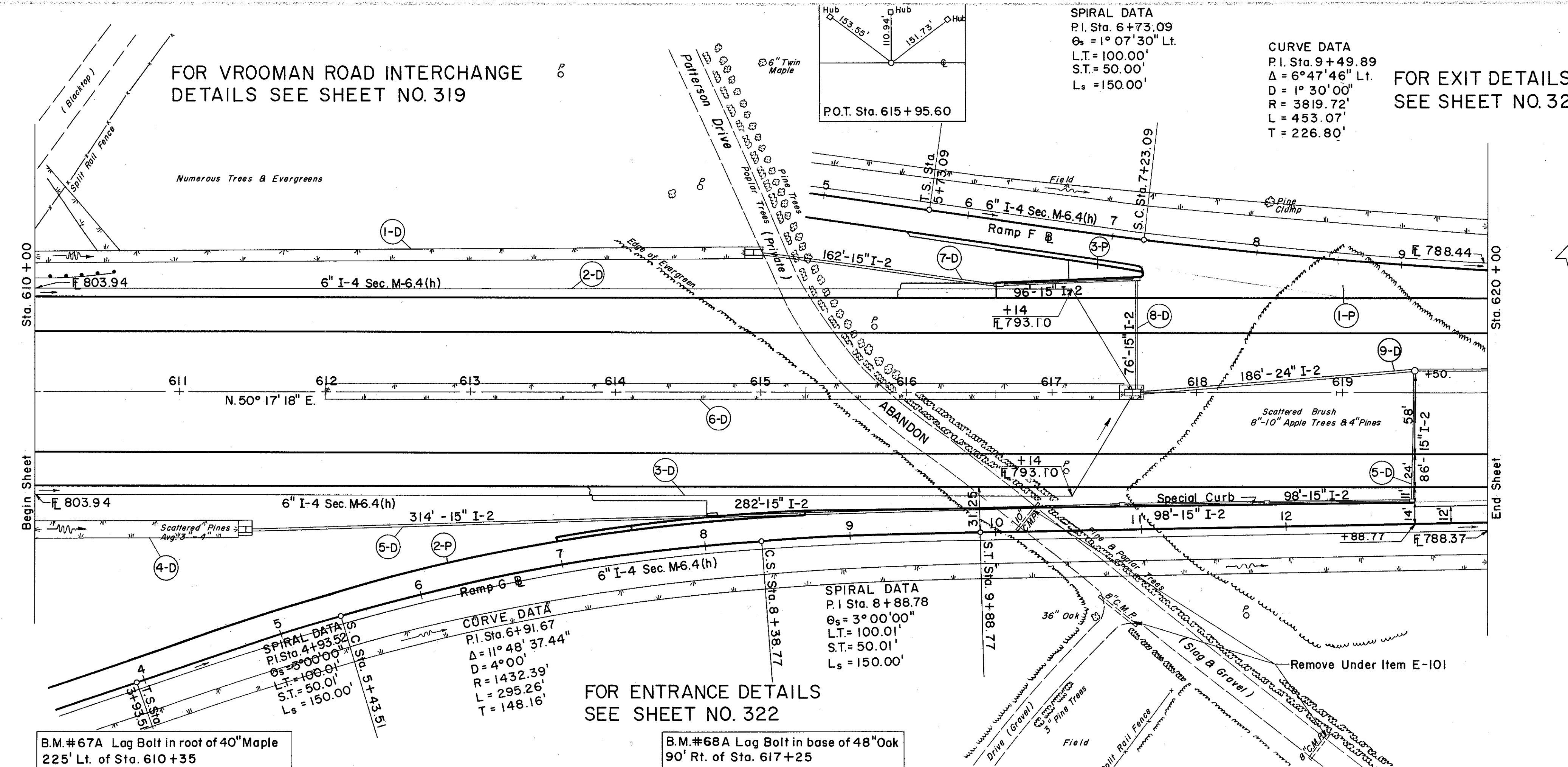

FOR VROOMAN ROAD INTERCHANGE
DETAILS SEE SHEET NO. 319

FOR EXIT DETAILS
SEE SHEET NO. 321

FOR ENTRANCE DETAILS
SEE SHEET NO. 322

B.M.#67A Lag Bolt in root of 40" Maple
225' Lt. of Sta. 610+35
Elev. 813.13

B.M.#68A Lag Bolt in base of 48" Oak
90' Rt. of Sta. 617+25
Elev. 834.67

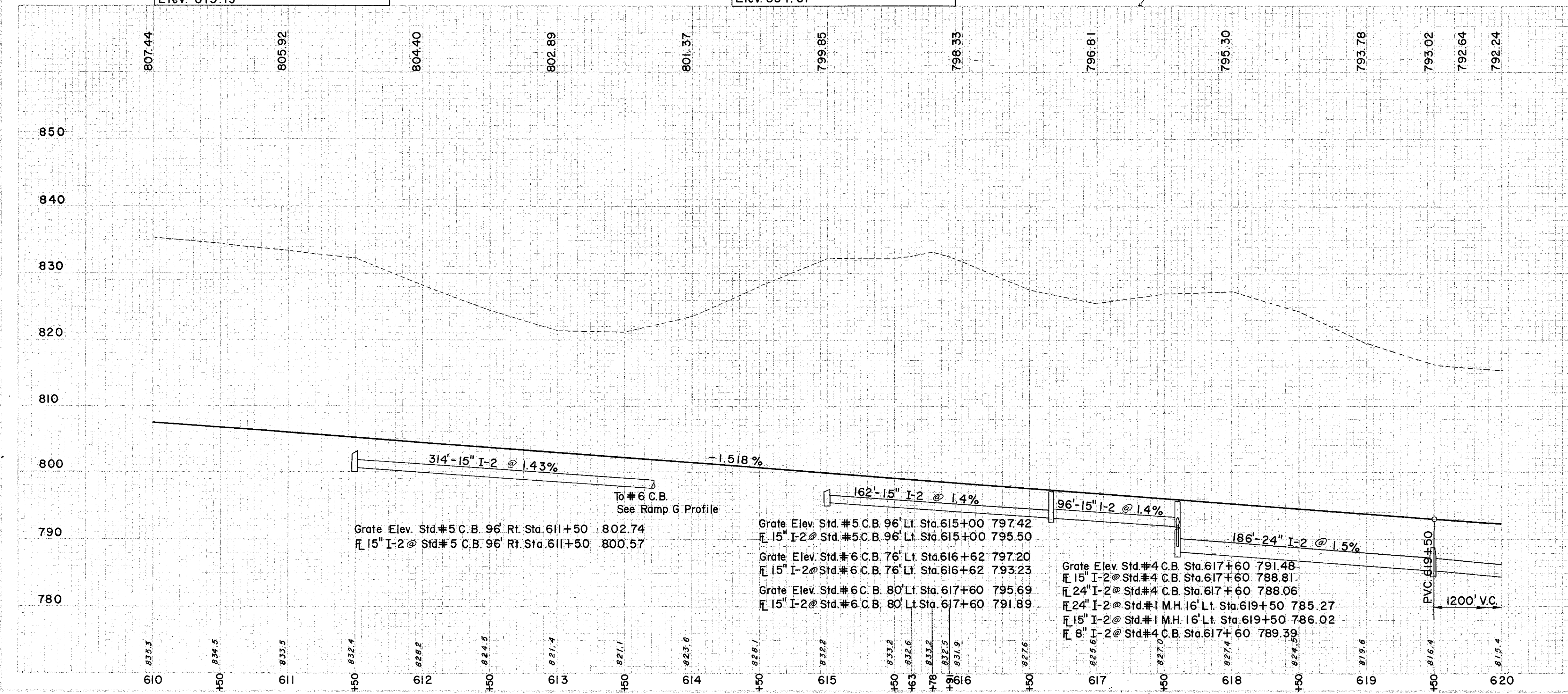

(D) DRAINAGE

REF. NO.	STATION	FROM TO	SODDING LEFT DITCH		SODDING RIGHT DITCH		SODDING MEDIAN	TOTAL
			DEPTH OF SODDING FT.	WIDTH OF SODDING FT.	DEPTH OF SODDING FT.	WIDTH OF SODDING FT.		
I-D	610+00	615+00	5	8.1	5	8.1	155	155
I-D	615+00	617+60	4	8.1	4	8.1	650	650
I-D	617+60	620+00	1	15	1	15	484	484
TOTAL								

REF. NO.	STATION	FROM TO	DEPTH OF SODDING FT.	WIDTH OF SODDING FT.	S.Y.
I-P	616+61.07	620+00	25.9	13.0	0.2
2-P	3+93.51	620+00	123.01	615.1	9.8
3-P	617+110.71	617+61.07	125.60	62.81	10.0
TOTAL					

EXCAVATION = 324,446 C.Y.
EMBANKMENT = 0 C.Y.
TOTAL = 22 @ 0 C.Y.

REF. NO.	STATION	FROM TO	DEPTH OF SODDING FT.	WIDTH OF SODDING FT.	S.Y.
I-P	616+61.07	620+00	25.9	13.0	0.2
2-P	3+93.51	620+00	123.01	615.1	9.8
3-P	617+110.71	617+61.07	125.60	62.81	10.0
TOTAL					