

LAKE COUNTY
LAK-1-16.55

UTILITY COMPANIES
The Ohio Bell Telephone Co.
820 West Superior Ave.
Cleveland 13, Ohio
The Cleveland Electric Illuminating Co.
4737 Main Ave.
Ashtabula, Ohio

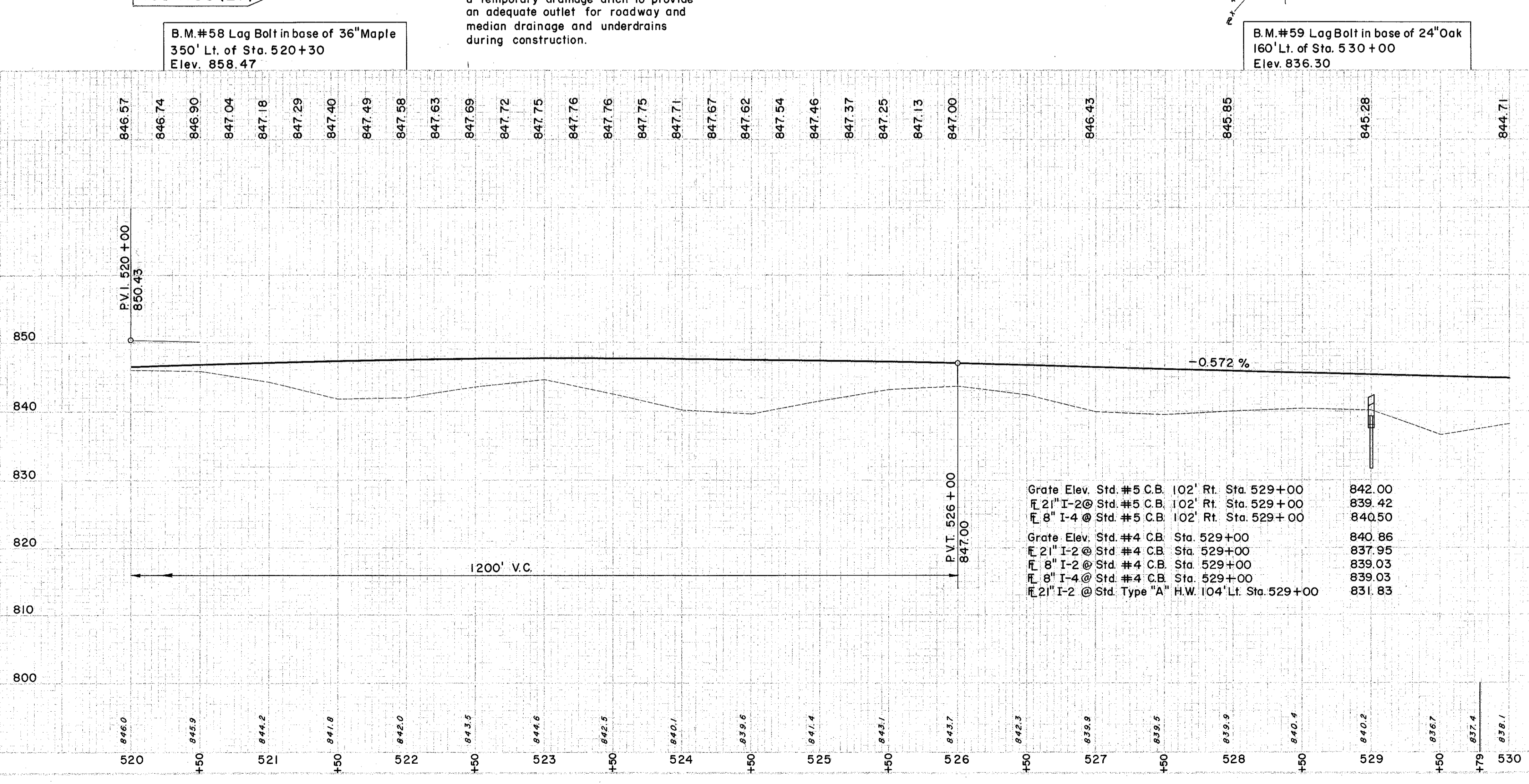
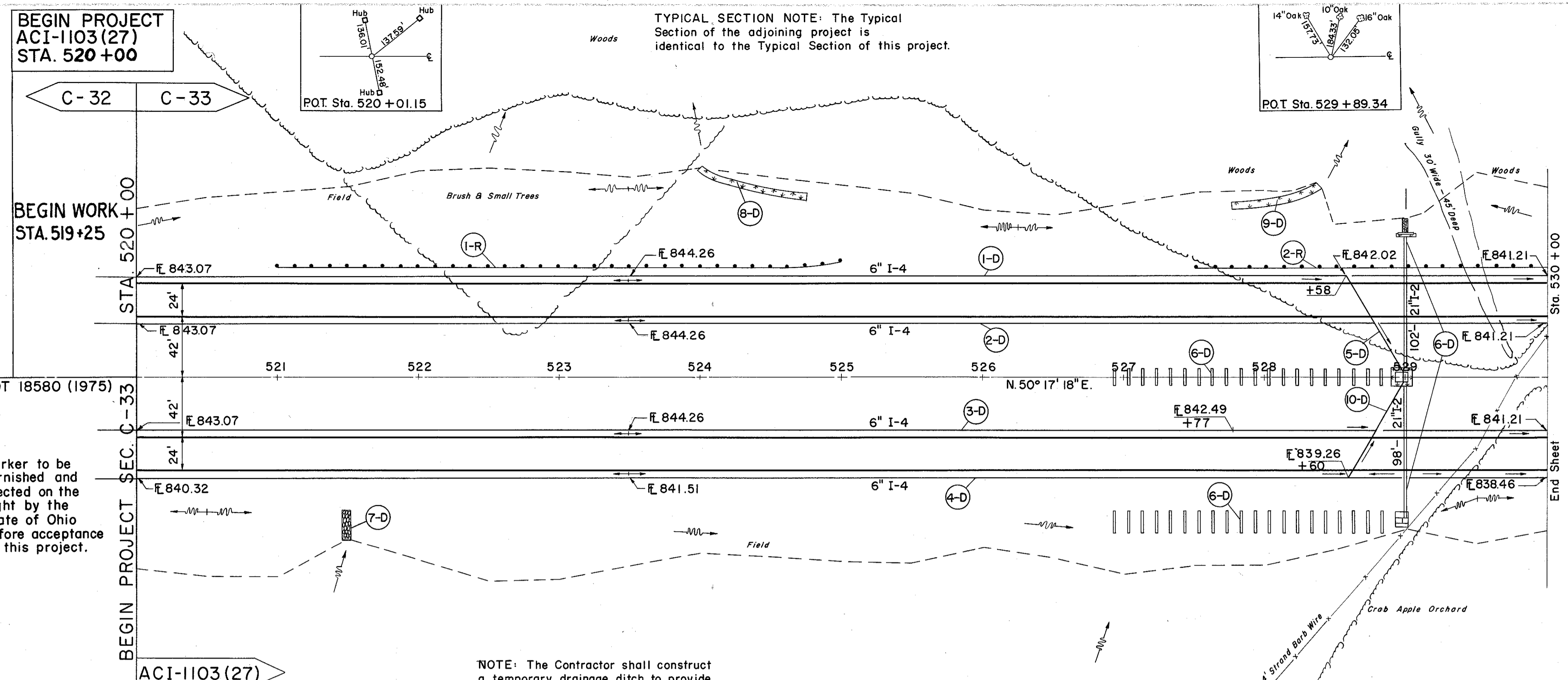

REF NO.	STATION	FROM	TO	DEPTH OF SODDING	SLOPES	WIDTH OF SODDING	LENGTH	S. Y.
I-1	519+70	530+00	7' LT	0.3	4:1	4.5	75	37.5
I-2	519+70	530+00	8' RT	0.3	4:1	4.5	75	37.5
I-3	519+70	530+00	9' RT	0.3	4:1	4.5	75	37.5
I-4	519+70	530+00	10' RT	0.3	4:1	4.5	75	37.5
I-5	519+70	530+00	11' RT	0.3	4:1	4.5	75	37.5
I-6	519+70	530+00	12' RT	0.3	4:1	4.5	75	37.5
I-7	519+70	530+00	13' RT	0.3	4:1	4.5	75	37.5
I-8	519+70	530+00	14' RT	0.3	4:1	4.5	75	37.5
I-9	519+70	530+00	15' RT	0.3	4:1	4.5	75	37.5
I-10	519+70	530+00	16' RT	0.3	4:1	4.5	75	37.5
I-11	519+70	530+00	17' RT	0.3	4:1	4.5	75	37.5
I-12	519+70	530+00	18' RT	0.3	4:1	4.5	75	37.5
I-13	519+70	530+00	19' RT	0.3	4:1	4.5	75	37.5
I-14	519+70	530+00	20' RT	0.3	4:1	4.5	75	37.5
I-15	519+70	530+00	21' RT	0.3	4:1	4.5	75	37.5
I-16	519+70	530+00	22' RT	0.3	4:1	4.5	75	37.5
I-17	519+70	530+00	23' RT	0.3	4:1	4.5	75	37.5
I-18	519+70	530+00	24' RT	0.3	4:1	4.5	75	37.5
I-19	519+70	530+00	25' RT	0.3	4:1	4.5	75	37.5
I-20	519+70	530+00	26' RT	0.3	4:1	4.5	75	37.5
I-21	519+70	530+00	27' RT	0.3	4:1	4.5	75	37.5
I-22	519+70	530+00	28' RT	0.3	4:1	4.5	75	37.5
I-23	519+70	530+00	29' RT	0.3	4:1	4.5	75	37.5
I-24	519+70	530+00	30' RT	0.3	4:1	4.5	75	37.5
I-25	519+70	530+00	31' RT	0.3	4:1	4.5	75	37.5
I-26	519+70	530+00	32' RT	0.3	4:1	4.5	75	37.5
I-27	519+70	530+00	33' RT	0.3	4:1	4.5	75	37.5
I-28	519+70	530+00	34' RT	0.3	4:1	4.5	75	37.5
I-29	519+70	530+00	35' RT	0.3	4:1	4.5	75	37.5
I-30	519+70	530+00	36' RT	0.3	4:1	4.5	75	37.5
I-31	519+70	530+00	37' RT	0.3	4:1	4.5	75	37.5
I-32	519+70	530+00	38' RT	0.3	4:1	4.5	75	37.5
I-33	519+70	530+00	39' RT	0.3	4:1	4.5	75	37.5
I-34	519+70	530+00	40' RT	0.3	4:1	4.5	75	37.5
I-35	519+70	530+00	41' RT	0.3	4:1	4.5	75	37.5
I-36	519+70	530+00	42' RT	0.3	4:1	4.5	75	37.5
I-37	519+70	530+00	43' RT	0.3	4:1	4.5	75	37.5
I-38	519+70	530+00	44' RT	0.3	4:1	4.5	75	37.5
I-39	519+70	530+00	45' RT	0.3	4:1	4.5	75	37.5
I-40	519+70	530+00	46' RT	0.3	4:1	4.5	75	37.5
I-41	519+70	530+00	47' RT	0.3	4:1	4.5	75	37.5
I-42	519+70	530+00	48' RT	0.3	4:1	4.5	75	37.5
I-43	519+70	530+00	49' RT	0.3	4:1	4.5	75	37.5
I-44	519+70	530+00	50' RT	0.3	4:1	4.5	75	37.5
I-45	519+70	530+00	51' RT	0.3	4:1	4.5	75	37.5
I-46	519+70	530+00	52' RT	0.3	4:1	4.5	75	37.5
I-47	519+70	530+00	53' RT	0.3	4:1	4.5	75	37.5
I-48	519+70	530+00	54' RT	0.3	4:1	4.5	75	37.5
I-49	519+70	530+00	55' RT	0.3	4:1	4.5	75	37.5
I-50	519+70	530+00	56' RT	0.3	4:1	4.5	75	37.5
I-51	519+70	530+00	57' RT	0.3	4:1	4.5	75	37.5
I-52	519+70	530+00	58' RT	0.3	4:1	4.5	75	37.5
I-53	519+70	530+00	59' RT	0.3	4:1	4.5	75	37.5
I-54	519+70	530+00	60' RT	0.3	4:1	4.5	75	37.5
I-55	519+70	530+00	61' RT	0.3	4:1	4.5	75	37.5
I-56	519+70	530+00	62' RT	0.3	4:1	4.5	75	37.5
I-57	519+70	530+00	63' RT	0.3	4:1	4.5	75	37.5
I-58	519+70	530+00	64' RT	0.3	4:1	4.5	75	37.5
I-59	519+70	530+00	65' RT	0.3	4:1	4.5	75	37.5
I-60	519+70	530+00	66' RT	0.3	4:1	4.5	75	37.5
I-61	519+70	530+00	67' RT	0.3	4:1	4.5	75	37.5
I-62	519+70	530+00	68' RT	0.3	4:1	4.5	75	37.5
I-63	519+70	530+00	69' RT	0.3	4:1	4.5	75	37.5
I-64	519+70	530+00	70' RT	0.3	4:1	4.5	75	37.5
I-65	519+70	530+00	71' RT	0.3	4:1	4.5	75	37.5
I-66	519+70	530+00	72' RT	0.3	4:1	4.5	75	37.5
I-67	519+70	530+00	73' RT	0.3	4:1	4.5	75	37.5
I-68	519+70	530+00	74' RT	0.3	4:1	4.5	75	37.5
I-69	519+70	530+00	75' RT	0.3	4:1	4.5	75	37.5
I-70	519+70	530+00	76' RT	0.3	4:1	4.5	75	37.5
I-71	519+70	530+00	77' RT	0.3	4:1	4.5	75	37.5
I-72	519+70	530+00	78' RT	0.3	4:1	4.5	75	37.5
I-73	519+70	530+00	79' RT	0.3	4:1	4.5	75	37.5
I-74	519+70	530+00	80' RT	0.3	4:1	4.5	75	37.5
I-75	519+70	530+00	81' RT	0.3	4:1	4.5	75	37.5
I-76	519+70	530+00	82' RT	0.3	4:1	4.5	75	37.5
I-77	519+70	530+00	83' RT	0.3	4:1	4.5	75	37.5
I-78	519+70	530+00	84' RT	0.3	4:1	4.5	75	37.5
I-79	519+70	530+00	85' RT	0.3	4:1	4.5	75	37.5
I-80	519+70	530+00	86' RT	0.3	4:1	4.5	75	37.5
I-81	519+70	530+00	87' RT	0.3	4:1	4.5	75	37.5
I-82	519+70	530+00	88' RT	0.3	4:1	4.5	75	37.5
I-83	519+70	530+00	89' RT	0.3	4:1	4.5	75	37.5
I-84	519+70	530+00	90' RT	0.3	4:1	4.5	75	37.5
I-85	519+70	530+00	91' RT	0.3	4:1	4.5	75	37.5
I-86	519+70	530+00	92' RT	0.3	4:1	4.5	75	37.5
I-87	519+70	530+00	93' RT	0.3	4:1	4.5	75	37.5
I-88	519+70	530+00	94' RT	0.3	4:1	4.5	75	37.5
I-89	519+70	530+00	95' RT	0.3	4:1	4.5	75	37.5
I-90	519+70	530+00	96' RT	0.3	4:1	4.5	75	37.5
I-91	519+70	530+00	97' RT	0.3	4:1	4.5	75	37.5
I-92	519+70	530+00	98' RT	0.3	4:1	4.5	75	37.5
I-93	519+70	530+00	99' RT	0.3	4:1	4.5	75	37.5
I-94	519+70	530+00	100' RT	0.3	4:1	4.5	75	37.5

REF NO.	STATION	FROM	TO	DEPTH OF SODDING	SLOPES	WIDTH OF SODDING	LENGTH	S. Y.
I-1	524+00	524+00	524+00	0.3	4:1	4.5	75	37.5
I-2	524+00	524+00	524+00	0.3	4:1	4.5	75	37.5
I-3	524+00	524+00	524+00	0.3	4:1	4.5	75	37.5
I-4	524+00	524+00	524+00	0.3	4:1	4.5	75	37.5
I-5	524+00	524+00	524+00	0.3	4:1	4.5	75	37.5
I-6	524+00	524+00	524+00	0.3	4:1	4.5	75	37.5
I-7	524+00	524+00	524+00	0.3	4:1	4.5	75	37.5
I-8	524+00	524+00	524+00	0.3	4:1	4.5	75	37.5
I-9	524+00	524+00	524+00	0.3	4:1	4.5	75	37.5
I-10	524+00	524+00	524+00	0.3	4:1	4.5	75	37.5
I-11	524+00	524+00	524+00	0.3	4:1	4.5	75	37.5
I-12	524+00	524+00	524+00	0.3	4:1	4.5	75	37.5
I-13	524+00	524+00	524+00	0.3	4:1	4.5	75	37.5
I-14	524+00	524+00	524+00	0.3	4:1	4.5	75	37.5
I-15	524+00	524+00	524+00	0.3	4:1	4.5	75	37.5
I-16	524+00	524+00	524+00	0.3	4:1	4.5	75	37.5
I-17	524+00	524+00	524+00	0.3	4:1	4.5	75	37.5
I-18	524+00	524+00	524+00	0.3	4:1	4.5	75	37.5
I-19	524+00	524+00	524+00	0.3	4:1	4.5	75	37.5
I-20	524+00	524+00	524+00	0.3	4:1	4.5	75	37.5
I-21	524+00	524+00	524+00	0.3	4:1	4.5	75	37.5
I-22	524+00	524+00	524+00	0.3	4:1	4.5	75	37.5
I-23	524+00	524+00	524+00	0.3	4:1	4.5	75	37.5
I-24	524+00	524+00	524+00	0.3	4:1	4.5	75	37.5
I-25	524+00	524+00	524+00	0.3	4:1	4.5	75	37.5
I-26	524+00	524+00	524+00	0.3	4:1	4.5	75	37.5
I-27	524+00	524+0						