

LAKE COUNTY
LAK - 90 - 13.00

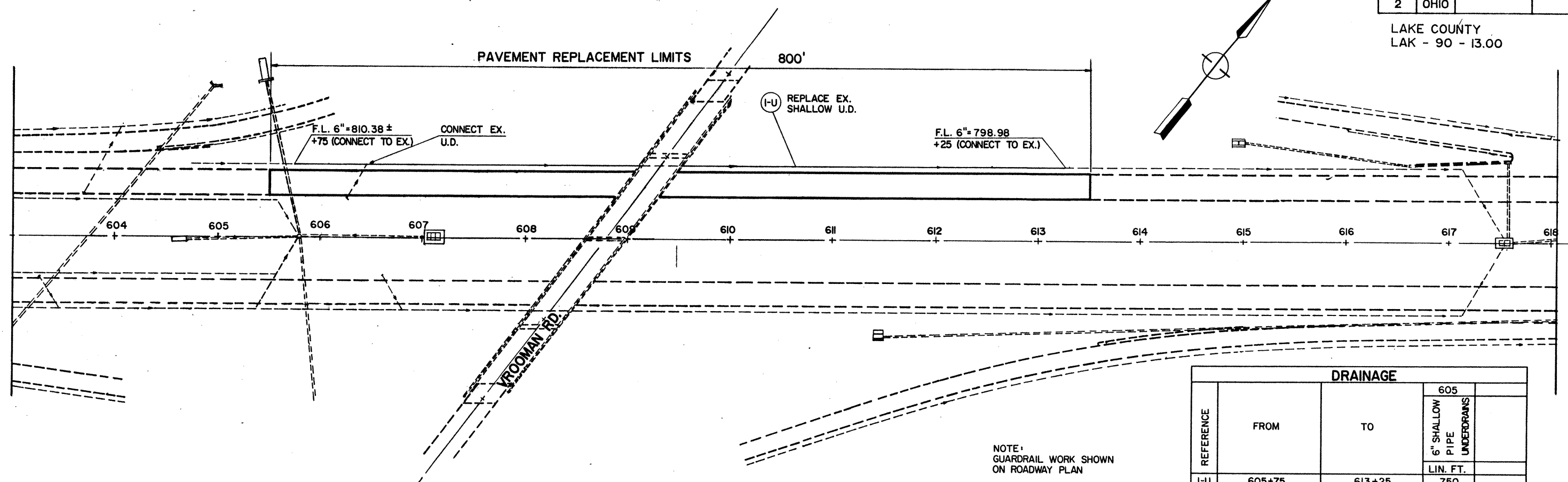

DRAINAGE			
REFERENCE	FROM	TO	605 6" SHALLOW PIPE UNDERDRAINS LIN. FT.
I-U	605+75	613+25	750
TOTALS			750

NOTE: GUARDRAIL WORK SHOWN ON ROADWAY PLAN

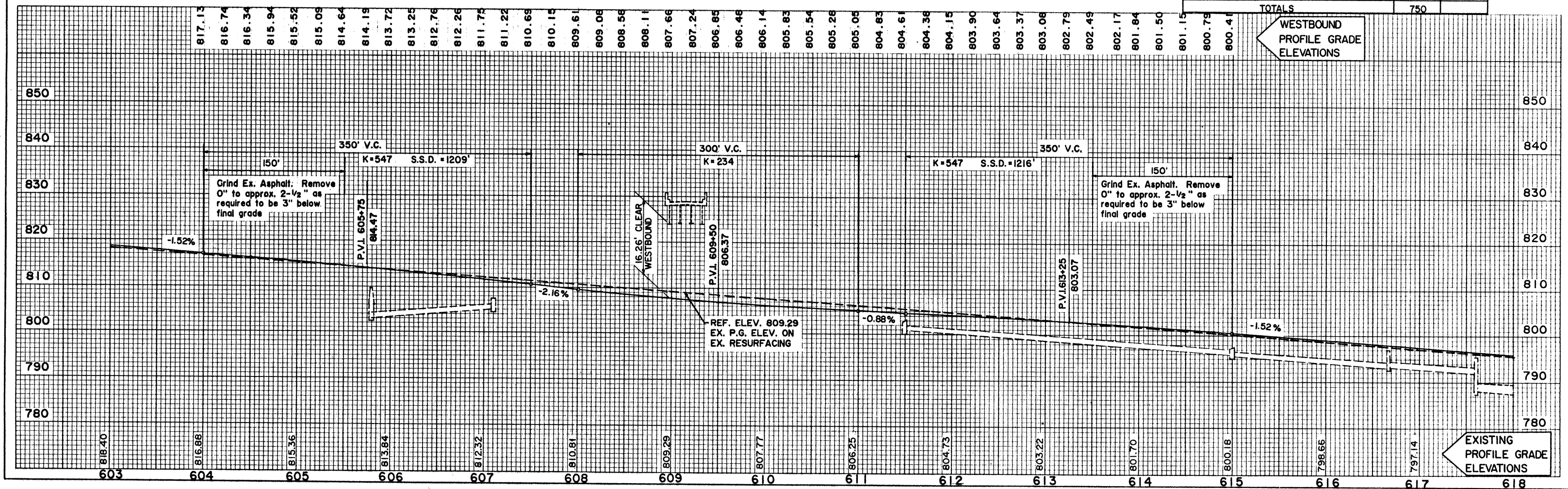

PAVEMENT LOWERING WESTBOUND, STA. 603+00 TO STA. 618+00