

LAKE COUNTY
SEC. LAK-1-12.89

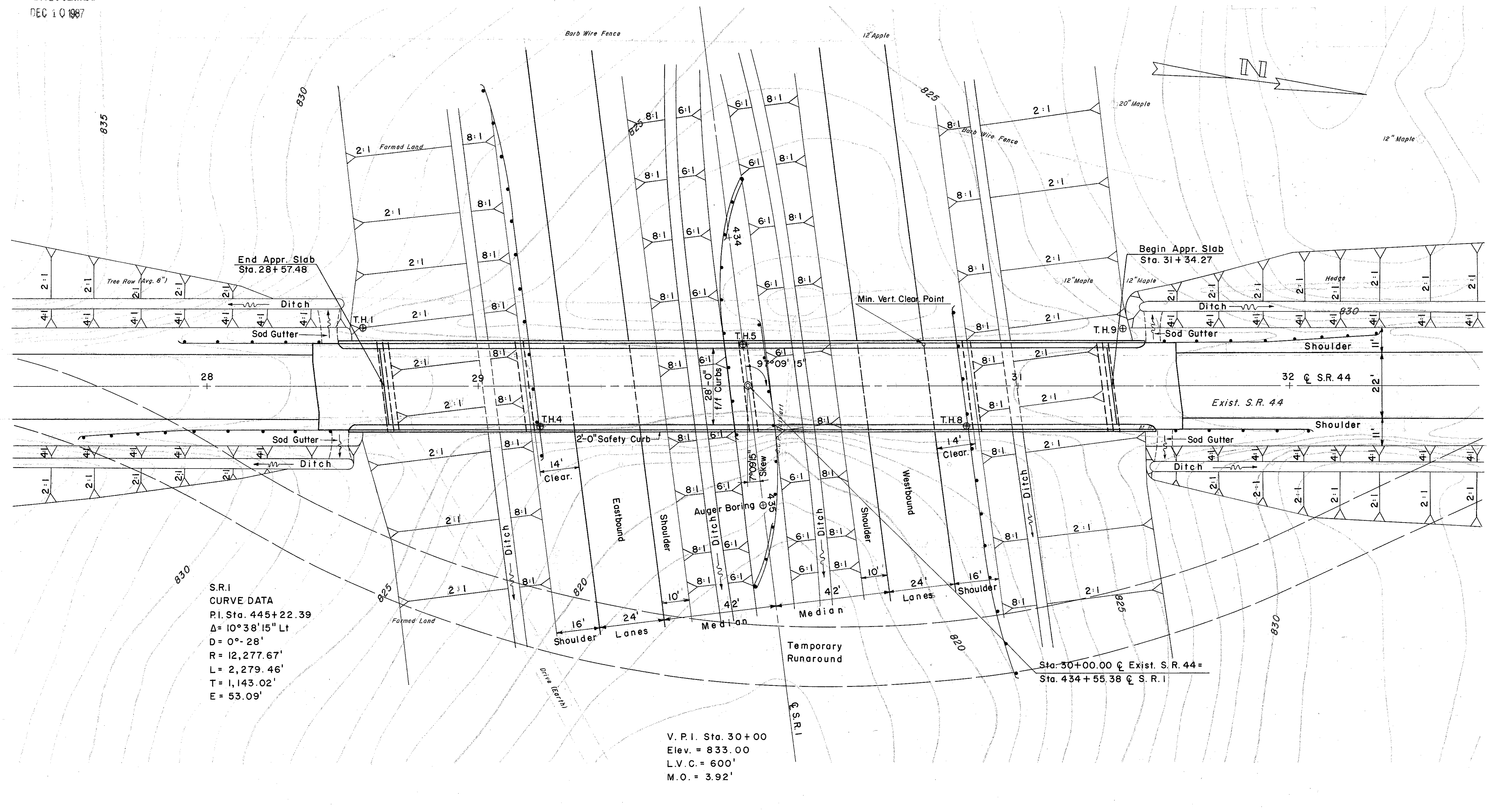

S.R.1
CURVE DATA
P.I. Sta. 445+22.39
 $\Delta = 10^{\circ}38'15''$ Lt
 $D = 0^{\circ}-28'$
 $R = 12,277.67'$
 $L = 2,279.46'$
 $T = 1,143.02'$
 $E = 53.09'$

V. P. I. Sta. 30+00
Elev. = 833.00
L.V.C. = 600'
M.O. = 3.92'

FOUNDATION SOUNDINGS: Foundation design and foundation quantities are based on a study of rod soundings and soil-sampling soundings made at the site. This sounding information may be inspected in the office of Interstate Projects in Columbus or in the Division office, but the State does not guarantee the accuracy thereof.

B.M. #46 Lag Bolt 2' from ground on 36" dead Oak 400'± Lt. of C Sta. 421+00 Elev. 842.37'
B.M. #47 Lag Bolt in Power Pole 12" from ground C.E.I. 560170, 150'± Rt. of C Sta. 433+50 along West side S.R.44, Elev. 829.48

PROPOSED STRUCTURE
TYPE: Continuous Steel Beam with Reinforced Concrete Deck & Substructure.
SPAN: 57'-9", 82'-6", 82'-6", 49'-6" c/c Bearing
ROADWAY: 28'-0" f/f 2'-0" Safety Curbs
LOAD FREQUENCY: C.F. = 400
SKEW: 7°09'15" R.F.
WEARING SURFACE: 1" Monolithic Concrete
APPROACH SLAB: Special (25' Long)
ALIGNMENT: Tangent
TRAFFIC COUNT: 5370 (1956)

BORING DATA
T.H.1 & T.H.9 - Core Boring & Rod Soundings.
T.H.4, T.H.5 & T.H.8 - Rod Soundings only

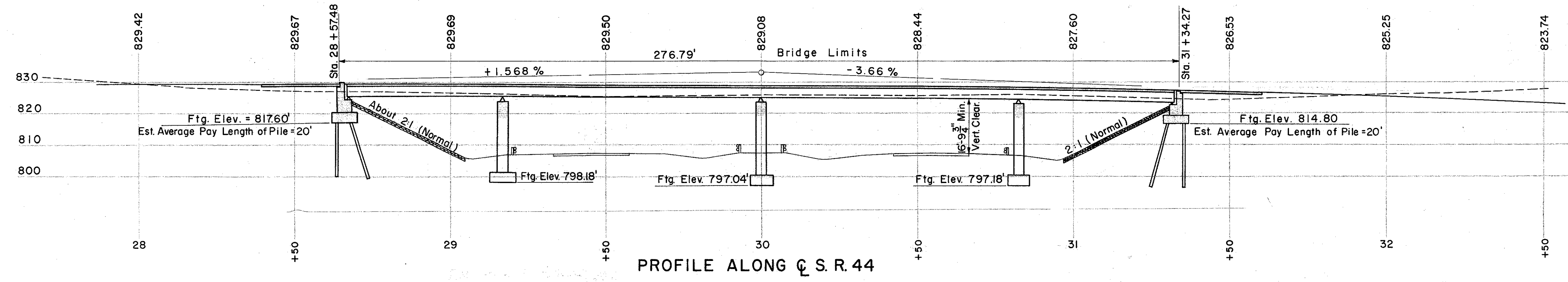

SEC. C-32 FED. AID PROJ. NO. ACI-1103 (21)

PREPARED BY
CAPITOL ENGINEERING ASSOCIATES, DILLSBURG, PA.
FOR
STATE OF OHIO
DEPARTMENT OF HIGHWAYS

SITE PLAN
BRIDGE NO. LAK-1-1493
S.R.1 UNDER EXIST. S.R.44
LAKE COUNTY
STA. 434+55.38

DESIGNED	DRAWN	TRACED	CHECKED	REVISED	DATE	REVISED