

LAKE COUNTY
SEC. LAK-I-12.89

Ramp B Curve Data
 P.I. Sta. 10+05.37
 $\Delta = 7^{\circ}00'00''$ Lt.
 $D = 1^{\circ}30'00''$
 $R = 3819.72$
 $L = 466.67$
 $T = 233.62$

MICROFILMED
DEC 10 1987

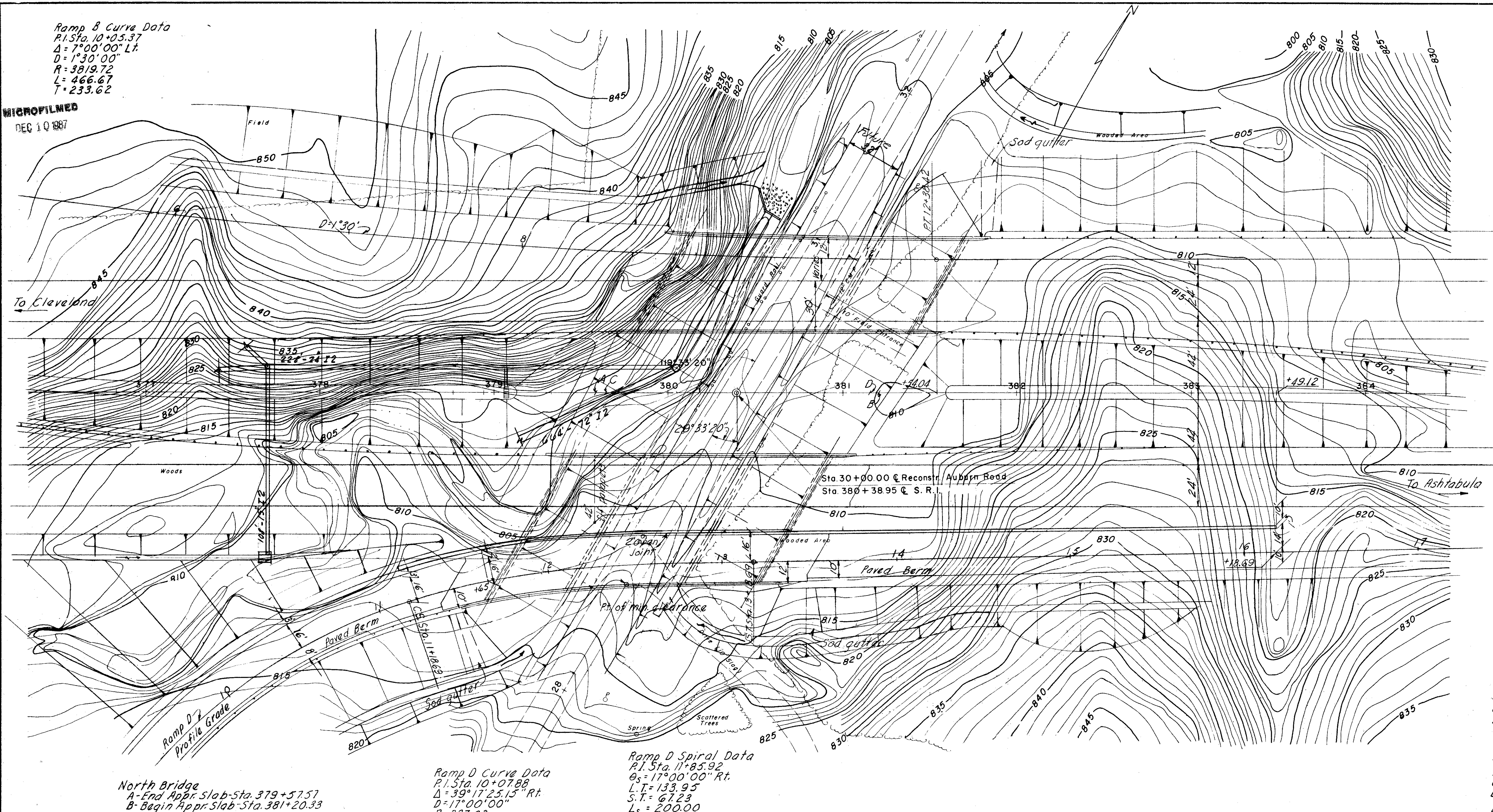

NOTE:
all grading shall be in accordance with the grading plan.

PROPOSED STRUCTURE
 Type: Continuous steel beam with reink concrete deck & substructure.
 Spans: North Bridge 47.2', 63.3', 47.2'; South Bridge 42.0', 63.3', 42.0'.
 Roadway: as shown
 Load Frequency: CF 2000-oddadequate for A.A.S.H.O. alternate loading
 Skew: 29°33'20" L.F.
 Wearing Surface: 1" Monolithic Concrete
 Approach Slab: 25' long AS-1-54 and as per sheet # 439
 Alignment: tangent

FOUNDATION SOUNDINGS: Foundation design and foundation quantities are based on a study of borings and soil-sampling soundings made at the site. This sounding information may be inspected in the Interstate Projects office and in the Division office, but the State does not guarantee the accuracy thereof.

BENCH MARKS:
 Lag bolt in base of 30" Oak 136'± Rt. of Sta. 379+12 along Auburn Road. Elevation 814.27 B.M.#42
 Lag bolt in base of 24" Beech 125'± Rt. of Sta. 388+00. Elevation 813.73 B.M.#43

North Bridge
 A-End Appr. Slab-Sta. 379+57.57
 B-Begin Appr. Slab-Sta. 381+20.33
 South Bridge
 C-End Appr. Slab-Sta. 379+62.75
 D-Begin Appr. Slab-Sta. 381+15.16

Ramp D Curve Data
 P.I. Sta. 10+07.88
 $\Delta = 39^{\circ}17'25.15''$ Rt.
 $D = 17^{\circ}00'00''$
 $R = 337.03$
 $L = 231.12$
 $T = 120.31$
 Super 1" per ft.

Ramp D Spiral Data
 P.I. Sta. 11+85.92
 $\theta_s = 17^{\circ}00'00''$ Rt.
 $L.T. = 133.95$
 $S.T. = 67.23$
 $L_s = 200.00$

North Bridge Length 162.76
 South Bridge Length 152.41

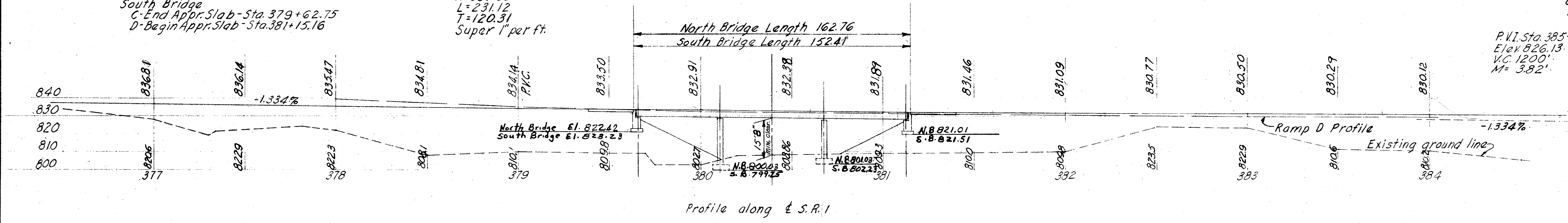

P.V.I. Sta. 385+00.
 Elev. 826.13
 V.C. 1200'
 M = 3.82'

SEC. C-32 FED. AID PROJ. NO. ACI-1103 (21)

PREPARED BY
CAPITOL ENGINEERING ASSOCIATES, DILLSBURG, PA.
FOR

STATE OF OHIO
DEPARTMENT OF HIGHWAYS

SITE PLAN
BRIDGE NO. LAK-I-1389
S.R.1 OVER AUBURN ROAD
LAKE COUNTY
STA. 380+38.95

DESIGNED	DRAWN	TRACED	CHECKED	REVISED	DATE	REVISED
	McC.		P.P.			