

LAKE COUNTY
LAK-I-12.89

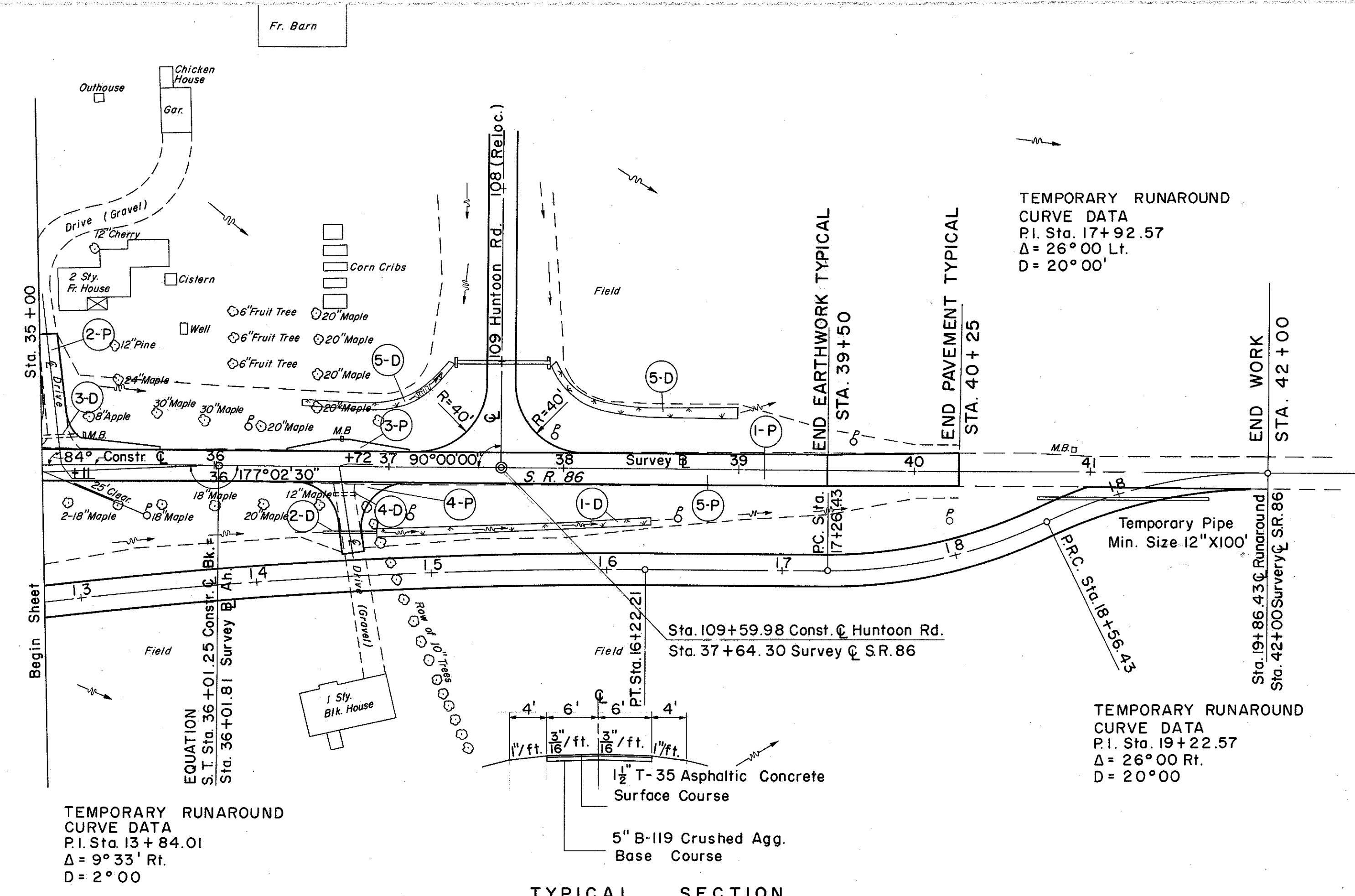

TYPICAL SECTION
DRIVE LT. STA. 35+11 & DRIVE RT. STA. 36+72

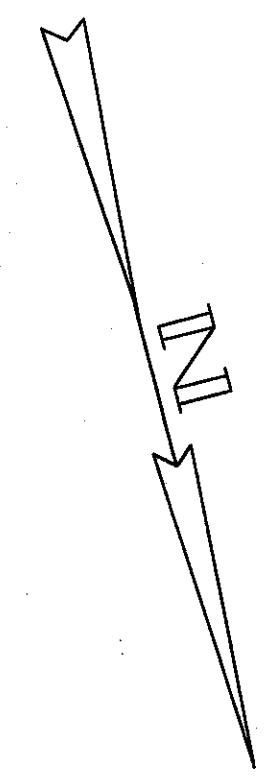
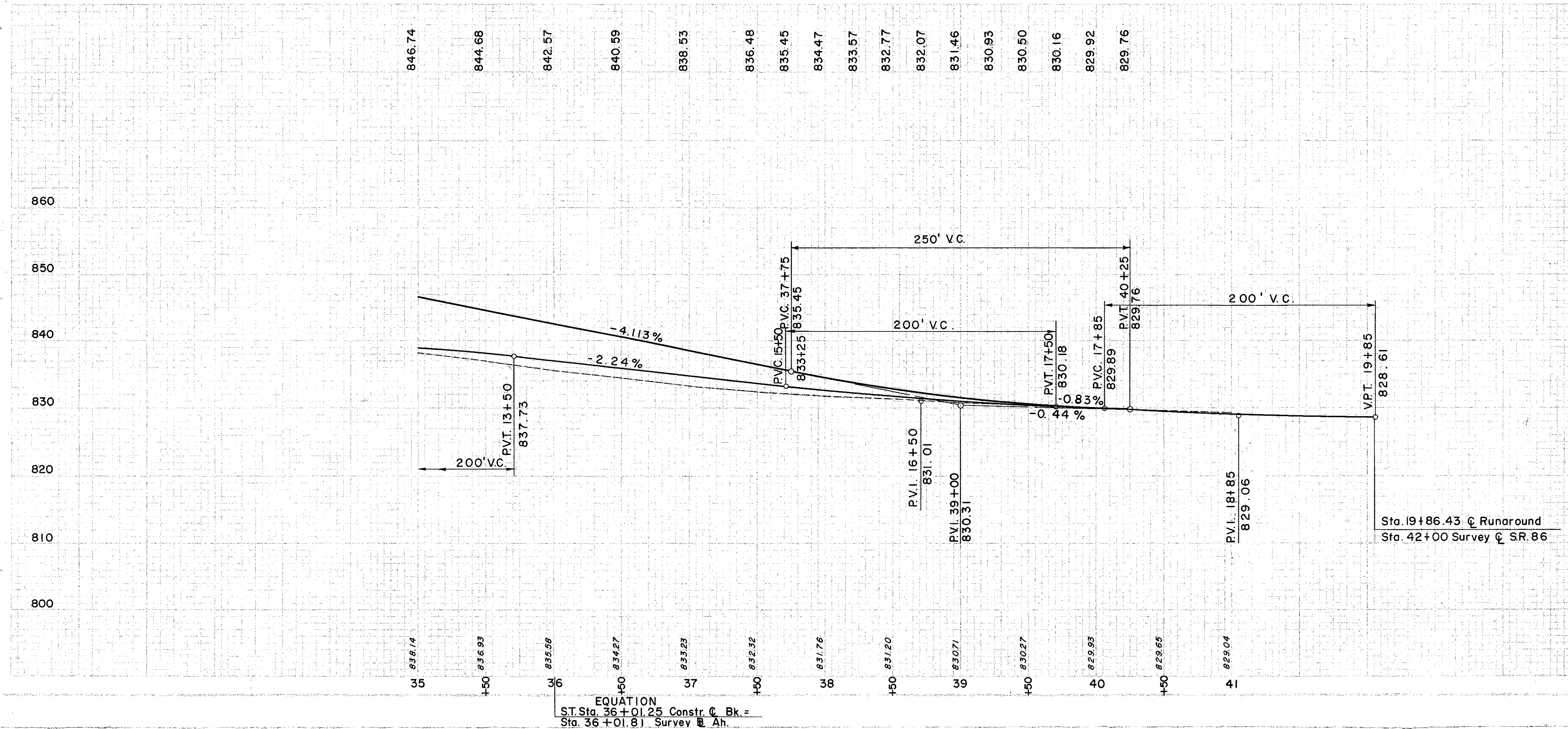

(P) PAVEMENT

REF. SIDE	STATION	T-35 ASPH. CONCRETE SURFACE COURSE		I-22 6\"/>								
		FROM	TO	C. Y.	GAL.	FROM	TO	C. Y.	L. F.	I-9 STONE UNDERDRAIN	I-10 SODDING	I-11 12\"/>
I-P	35+00	40+25	35	35	194	368	261	261	261	261	261	E-8 REMOVAL & DISPOSAL
2-P	35+11	37+10	81	43	194	43	261	261	261	261	261	E-101 COMPACT SUBGR.
3-P	36+40	37+10	81	43	194	43	261	261	261	261	261	E-101 COMPACT SUBGR.
4-P	36+72	40+25	35	35	194	368	261	261	261	261	261	E-101 COMPACT SUBGR.
5-P	37+85	40+25	35	35	194	368	261	261	261	261	261	E-101 COMPACT SUBGR.
TOTALS			35	35	194	462	261	261	261	261	261	507

(D) DRAINAGE

REF. SIDE	STATION	SODDING		SUBTOTAL
		FROM	TO	
I-D	36+93	36+93	38+50	67
2-D	36+62	36+62	36+92	30
3-D	34+96	34+96	35+20	24
4-D	36+68	36+68	36+82	14
5-D	36+50	36+50	39+00	91
SUBTOTAL				222

Excavation	=	222 C. Y.
Embankment	=	3248 C. Y.
Embankment 17.5'	=	3816 C. Y.